

INDEX OF SHEETS

SHEET NO.	TITLE PAGE
1	TITLE PAGE
2	TYPICAL CROSS-SECTION OF IMPROVEMENT DOUBLE TACK COAT OF REFINED TAR WITH PEA STONE SEAL (CLASS A) MODIFIED, ITEM 312-A
3	BANKING AND WIDENING TABLES
4	QUANTITY SHEET (ITEMS)
5-6	QUANTITY SHEET (DRAINAGE)
7-11	EARTHWORK SHEETS - ROADWAY
12-31	PLAN AND PROFILE SHEETS
32	PRELIMINARY INFORMATION SHEET (BRIDGE 10+910-17+60.0)
33	DETAILS OF ABUTMENT NO 1
34	DETAILS OF ABUTMENT NO 2
35	REINFORCING STEEL SCHEDULE
36	EARTHWORK SHEET (BRIDGE)
37	PRELIMINARY INFORMATION SHEET (BRIDGE 99+72.0-100+41.0)
38	DETAILS OF ABUTMENTS NOS. 1 AND 2
39	REINFORCING STEEL SCHEDULE
40	STANDARD STRUCTURE SHEET SB 5-1 (DETAILS OF BRIDGE RAILING)
41	STANDARD STRUCTURE SHEET SB 1-1 (BARRICADES, SIGNS & LIGHTS) BRIDGES
42	STANDARD STRUCTURE SHEET SB 2-0 (DETAILS C, H, S, K AND L)
43	STANDARD STRUCTURE SHEET SB 3-0 (H-20)-1 (DETAILS OF SUPERSTRUCTURE)
44	STANDARD STRUCTURE SHEET S-40 (BARRICADES, SIGNS & LIGHTS) ROADWAY
45	STANDARD STRUCTURE SHEET S-48-46 (THREE CABLE GUARD RAIL)
46	STANDARD STRUCTURE SHEET S-53-49 (R.C.P. DROP INLETS)
47	CONSTRUCTION DETAILS CD (DRAINAGE AND MARKERS)
48	CONSTRUCTION DETAILS CD-4 (DITCHES)
49	CONSTRUCTION DETAILS CD-2 (TYPICAL GRADING)
50-127	CROSS-SECTIONS
128-131	CHANNEL SECTIONS

STATE OF VERMONT  
DEPARTMENT OF HIGHWAYS  
PROPOSED IMPROVEMENT

TOWNS OF JAMAICA-LONDONDERRY

COUNTY OF WINDHAM  
VERMONT ROUTE 8  
RAWSONVILLE-LONDONDERRY ROAD

BEGINNING AT THE INTERSECTION OF VERMONT ROUTES 30 AND 8  
AND EXTENDING NORTHERLY 20,555.3 FEET, EXCLUDING BRIDGE 3+163-4+02.0

LENGTH OF ROADWAY 20,417.3 FEET = 3.667 MILES  
LENGTH OF BRIDGES 138.0 FEET = 0.025 MILE

LENGTH OF PROJECT 20,555.3 FEET = 3.693 MILES

STANDARD STRUCTURE SHEET APPROVED BY THE CHIEF  
ENGINEER, VERMONT STATE DEPARTMENT OF HIGHWAYS.

PROJECT NO.	STATE	PROJECT DISTRICT	SHEET NO.
5 7310	VT	1	131

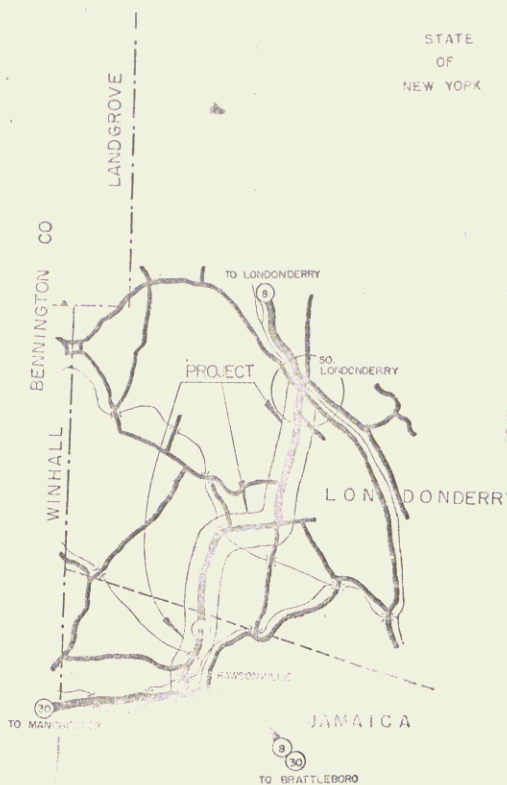
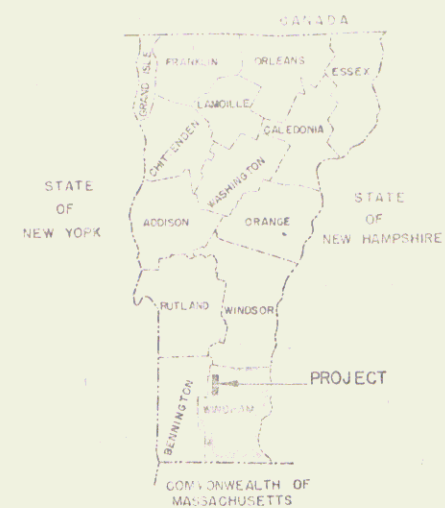

Jamaica 56

PROJECT: JAMAICA-LONDONDERRY  
DISTRICT: 5 7310  
TYP. BRIDGE: W. Horse, Const. of Lumber Co.  
LOCATION: Beginning at intersection of route 8 and 10, extending northerly on Rte. 8, 20,555.3 ft.

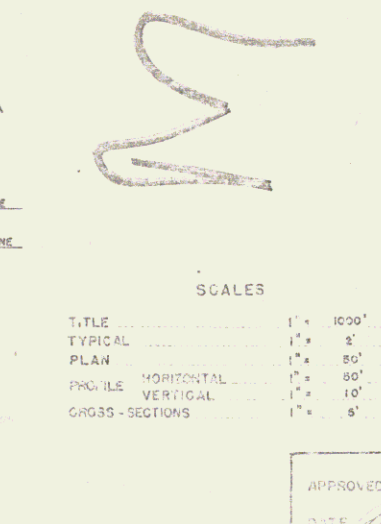
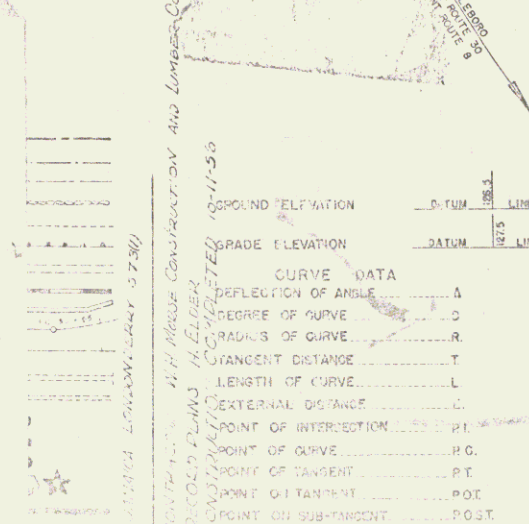
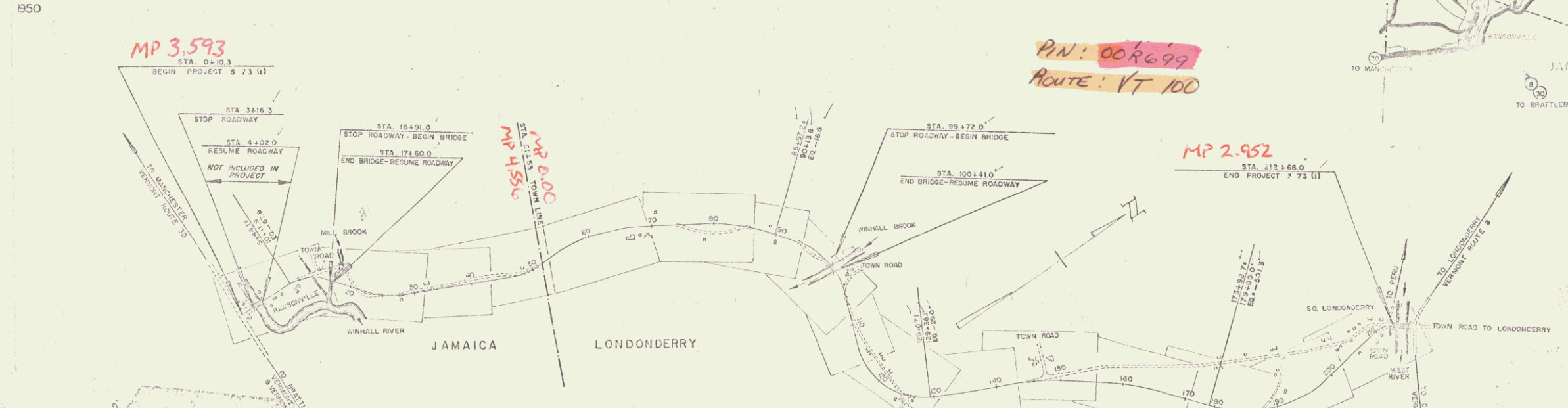

JAMAICA - LONDONDERRY	5 7310	TYPE	PAVEMENT AREA
		DBL TACK COAT OF PEA TAR, MODIFIED	52,310 SQ.
RECORD PLANS MATERIALS			
SUB-BASE OF GRAVEL	Winnell Brook, Londonderry	REINFORCING STEEL - VI Structural Steel Co.	
CRUSHED GRAVEL	Winnell Brook, Londonderry	STRUCTURAL STEEL - VI Structural Steel Co.	
REFINED TAR	Winnell Brook, Londonderry	R.C.P. - VI Concrete Pipe Co. - Windsor	
PEASTONE FOR SEAL	Winnell Brook, Londonderry	ACCOMP - I.E. Metal Culvert Co. Primer, Ma.	
CEMENT	Londonderry	STEEL CURVED RAIL - Cass Wagon Co. of Vt.	
CABLE FOR GUARD RAIL	Jamaica, Londonderry	GUARD RAIL PAINT - Cass Wagon Co. of Vt.	
CONTRACTOR - W. Horse Const. of Lumber Co. RESIDENT ENGRS - Austin Eng. - Londonderry INSPECTORS - Wisner, Dunbar RECORD PLANS - E. H. C. - Londonderry			
CONTRACT DATED May 11, 1955 CONTRACT STARTED May 16, 1955 CONTRACT COMPLETED Oct 1, 1956 CONTRACT ACCEPTED Oct 11, 1956			

APPROVED: [Signatures] DATE: [Dates]

RIGHT-OF-WAY DIVISION  
TOWN FILE  
PERPETUAL  
Rte. 8  
Town of VT 100  
(To Be Returned To R.O.W. Division)

DEPARTMENT OF COMMERCE  
BUREAU OF PUBLIC ROADS  
APPROVED: [Signatures]  
DISTRICT ENGINEER  
PROJECT: S. NO. 73 (1)  
SHEET: 131 OF 131 SHEETS

STEARNS R. JENKINS - VT 100 1