

POOR ORIGINAL COPY

TOWN OF DOVER
COUNTY OF WINDHAM
VERMONT ROUTE 100
WILMINGTON-JAMAICA ROAD

BEGINNING AT THE WILMINGTON-DOVER TOWN LINE AND
EXTENDING NORTHERLY ON S.A. ROUTES #3 AND #5
TO THE INTERSECTION WITH S.A. ROUTE #2.

LENGTH OF PROJECT 14,674.7 FEET = 2.779 MILES

MP 0.00 - 2.959

PROJECT: 1964 Resurvey
DATE: 10/20/1964
PIN: DOR 690

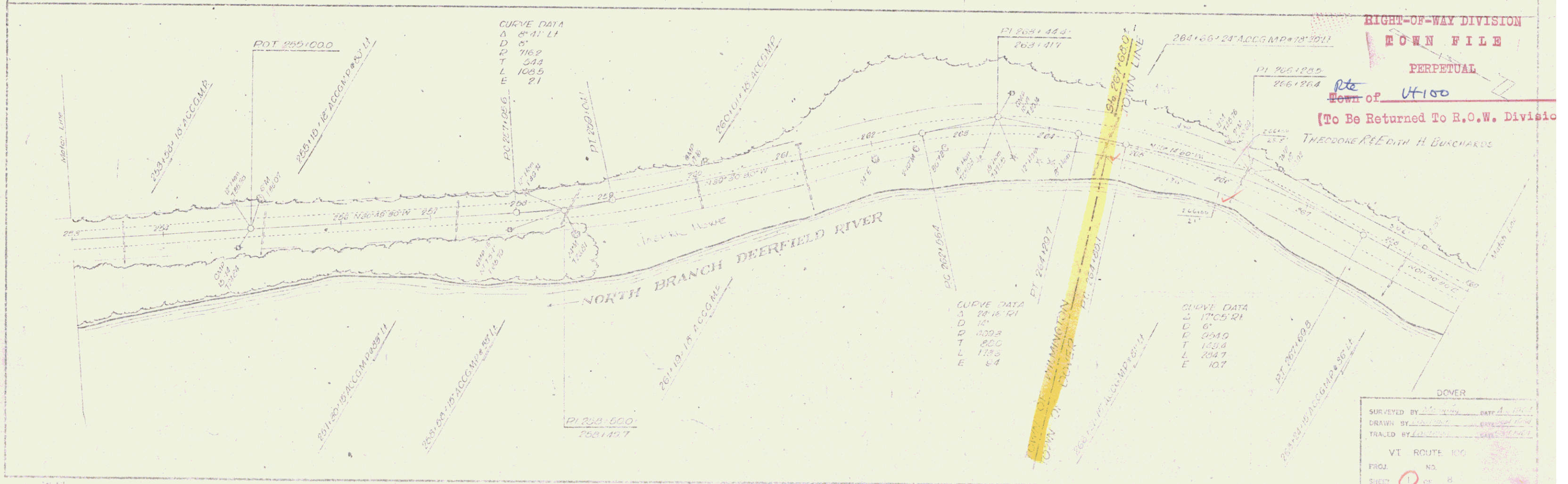
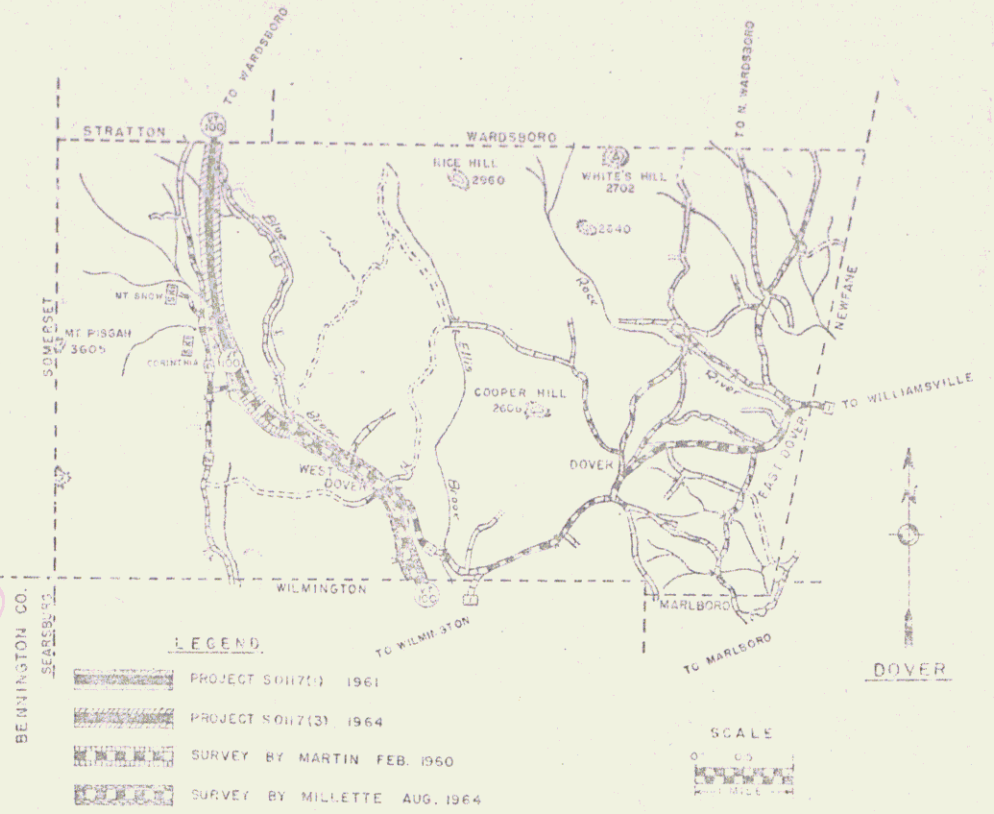

CURVE DATA
Δ 87°41' L1
D 8'
P 716.2
T 542
L 108.5
E 21

CURVE DATA
Δ 10°18' R1
D 14'
P 432.8
T 800
L 178.5
E 8.4

CURVE DATA
Δ 17°05' R1
D 6'
P 554.0
T 153.4
L 294.7
E 10.7

RIGHT-OF-WAY DIVISION
TOWN FILE
PERPETUAL
Town of VT 100
(To Be Returned To R.O.W. Division)

DOVER
SURVEYED BY [Signature] DATE 10/20/64
DRAWN BY [Signature] DATE 10/20/64
TRALED BY [Signature] DATE 10/20/64
VT ROUTE 100
PROJ. NO. [Blank]
SHEET 1 OF 8

STEARNS R. JENKINS
VT 100