

INDEX OF SHEETS

SHEET NO. 1	TITLE PAGE
" 2	TYPICAL CROSS-SECTION OF IMPROVEMENT
" 3	SHOULDER AND WIDENING TABLE
" 4	PLAN AND PROFILE
" 21	STD. STRUCTURE SHEET (3-28) PIPE CULV.
" 24	" " (3-29) BOX CULV.
" 25	" " (3-30) GUARD RAIL
" 26	" " (5B-11) BARRICADE'S, SIGNS & LIGHTS
" 26A	STD. CULVERT SHEET (3C1)
" 27-27	CROSS-SECTIONS

STANDARD SHEETS 3-28 & 3-29 SUBMITTED TO THE CHIEF ENGINEER ON MAY 16, 1933.
STANDARD SHEET 3-30 SUBMITTED TO THE CHIEF ENGINEER ON AUG 15, 1933.

STATE OF VERMONT
STATE HIGHWAY DEPARTMENT

PLAN AND PROFILE OF PROPOSED
STATE HIGHWAY
NATIONAL RECOVERY HIGHWAYS

TOWN OF MORRISTOWN

WATERBURY-MORRISVILLE ROAD
FROM STOWE-MORRISTOWN TOWN LINE
NORTHEASTERLY TO THE MORRISVILLE
VILLAGE LIMITS.

LENG. OF PROJ. = 24,585.9 FT. = 4.656 MI.

FED. ROAD DIST. NO.	STATE	ROUTE NO.	SECTION NO.	SHEET NO.	TOTAL SHEETS
	VT.	88B	1	7	7

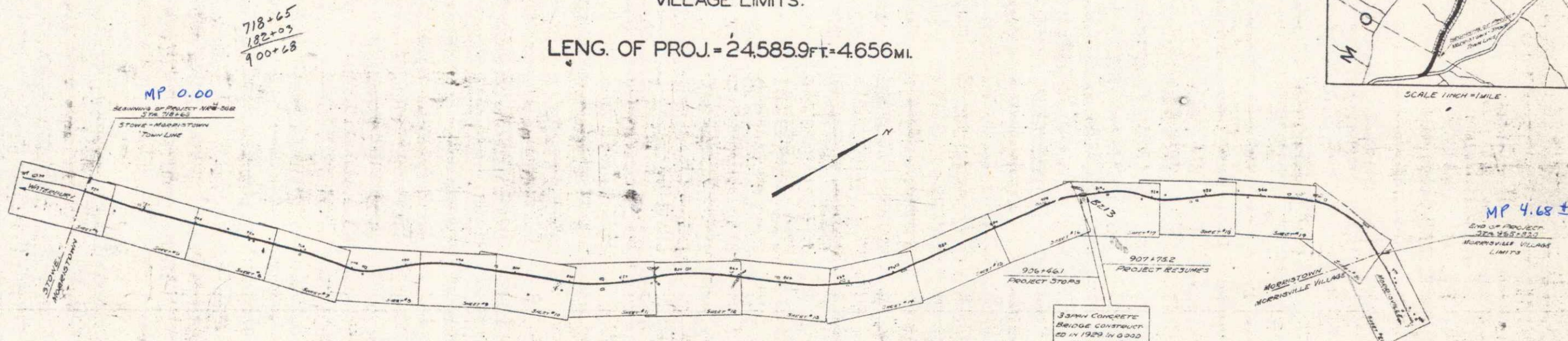

CONVENTIONAL SIGNS

COUNTY LINE	GROUND ELEVATION
TOWN LINE	FENCE LINE
STONE WALL	UNFENCED PROPERTY
GUARD RAIL	RAILROAD
TRAVELED WAY	RETAINING WALL
CENTER LINE	SURVEY LINE
CULVERT	DROP INLET
TROLLEY POLE	POWER POLE
TELEPHONE POLE	TREES
HEDGE	

CURVE DATA

DEFLECTION ANGLE	Δ
DEGREE OF CURVE	D
RADIUS OF CURVE	R
TANGENT DISTANCE	T
LENGTH OF CURVE	L
EXTERNAL DISTANCE	E
POINT OF INTERSECTION	P. I.
POINT OF CURVE	P. C.
POINT OF TANGENT	P. T.
POINT ON TANGENT	P. O. T.

TOWN: MORRISTOWN
ROUTE: VT 100
PROJECT: N.R.H. 88B
DATE: 09/11/1933
P.N. 008686

RIGHT-OF-WAY DIVISION
TOWN FILE
PERPETUAL
Town of VT. R.C. #100
(To Be Returned To R.O.W. Division)
THESE PLANS ARE SUBJECT TO SUCH REVISIONS AS MAY BE REQUIRED BY THE BUREAU OF PUBLIC ROADS OR THE COMMISSIONER OF HIGHWAYS. CONSTRUCTION IS TO BE CARRIED ON IN ACCORDANCE WITH THE STANDARD ROAD AND BRIDGE SPECIFICATIONS OF 1930 WITH ALL SUBSEQUENT APPROVED REVISIONS AND SUCH SPECIFICATIONS AND SPECIAL PROVISIONS AS ARE SUBMITTED WITH THE PLANS.

Project No. N.R.H. 88B

APPROVED: 3 OCT 16 1933
H. J. Farquhar
COMMISSIONER OF HIGHWAYS
SUBMITTED BY ORDER OF THE STATE HIGHWAY BOARD

RECOMMENDED: [Signature]
RECOMMENDED FOR APPROVAL: [Signature]
APPROVED: [Signature]
DIRECTOR, BUREAU OF PUBLIC ROADS

SERIES AND NO. FILED
SHEET 1 OF 77

DIST. #6 Plans
1