



INDEX OF SHEETS
 SHEET NO. 1 PLAN AND PROFILE
 " " 2 ABUTMENT DETAILS
 " " 3 TYPICAL DETAILS SERIES S.B.No.2

SUMMARY OF QUANTITIES

ITEM No. 15	STRUCTURE EXCAVATION	110 Cu.Yd.
ITEM No. 34 B	CONCRETE CLASS B (1-2 1/2-5)	82 Cu.Yds.
" "	REINFORCING STEEL	302 LBS.
" "	MAINTAINING TRAFFIC, SHOERING AND RAISING PRESENT STEEL SUPERSTRUCTURE	1-LUMP SUM 1000 Lm.Ft.
" "	TIMBER PLING	1-LUMP SUM
" "	REPAIRING PRESENT STEEL SUPERSTRUCTURE	1-LUMP SUM

ROUTE 100
 PROJECT ST FL 50
 PIN 00R670

NOTE-
 THE REPAIRING OF PRESENT STEEL SUPERSTRUCTURE SHALL INCLUDE REPAIRING PRESENT LATERAL SYSTEM, REPLACING END PANELS OF BOTTOM CHORD, REPLACING ONE PANEL OF RAIL AND ADDING 2 NEW PANELS OF RAIL, ADDING AND SETTING ANCHOR BOLTS, AT EACH FOUR CORNERS OF BRIDGE; ALSO STRAIGHTENING ANY BENT MATERIAL AND PERFORMING ANY OTHER REPAIRS TO THE STEEL SUPERSTRUCTURE TO THE SATISFACTION OF THE ENGINEER.
 ALL NEW STEEL AND REPAIRS TO EXISTING STEEL TO BE GIVEN 2 COATS OF FIELD PAINT:
 1ST COAT - APPROVED RED LEAD PAINT.
 2ND COAT - APPROVED BLACK GRAPHITE PAINT.

MP 0.62-0.68
 RIGHT-OF-WAY DIVISION
 TOWN FILE
 PERPETUAL
 Town of _____
 (To Be Returned To R.O.W. Division)

CONTRACT
 A. D. DeLoop
 BRIDGE ENGINEER

APPROVED: May 22 1925
 H. Waugust
 CHIEF ENGINEER

MP 0.66

VENER PLANT BRIDGE
 OVER
 WHITE RIVER
 HANCOCK, VT.

Handwritten notes and stamps in the bottom left corner, including a date stamp 'May 22 1925' and other illegible markings.

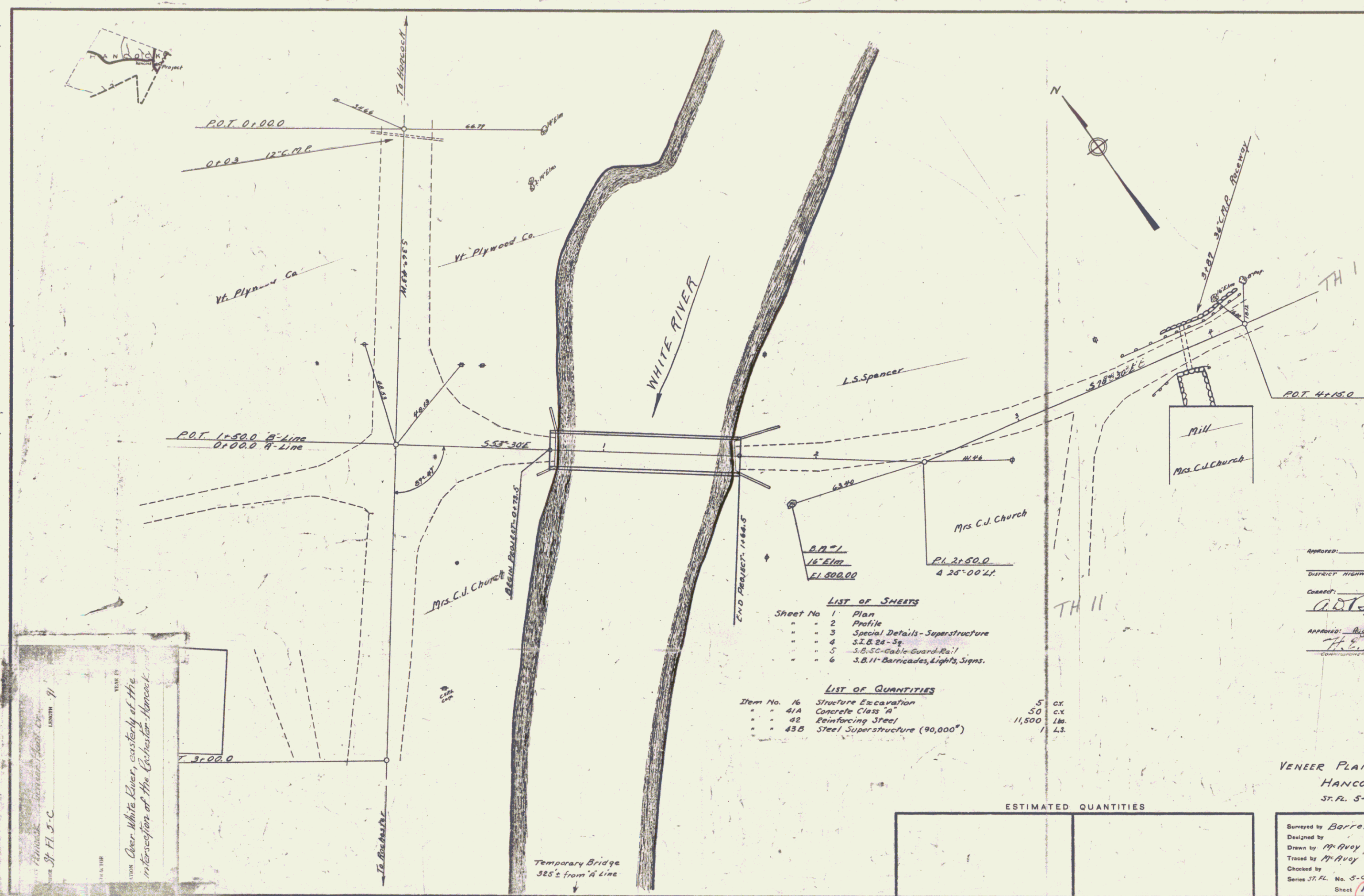

LIST OF SHEETS

Sheet No. 1	Plan
" 2	Profile
" 3	Special Details - Superstructure
" 4	S.B. 24 - Sg.
" 5	S.B. 50 - Cable Guard-Rail
" 6	S.B. 11 - Barricades, Lights, Signs.

LIST OF QUANTITIES

Item No. 16	Structure Excavation	5	cx.
" 41A	Concrete Class "A"	50	cx.
" 42	Reinforcing Steel	11,500	lbs.
" 43B	Steel Superstructure (90,000')	1	LS.

ESTIMATED QUANTITIES

APPROVED: _____ 1939
DISTRICT HIGHWAY COMMISSIONER
CORRECT: _____ 1939
A.D. Dickey
DISTRICT ENGINEER
APPROVED: *Ray H. Lee* 1939
The E. Doughty
COMMUNICATING ENGINEER

**VENER PLANT BRIDGE
HANCOCK, VT.
ST. FL. 5-C**

Surveyed by Barrett 7/38
Designed by
Drawn by M. Avey 7/39
Traced by M. Avey 7/39
Checked by
Series ST. FL. No. 5-C Filed
Sheet 1A of 6 Sheets

St. Fl. 5-C
YEAR IS
1939
DRAWN BY
M. Avey
CHECKED BY
M. Avey
DATE
7/39
BY
M. Avey
DATE
7/39

