

| Parcel | Kind of Data of Instrument | Grantor | Grantee                      | Recorded  | Remarks           |
|--------|----------------------------|---------|------------------------------|-----------|-------------------|
| A.B.C. | A.C.D.                     | 11-5-36 | LEWIS G. MUSSEY              | Book 308  | 11-10-36          |
| D.E.F. | G.H.I.                     | 1-6-37  | MARY R. GREEN & MARY J. BELL | 29 324-54 | 1-19-37           |
| J.K.L. | M.N.O.                     | 7-21-37 | LEWIS G. MUSSEY              | 29 340-9  | 7-23-37 3M 681-50 |

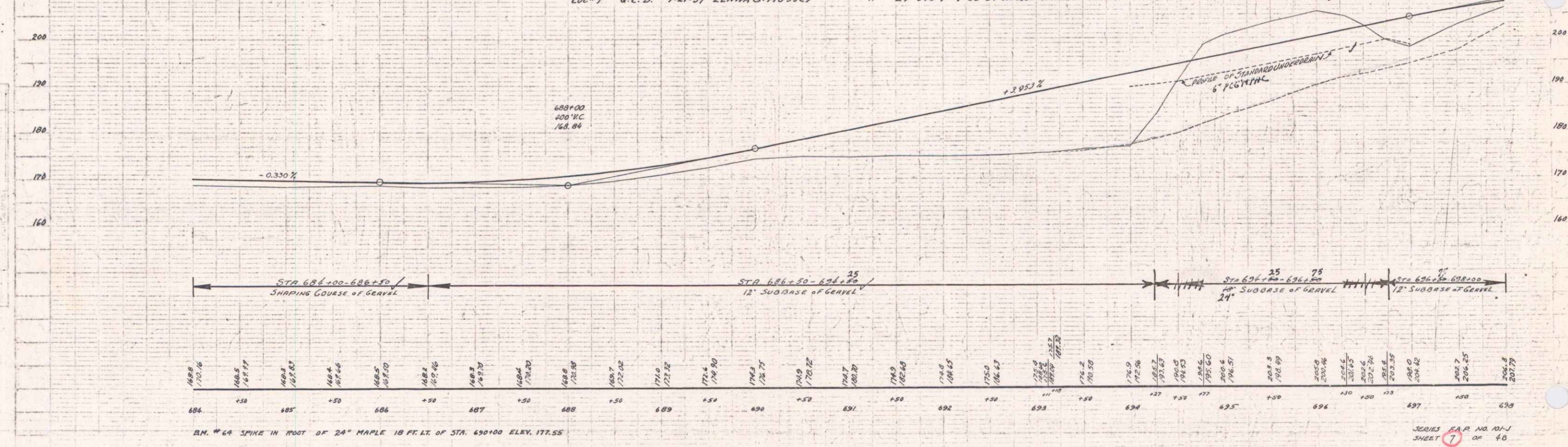

B.M. # 64 SPIKE IN ROOT OF 24" MAPLE 18 FEET. E. OF STN. 690+00 ELEV. 177.55  
 SERIES S.A.P. NO. 101-J SHEET 7 OF 46