

INDEX OF SHEETS

SHEET NO.	TITLE PAGE
1	TYPICAL CROSS-SECTION OF IMPROVEMENT
2	BANKING AND WIDENING TABLES
3	PLAN AND PROFILE STA.
4	DETAILS OF BRIDGE EXTENSION
5	STANDARD STRUCTURE SHEET
6	STANDARD STRUCTURE SHEET
7	STANDARD STRUCTURE SHEET
8	STANDARD STRUCTURE SHEET
9	STANDARD STRUCTURE SHEET
10	STANDARD STRUCTURE SHEET
11	STANDARD STRUCTURE SHEET
12	STANDARD STRUCTURE SHEET
13	STANDARD STRUCTURE SHEET
14	STANDARD STRUCTURE SHEET
15	STANDARD STRUCTURE SHEET
16	STANDARD STRUCTURE SHEET
17	STANDARD STRUCTURE SHEET
18	STANDARD STRUCTURE SHEET
19	STANDARD STRUCTURE SHEET
20	STANDARD STRUCTURE SHEET
21	STANDARD STRUCTURE SHEET
22	STANDARD STRUCTURE SHEET
23	STANDARD STRUCTURE SHEET
24	STANDARD STRUCTURE SHEET
25	STANDARD STRUCTURE SHEET
26	STANDARD STRUCTURE SHEET
27	STANDARD STRUCTURE SHEET
28	STANDARD STRUCTURE SHEET
29	STANDARD STRUCTURE SHEET
30	STANDARD STRUCTURE SHEET
31	STANDARD STRUCTURE SHEET
32	STANDARD STRUCTURE SHEET
33	STANDARD STRUCTURE SHEET
34	STANDARD STRUCTURE SHEET
35	STANDARD STRUCTURE SHEET
36	STANDARD STRUCTURE SHEET
37	STANDARD STRUCTURE SHEET
38	STANDARD STRUCTURE SHEET
39	STANDARD STRUCTURE SHEET
40	STANDARD STRUCTURE SHEET
41	STANDARD STRUCTURE SHEET
42	STANDARD STRUCTURE SHEET
43	STANDARD STRUCTURE SHEET
44	STANDARD STRUCTURE SHEET
45	STANDARD STRUCTURE SHEET
46	STANDARD STRUCTURE SHEET
47	STANDARD STRUCTURE SHEET
48	STANDARD STRUCTURE SHEET
49	STANDARD STRUCTURE SHEET
50	STANDARD STRUCTURE SHEET

FED. ROAD DIST. NO.	STATE	FED. AID PROJ. NO.	FISCAL YEAR	SHEET NO.	TOTAL SHEETS
9	VT.	101-J	1937	1	68

**STATE OF VERMONT
STATE HIGHWAY DEPARTMENT**

**PLAN AND PROFILE OF PROPOSED
STATE HIGHWAY**

FEDERAL AID PROJECT

TOWNS OF PITTSFIELD & STOCKBRIDGE

BETHEL - RUTLAND ROAD

FROM A POINT 1.277 MILES EAST OF THE STOCKBRIDGE
PITTSFIELD TOWN LINE WESTERLY 2.086 MILES TO A POINT 0.809 MILES
WEST OF THE STOCKBRIDGE-PITTSFIELD TOWN LINE.

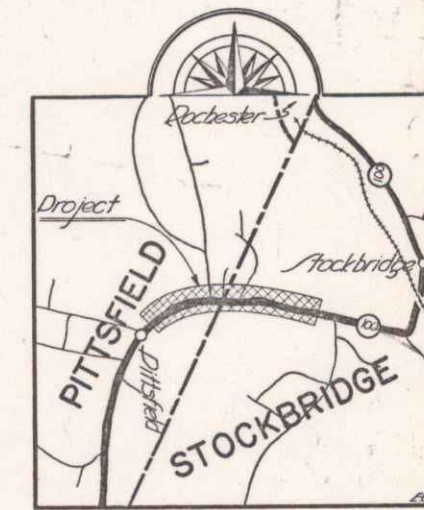

Scale 1 inch = 1 mile

STANDARD STRUCTURE SHEETS APPROVED
BY THE CHIEF ENGINEER

5-28	JULY 11, 1937
5-29	JULY 11, 1937
5-30	AUG 12, 1937
5-31	JULY 23, 1937

(To Be Returned To H.O.M. Division)

Term of 14-100

PERPETUAL

TOWN FILE

RIGHT-OF-WAY DIVISION

LENGTH OF PROJECT: 11,017.6 FT. = 2.086 MILES

RECORD PLANS

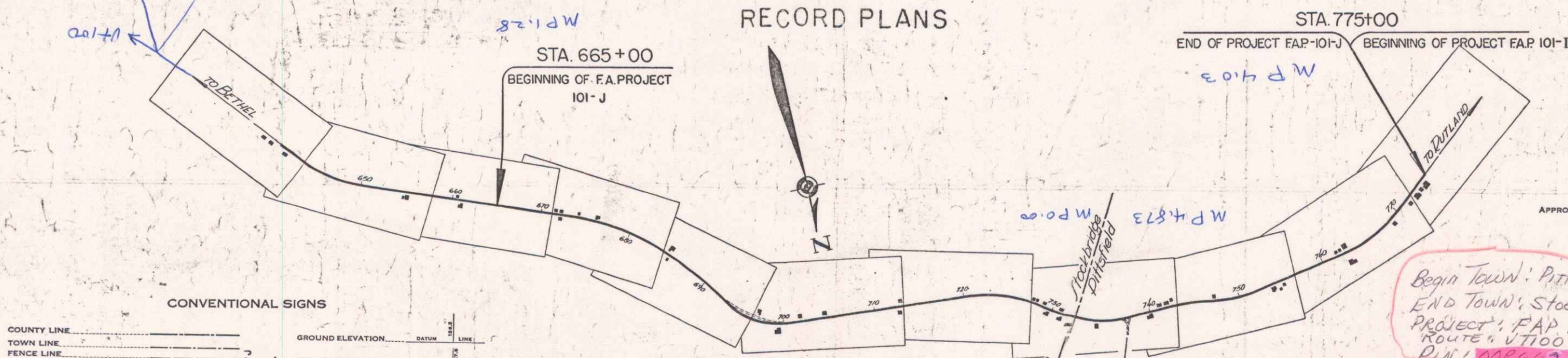

APPROVED: Sept. 15, 1939
H. F. Burgess
COMMISSIONER OF HIGHWAYS

BEGIN TOWN: PITTSFIELD
END TOWN: STOCKBRIDGE
PROJECT: FAP 101-J
ROUTE 4, VT 100
P.W. 000002

CONVENTIONAL SIGNS

COUNTY LINE	GROUND ELEVATION
TOWN LINE	TOWN LINE
FENCE LINE	GRADE ELEVATION
STONE WALL	
UNFENCED PROPERTY	
GUARD RAIL	
TRAVELED WAY	
RAILROAD	
RETAINING WALL	
CENTER LINE	
SURVEY LINE	
CULVERT	
DROP INLET	
TROLLEY POLE	
POWER POLE	
TELEPHONE POLE	
TREES	
HEDGE	

CURVE DATA

DEFLECTION ANGLE	Δ
DEGREE OF CURVE	D
RADIUS OF CURVE	R
TANGENT DISTANCE	T
LENGTH OF CURVE	L
EXTERNAL DISTANCE	E
POINT OF INTERSECTION	P. I.
POINT OF CURVE	P. C.
POINT OF TANGENT	P. T.
POINT ON TANGENT	P. O. T.

SCALES

TITLE	1" = 600'
TYPICAL	1" = 2'
PLAN	1" = 50'
PROFILE	1" = 20'
CROSS SECTIONS	1" = 5'

NOTES: ANY FURTHER INFORMATION CONCERNING
FINAL QUANTITIES, ACCOUNTS OR OTHER MATTERS
RELATIVE TO THIS PROJECT CAN BE OBTAINED IN
EITHER THE FIELD BOOKS OR THE ESTIMATE
FILE.

These plans are subject to such revisions as may be
required by the Bureau of Public Roads or the Com-
missioner of Highways.
Construction is to be carried out in accordance
with the plans and Standard Road & Bridge Specifi-
cations of 1936 including all subsequent approved
revisions and such revised specifications and special
provisions as are submitted with the plans.

RECOMMENDED _____
DISTRICT ENGINEER BUREAU OF PUBLIC ROADS

RECOMMENDED FOR APPROVAL _____
CHIEF ENGINEER BUREAU OF PUBLIC ROADS

APPROVED _____
DIRECTOR BUREAU OF PUBLIC ROADS