

INDEX OF SHEETS

SHEET NO.	TITLE PAGE
2	TYPICAL CROSS-SECTION OF IMPROVEMENT
3	BANKING AND WIDENING TABLES
4-7	PLAN AND PROFILE SHEETS
10	DETAIL OF SPECIAL CURVE INLET
19	CONCRETE CURB AROUND DRAIN INLET
20	6" x 6" R.C. BOX STA 446 + 25
21	5" x 5" R.C. BOX STA 490 + 31
22	STRUCTURE - 51024 - 45° SKEW (USE 3-04 SPANS)
23	ABUTMENT DETAILS
24	PIER DETAILS
25	CABLE GUARD RAIL - SB NO. 50
26	SB NO. 20, DETAILS 503, 507, 509, 512 & GENERAL NOTES
27	STANDARD STRUCTURE SHEET 520, PIPE CULVERTS
28	" " " " 529, BOX "
29	" " " " 530, GUARD RAIL "
30	" " " " 531, BOUNDARY MARKERS "
31	" " " " 535, CONCRETE CRIBBING "
32	" " " " 540, BARRICADES, SIGNS & LIGHTS "
33-130	CROSS-SECTION SHEETS

Standard Structure Sheets approved by the Chief Engineer

520	July 11, 1933
529	July 11, 1933
530	Aug 15, 1934
531	July 25, 1934

STATE OF VERMONT
 STATE HIGHWAY DEPARTMENT
PLAN AND PROFILE OF PROPOSED STATE HIGHWAY
 FEDERAL AID PROJECT
TOWN OF STOCKBRIDGE
 BETHEL - RUTLAND ROAD

BEGINNING AT A POINT 0.523 MILES FROM THE WEST END OF STONEY BROOK BRIDGE AND EXTENDING WESTERLY 3.316 MILES TO A POINT 1.277 MILES EAST OF THE STOCKBRIDGE - PITTSFIELD TOWN LINE.

LENGTH OF ROADWAY	17,257.9 FT. = 3.268 MILES
LENGTH OF BRIDGE	252.0 FT. = 0.048 MILES
TOTAL LENGTH OF PROJECT	17,509.9 FT. = 3.316 MILES

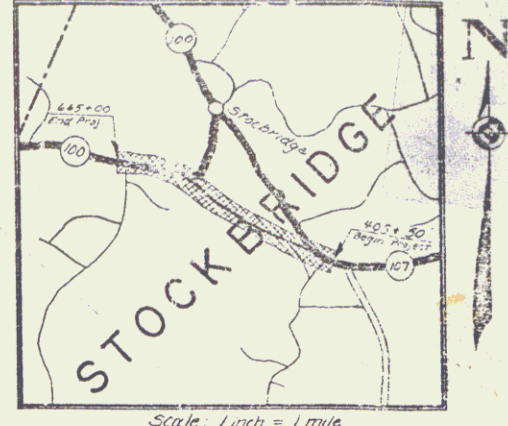

(To Be Returned to E.O.W. Division)
 Form of **VT 107**
 REPERMITS
 TOWN FILE
 HIGHWAY DIVISION

Pin # **00R660**
 Project **FAP 223**
 Route **VT 100**
 Date **6/7/1937**

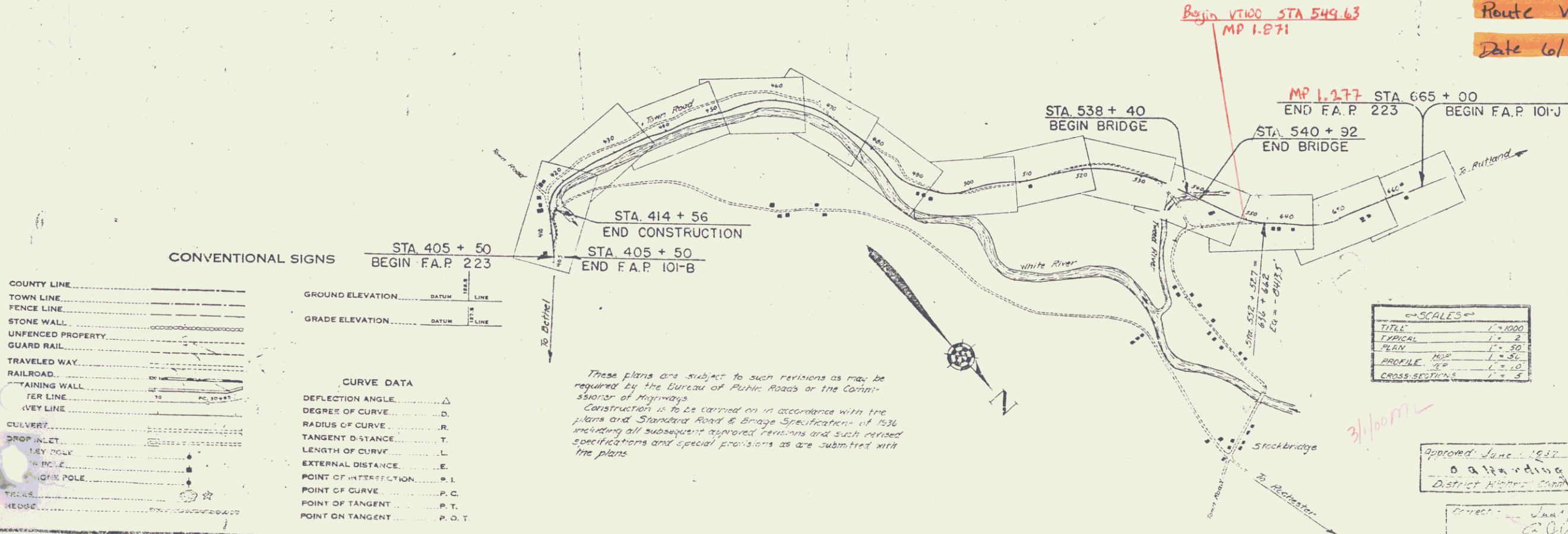

APPROVED: June 16, 1937
F.E. Stewart
 COMMISSIONER OF HIGHWAYS

RECOMMENDED FOR APPROVAL
 DISTRICT ENGINEER
 RECOMMENDED FOR APPROVAL
 DISTRICT ENGINEER
 APPROVED
 DISTRICT ENGINEER

Approved June 1937
 District Engineer

Approved Jan 7, 1937
 District Engineer

SERIES F NO 21
 SHEET 1 OF 130
 DIST. #4 PLANS