

WOOD GUARD RAIL REQUIRED

Lt.	24 Lin. Ft.
Sta. 0+64 to Sta. 0+88	24 " "
Sta. 1+22 to Sta. 1+46	24 " "
At.	70 " "
Sta. 0+64 to Sta. 0+88	70 " "
Sta. 1+22 to Sta. 2+00	70 " "
	<u>130 Lin. Ft.</u>

COMMON EXCAVATION INCLUDING BORROW
ESTIMATED QUANTITY 125 Cu. Yds.

Note:
Present superstructure to be removed
by the contractor and paid for under item
No. 15 Structure Excavation.

GRAVEL SURFACE COURSE REQUIRED
ESTIMATED QUANTITY 124 Cu. Yds.

STATE ROAD DIST. NO. 1 STATE F.R.
J.C. 1929 T 12

INDEX OF SHEETS

Series S.T.B. 20	No 30	Span Square with Gravel	320 - -
Series S.B.	No 2	Typical Details	41 - -
Series S.A.	No 9	Soil Profile	102 - -
Series S.A.R.	No 12	Height Square	20,530 lbs.
Series S.	No 19	Standard Structures	150 Lin. Ft.

SUMMARY OF QUANTITIES

Item No. 10-11	Common Excavation Including Borrow	125 Cu. Yds.
Item No. 15	Structure Excavation	320 - -
Item No. 20A	Gravel Surface Course	124 - -
Item No. 34A	Concrete Class A 1'-2'-4	41 - -
Item No. 34B	Concrete Class B 1'-2'-5	102 - -
Item No. 35	Reinforcing Steel	20,530 lbs.
Item No. 66	Wood Guard Rail	150 Lin. Ft.
Item No. 55	Temporary Bridge - maintaining traffic	1 Lump Sum

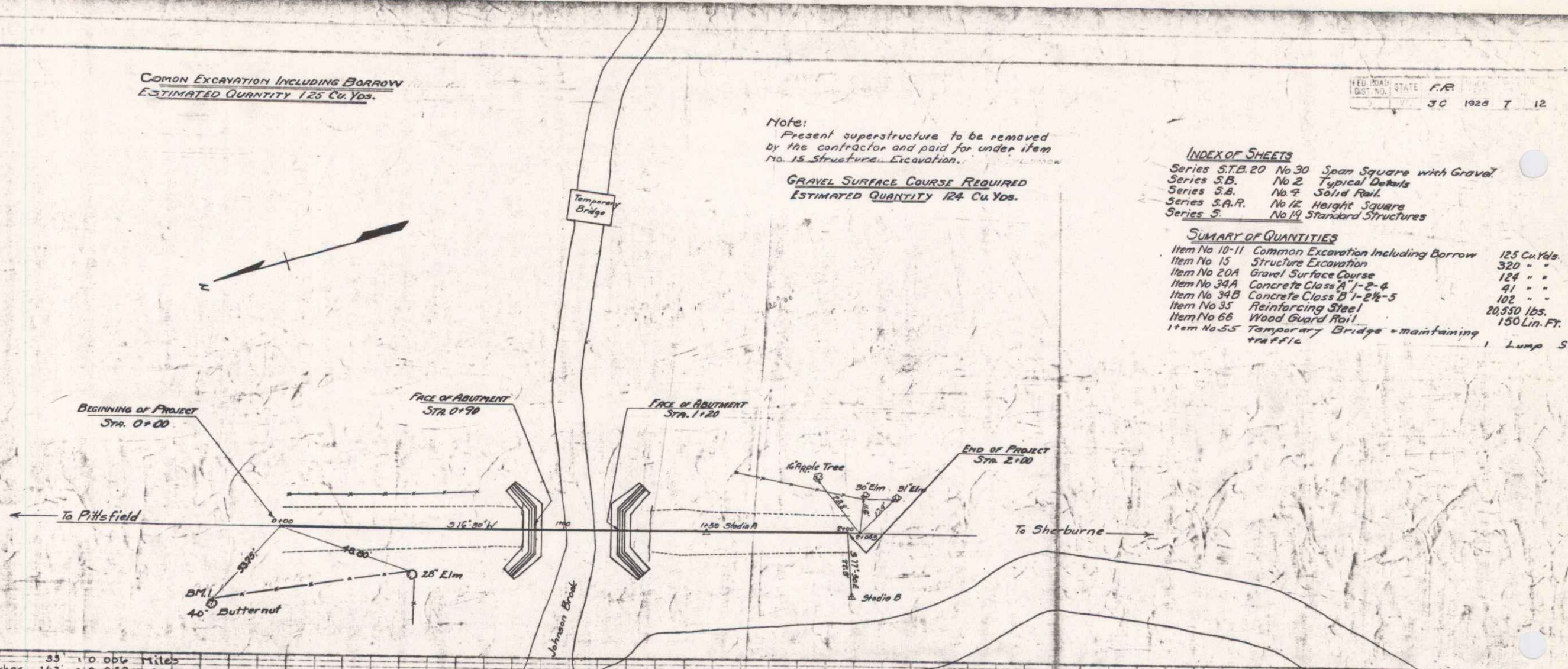

Length of bridge	35	10	0.06	tiles
approaches	167	0	0.052	
Project	200	0	0.050	

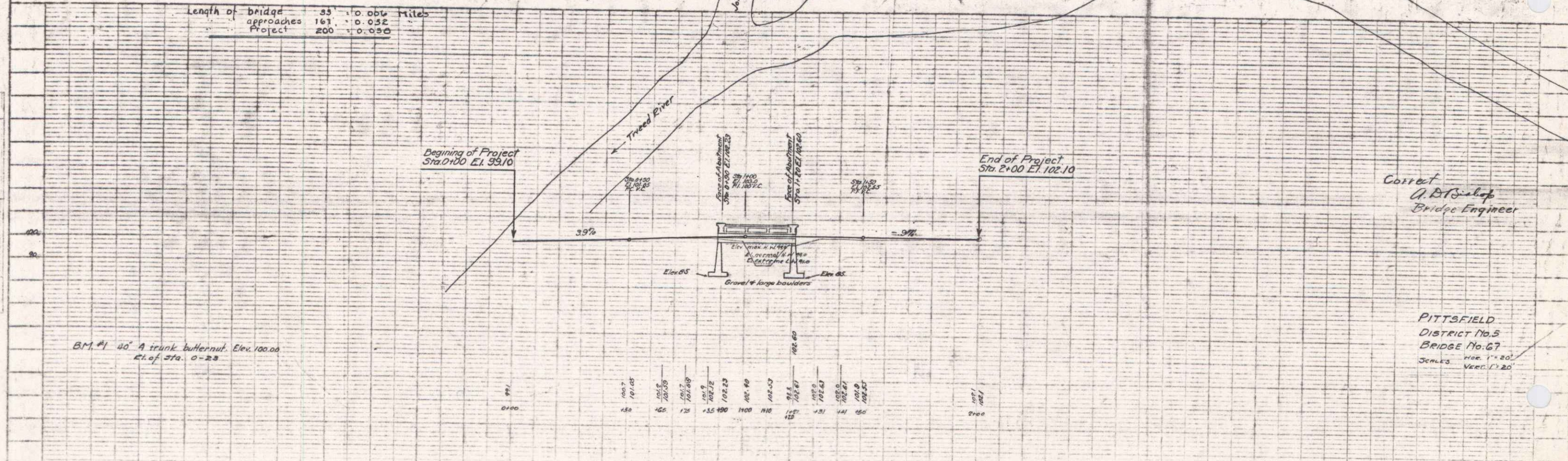

B.M. #1 40' A trunk butternut. Elev. 100.00
Elev. of Sta. 0+28

Correct
A. B. Schup
Bridge Engineer

PITTSFIELD
DISTRICT No. 5
BRIDGE No. 67
Scale: 1" = 20'
Vertical: 1" = 20'