

NOTE
 Material for sub-base of gravel from 11-11-11
 Curve for sub-base on this project is to be obtained by the Contractor from the river bed of the West Bank of Thumb River, both upstream and downstream from the bridge of Sta. 798+00.0.
 The State has made no arrangements relative to rights-of-way, purchase of material, nor any other arrangements, it being necessary for the Contractor to carry out these requirements.
 No estimate is made by the State of the amount of material available at the location specified above. If the supply of gravel at this location is not sufficient, the additional gravel required for sub-base shall be obtained, in so far as possible, from materials at other locations.

Parcel	Kind of Instrument	Date of Grant or Testament	Grantee	Recorded Book Page	Recorded Date	Remarks
A	H.D.	5-26-35	John Milton Brown	14 906	10-3-35	
A'	H.D.	5-26-35	Franklin A. Fish	14 908	10-3-35	

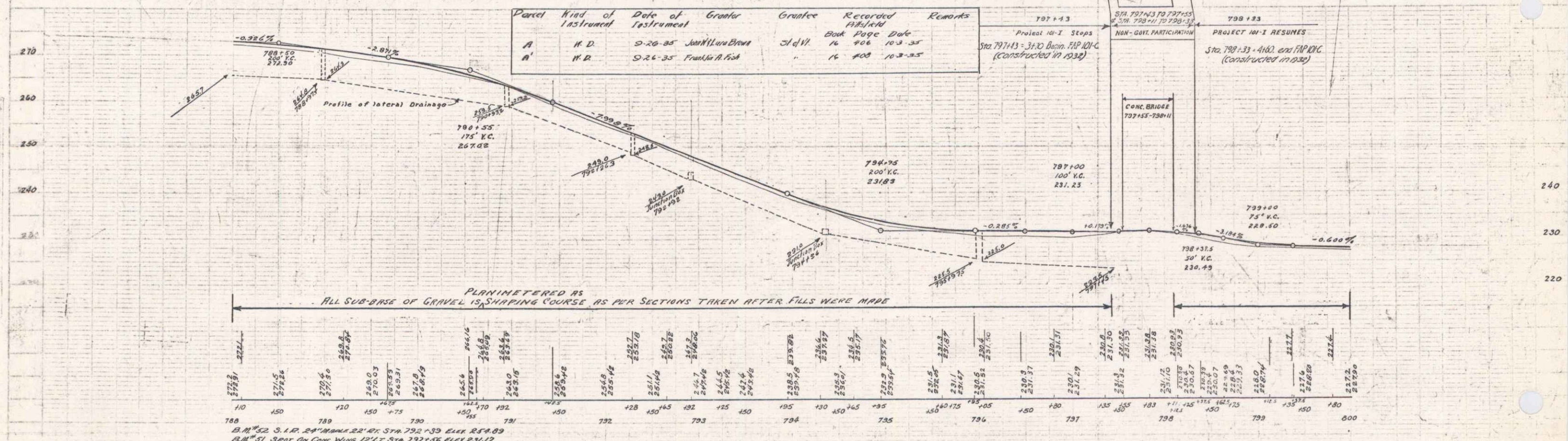

ALL SUB-BASE OF GRAVEL IS SHAPING COURSE AS PER SECTIONS TAKEN AFTER FILLS WERE MADE