

INDEX OF SHEETS

SHEET NO. 1	TITLE PAGE
" 2	TYPICAL CROSS-SECTION OF IMPROVEMENT SUMMARY OF QUANTITIES
" 3	STANDARD STRUCTURE SHEET ROUNDING OF SLOPES 5:1
" 4	LAYOUT SHEETS
" 5-9	CROSS SECTIONS

(To Be Returned To R.O.W. Division)

OWN OF
 1/100
 PERMIT
 TOWN FILE
 RIGHT-OF-WAY DIVISION
 M P 22 - 3.57
 2.66 3.44

STATE OF VERMONT
 STATE HIGHWAY DEPARTMENT

PLAN AND PROFILE OF PROPOSED
 STATE HIGHWAY

FEDERAL AID PROJECT

ROADSIDE IMPROVEMENT

TOWN OF SHERBURNE

BETHEL - RUTLAND ROAD

ROUTE 100

BEGINNING 2658.7 FT. S. WESTERLY FROM THE PITTFIELD
 SHERBURNE TOWN LINE AND EXTENDING S. WESTERLY 0.738 MI.

LENGTH OF PROJECT 3897.5 FEET - 0.738 MILES

SCALES

TYPICAL SECTIONS AS INDICATED
 LAYOUTS 1" = 50'

These plans are subject to such revisions as may be required
 by the Bureau of Public Roads or the Commissioner of
 Highways.

Construction is to be carried out in accordance
 with the plans & standard Road & Bridge specifications
 of 1936 as approved Dec. 29, 1936 by the Bureau of
 Public Roads including all subsequent approved
 revisions & such revised specifications & special provisions
 as are submitted with the plans.

PER. ROAD	STATE	FED. AID	TOTAL	SHEET	TOTAL
DIST. NO.	NO.	PROJ. NO.	NO.	NO.	SHEETS
5	VT.	201-F	1031	7	9

(Continued)

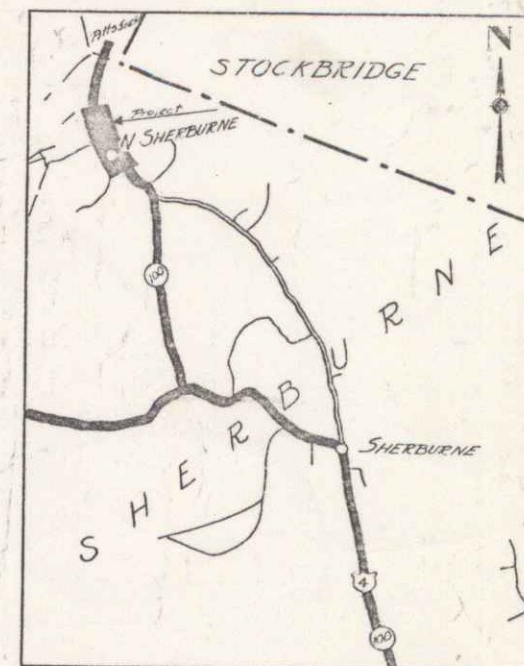

Scale 1"=1Mile

CONVENTIONAL SIGNS

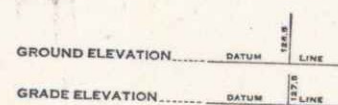
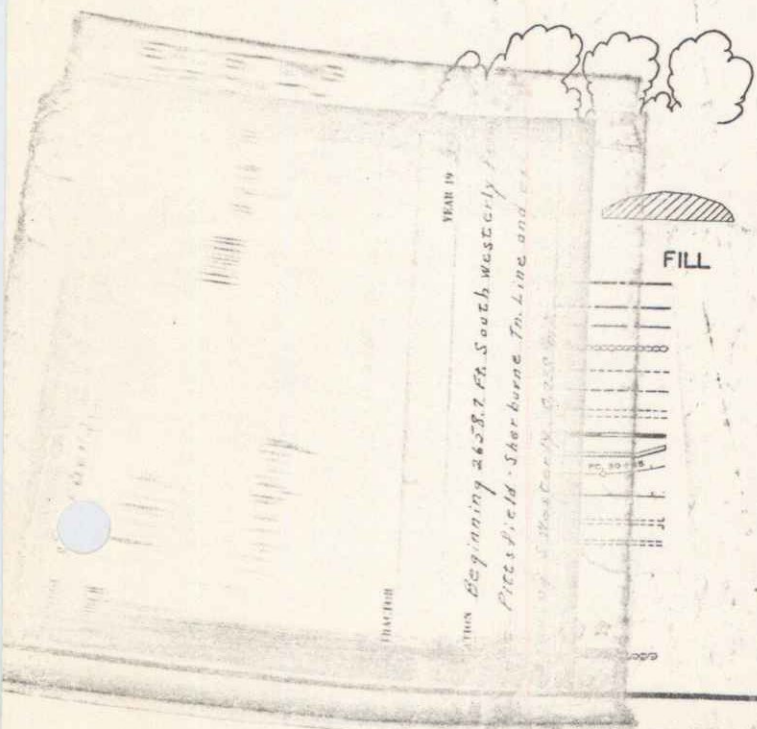

CURVE DATA

DEFLECTION ANGLE	Δ
DEGREE OF CURVE	D
RADIUS OF CURVE	R
TANGENT DISTANCE	T
LENGTH OF CURVE	L
EXTERNAL DISTANCE	E
POINT OF INTERSECTION	P. I.
POINT OF CURVE	P. C.
POINT OF TANGENT	P. T.
POINT ON TANGENT	P. O. T.

PAN: 006654
 PROJECT: FAP 101F
 ROUTE: VT. 100

APPROVED: July 22, 1938
 H. E. [Signature]
 COMMISSIONER OF HIGHWAYS
 SUBMITTED BY ORDER OF THE STATE HIGHWAY BOARD

APPROVED: July 18, 1938
 Paul R. [Signature]
 DISTRICT HIGHWAY COMM.

RECOMMENDED [Signature]
 DISTRICT ENGINEER BUREAU OF PUBLIC ROADS
 RECOMMENDED FOR APPROVAL [Signature]
 CHIEF ENGINEER BUREAU OF PUBLIC ROADS
 APPROVED [Signature]
 DIRECTOR BUREAU OF PUBLIC ROADS

APPROVED: July 7, 1938
 G. W. [Signature]
 ROAD ENGINEER
 SERIES FAP NO. 101F FILED
 SHEET 7 OF 9

DIST. #3 PLANS

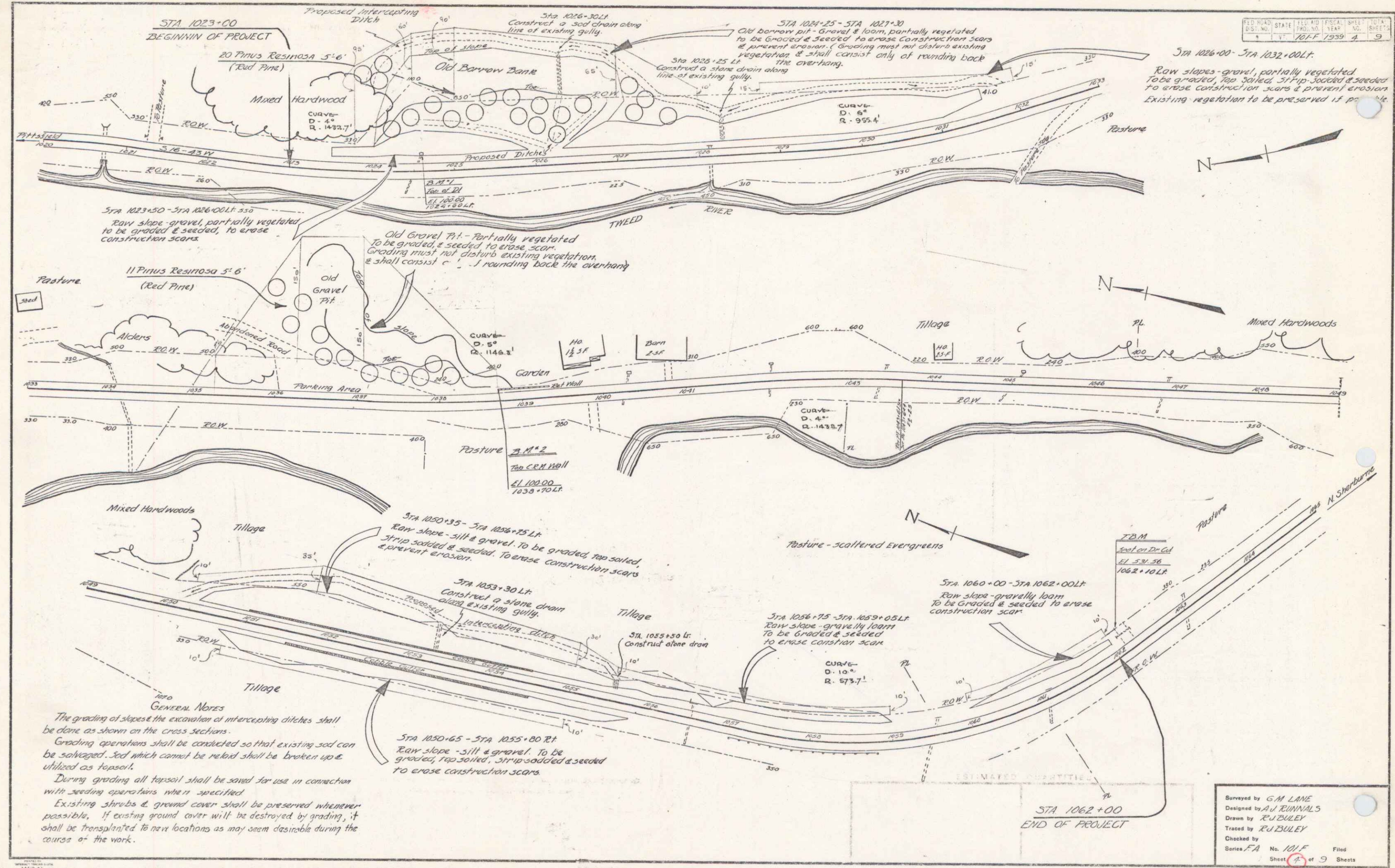

GENERAL NOTES
 The grading of slopes & the excavation of intercepting ditches shall be done as shown on the cross sections.
 Grading operations shall be conducted so that existing soil can be salvaged. Soil which cannot be reused shall be broken up & utilized as topsoil.
 During grading all topsoil shall be saved for use in connection with seeding operations when specified.
 Existing shrubs & ground cover shall be preserved whenever possible. If existing ground cover will be destroyed by grading, it shall be transplanted to new locations as may seem desirable during the course of the work.

Surveyed by G.M. LANE
 Designed by A.J. RENNALS
 Drawn by R.J. BULEY
 Traced by R.J. BULEY
 Checked by
 Series FA No. 101-F Filed
 Sheet 4 of 9 Sheets

