

STA. 1016+00
BEGINNING OF PROJECT

Partially Vegetated Slope
TRANSPLANT EXISTING LOCAL GROUND COVER SO AS TO EXTEND VEGETATION COMPLETELY OVER SLOPE.
Note: Existing growth not to be disturbed by grading.

Row Slope - Gravel
GRADE, TOPSOIL, STRIP 500 & SEED.
B.M. 100.00
Spot on Header

Partially vegetated slope - gravelly
GRADE, TOPSOIL, STRIP 500 & SEED.
Note: Established vegetation between st. 1023 and 1024 not to be disturbed by grading. Other existing growth to be preserved and replanted between sod-strips.
Mixed Hardwoods
B.M. 100.00
Spot on PI

Partially vegetated slope - gravel
GRADE, TOPSOIL, STRIP 500 & SEED.
Note: Existing ground cover to be preserved, and replanted between the sod-strips.

Row Slope - Gravel
GRADE AND SOO
Note: Grading to be modified so that it will not interfere with garden.

Partially Vegetated Steep Slope
GRADE AND SOO.
Note: All existing ground cover to be removed and preserved for transplanting on such slopes as require this treatment. Grading operations to consist of slight rounding only, so as to disturb ground above slope as little as possible.

Row Slope - Gravel
300
Note: Because of steepness of upper slope, no grading shall be attempted. Sod to be applied so that it will fit smoothly with existing turf.

Partially Vegetated Slope
GRADE AND TRANSPLANT EXISTING LOCAL GROUND COVER TO COMPLETELY COVER SLOPE.
Note: Grading to consist only of removing overhang, as growth above slope should not be disturbed.

Row Slope - Silt & Gravel
GRADE, TOPSOIL, STRIP 500 & SEED.
Note: Berm diked to be constructed, with a run-off slope drain provided at st. 1053+30 ft.

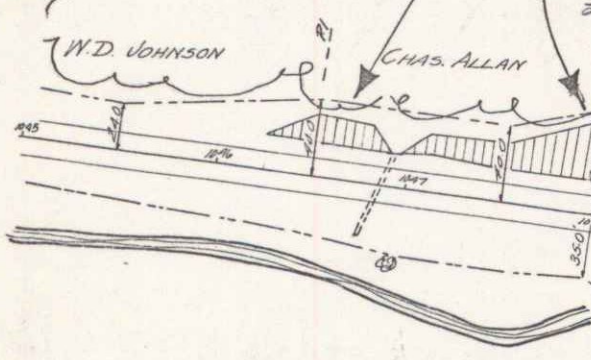

B.M.
Spot on Bank Int.
E.L. 465.35

Row Slope - Silt & Gravel
GRADE, TOPSOIL, STRIP 500 & SEED.

ESTIMATED QUANTITIES

Surveyed by A. Coleman
Designed by A. Runnals
Drawn by
Traced by P. Buley
Checked by
Series F.A.P. No. 101-F
Sheet 7 of 10 Sheets