

4-5 PLAN AND PROFILE SHEETS  
 6 STANDARD STRUCTURE SHEETS 3.00 PIPE CULVER  
 7 BRIDGES, SIGNS AND LIGHTS 20.00  
 8-10 CROSS SECTIONS  
 STANDARD STRUCTURE SHEET 3.20 SUBMITTED BY  
 THE CHIEF ENGINEER ON MAR. 16, 1933

STATE HIGHWAY DEPARTMENT

PLAN AND PROFILE OF PROPOSED  
 STATE HIGHWAY

FEDERAL AID PROJECT

TOWN OF SHERBURNE  
 BETHEL-RUTLAND ROAD

FROM THE CONCRETE BRIDGE OVER BRANCH OF OTTAUQUECHEE  
 RIVER, SOUTHERLEY 0.472 MILES TO ITS INTERSECTION WITH  
 THE WOODSTOCK-RUTLAND ROAD.  
 LENGTH OF PROJECT 2,496.4 FT. 0.472 MILES



POOR ORIGINAL COPY

Town: SHERBURNE  
 Route: VT100  
 Project: FAE 101 G  
 Date: 10/07/1934  
 PIN: 00651

DA  
 3/2/00

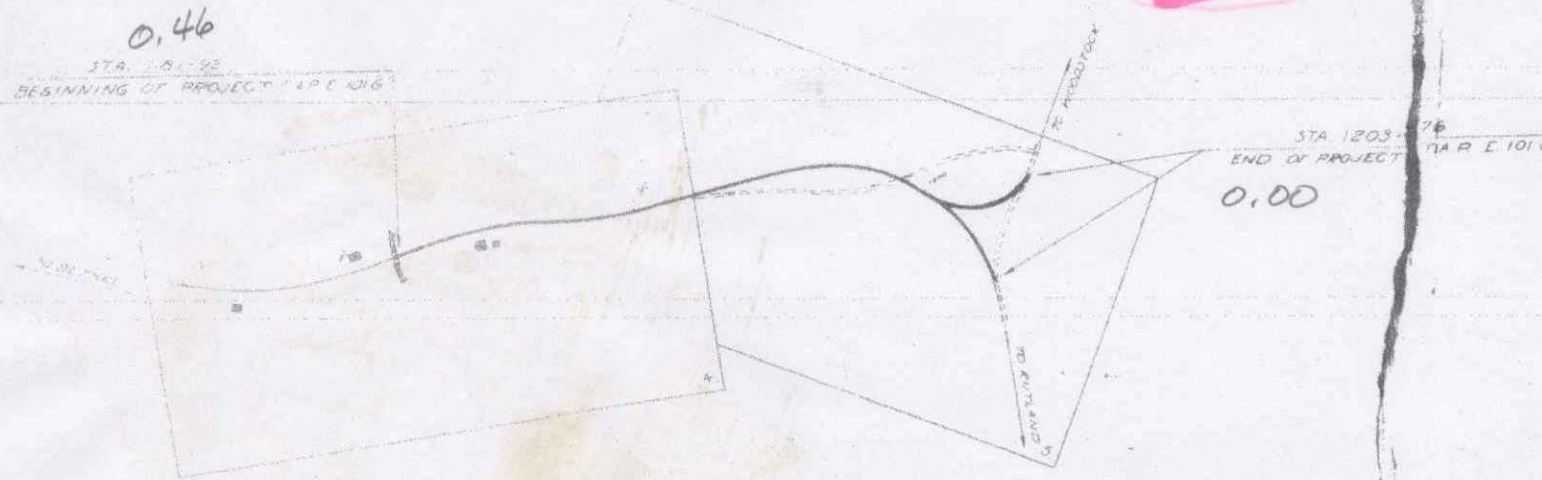

PROJECT NUMBER	101 G
TOWN	SHERBURNE
DATE	10/07/1934
ENGINEER	H. C. [Signature]
CHECKED	[Signature]

CONVENTIONAL SIGNS

GROUND ELEVATION	1/8" = 10'
GRADE ELEVATION	1/8" = 10'
CURVE DATA	
DEFLECTION ANGLE	Δ
DEGREE OF CURVE	D
RADIUS OF CURVE	R
TANGENT DISTANCE	T
LENGTH OF CURVE	L
EXTERNAL DISTANCE	E
POINT OF INTERSECTION	P. I.
POINT OF CURVE	P. C.
POINT OF TANGENT	P. T.
POINT ON TANGENT	P. O. T.

SCALE	1/8" = 10'
VERTICAL CURVE	1" = 10'
CROSS SECTIONS	1" = 10'
BRIDGES	1" = 10'
SIGNS	1" = 10'

THESE PLANS ARE SUBJECT TO SUCH REVISIONS AS MAY BE REQUIRED BY THE COMMISSIONER OF PUBLIC ROADS OR THE COMMISSIONER OF HIGHWAYS. CONSTRUCTION IS TO BE IN ACCORDANCE WITH THE STANDARD ROAD AND BRIDGE SPECIFICATIONS OF 1930 WITH ALL SUBSEQUENT APPROVED REVISIONS AND SUCH SPECIFICATIONS AND SPECIAL PROVISIONS AS ARE SUBMITTED WITH THE PLANS.

APPROVED October 17, 1934  
 H. C. [Signature]  
 COMMISSIONER OF HIGHWAYS

RECOMMENDED [Signature]  
 RECOMMENDED FOR APPROVAL [Signature]  
 APPROVED [Signature]

CORRECT [Signature]  
 SERIES PAR NO. E 106 FILE  
 SHEET 1 OF 16