

INDEX OF SHEETS

SHEET NO. 1	TITLE PAGE
2	TYPICAL CROSS-SECTION OF IMPROVEMENT
3	BANKING AND WIDENING TABLES
4-12	LAYOUTS
13	STANDARD STRUCTURE SHEET 3-20 PIPE CULVERT
14	" " " " 3-21 BOX CULVERT
15	" " " " 3-22 GUARD RAIL
16-17	BARRICADES, SIGNS AND LIGHTS 55-11
18-48	CROSS SECTIONS

FED. ROAD DIST. NO.	STATE	FED. AID PROJ. NO.	FISCAL YEAR	SHEET NO.	TOTAL SHEETS
9	VT.	5-127-B	1932	1	48

STATE OF VERMONT
STATE HIGHWAY DEPARTMENT

PLAN AND PROFILE OF PROPOSED
STATE HIGHWAY

FEDERAL AID PROJECT

TOWN OF NEWPORT
NEWPORT-BURLINGTON ROAD

FROM THE END OF THE CONCRETE PAVEMENT
OF 127-A SOUTH 2.456 MILES TO A
POINT 500 FEET WEST OF THE RESIDENCE OF W. KIMBALL
LENGTH OF PROJECT: 12,969.6 FT. = 2.456 MILES

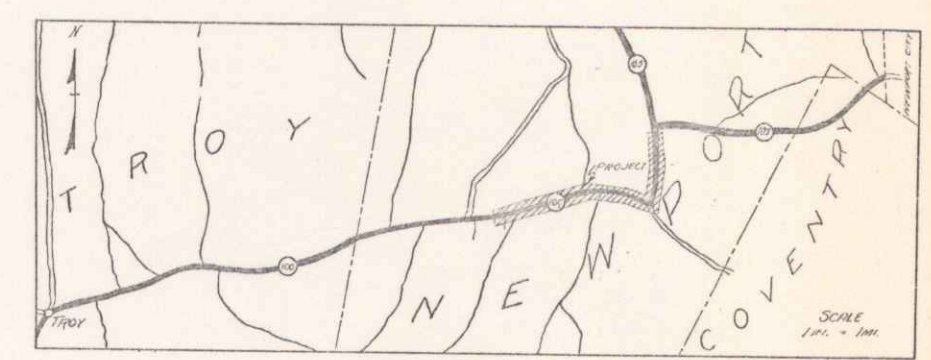

(To Be Returned to R.O.W. Division)
Town of Newport
Perpetual
Right-of-Way Division

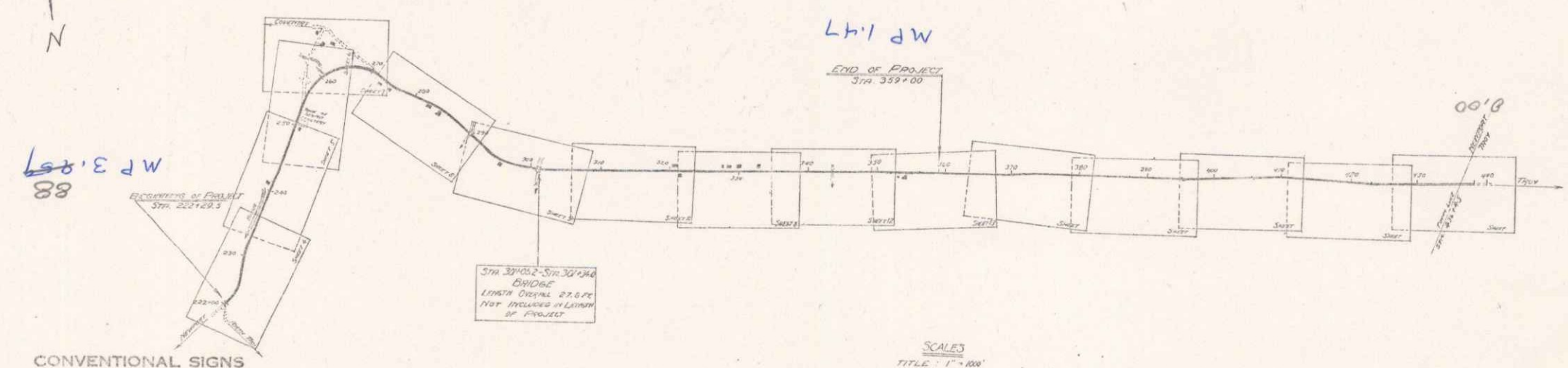
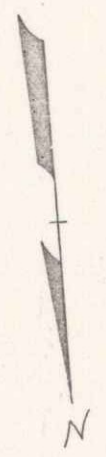

ROUTE: VT 100
PROJECT: FE 127-B
DATE: 09/12/1932
A.M. 008650

- CONVENTIONAL SIGNS
- COUNTY LINE
 - TOWN LINE
 - FENCE LINE
 - STONE WALL
 - UNFENCED PROPERTY
 - GUARD RAIL
 - TRAVELED WAY
 - RAILROAD
 - RETAINING WALL
 - CENTER LINE
 - SURVEY LINE
 - CULVERT
 - DRAIN INLET
 - TRUNKY POLE
 - POWER POLE
 - TELEPHONE POLE
 - TREES
 - WEDGE

- GROUND ELEVATION
 - GRADE ELEVATION
- CURVE DATA
- DEFLECTION ANGLE
 - DEGREE OF CURVE
 - RADIUS OF CURVE
 - TANGENT DISTANCE
 - LENGTH OF CURVE
 - EXTERNAL DISTANCE
 - POINT OF INTERSECTION
 - POINT OF CURVE
 - POINT OF TANGENT
 - POINT ON TANGENT

SCALE
TITLE: 1" = 100'
PLAN: 1" = 50'
PROFILE: 1" = 5'
CROSS SECTIONS: 1" = 5'

THESE PLANS ARE SUBJECT TO SUCH REVISIONS AS MAY BE REQUIRED BY THE BUREAU OF PUBLIC ROADS OR THE COMMISSIONER OF HIGHWAYS. CONSTRUCTION IS TO BE CARRIED ON IN ACCORDANCE WITH THE STANDARD ROAD AND BRIDGE SPECIFICATIONS OF 1930 WITH SUCH REVISED SPECIFICATIONS AND SPECIAL PROVISIONS AS ARE SUBMITTED WITH THESE PLANS.

APPROVED: SEPT. 12, 1932

Submitted by order of the State Highway Department

RECOMMENDED

RECOMMENDED FOR APPROVAL

APPROVED

CORRECTED: [Signature]
SERIES F. NO. 127-B FILED
SHEET 1 OF 48

DIST. # 9 PLANS