

Slope Ranges
 1750-1770 13.50 RT
 1770-2145 25.00 RT
 2145-2545 36.50 RT
 2545-3045 48.00 RT

Δ 11°51' RT
 D 2
 T 228.6
 L 595.0
 E 15.5
 PVI 1547.12
 13+50

Sta. P.P.T. To:
 Newport
 Series F
 No. E 127 B
 1932

PARCEL NO. 9
 BROWN, Elwyn L. & Hazel
 25+70 - 30+00 RT.
 0.24 A±
 SLOPE EASE (P) (0.24A±)
 25+70 - 30+00 RT.

PLAN
 DATE: _____
 DRAWN BY: _____
 CHECKED BY: _____
 IN CHARGE: _____

PARCEL NO. 1
 ROGINY, Adolof & Ida
 13+50 RT - 25+26 LT.
 1.50 A±
 SLOPE EASE (P) (0.31A±)
 13+50 RT - 25+26 LT.

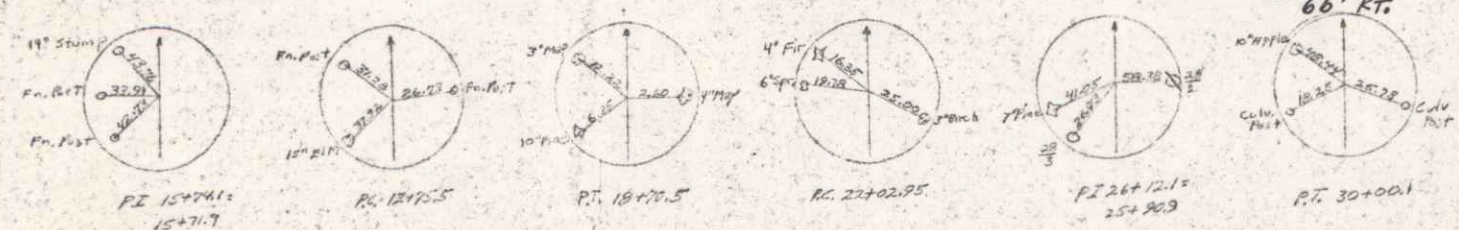

PROJECT: BMA 6418
 DATE: 01/01/1974
 TOWN: NEWPORT
 ROUTE: VT 100
 PIN: 30649

PROFILE
 DATE: _____
 DRAWN BY: _____
 CHECKED BY: _____
 IN CHARGE: _____

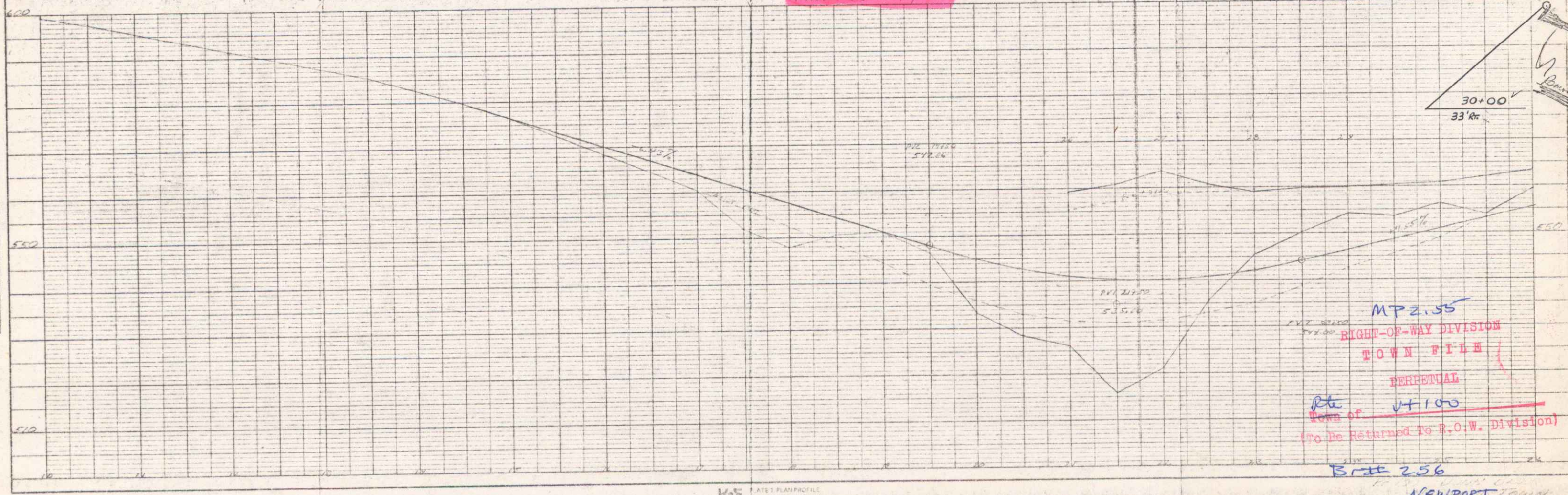

K&E
 45 704

MP 2.55
 RIGHT-OF-WAY DIVISION
 TOWN FILE
 PERPETUAL
 Town of VT 100
 (To Be Returned To R.O.W. Division)
 Sheet 256
 NEWPORT
 Dunn Brk!