

INDEX OF SHEETS

SHEET NO. 1 TITLE PAGE

2 TYPICAL CROSS-SECTION OF IMPROVEMENT (SEE NOTES, MAPS, AND PLAN)

3 DETAILS OF CONSTRUCTION - BANKING AND WIDENING TABLES

4-6 PLAN AND PROFILE SHEETS

7 STD. STRUCTURE SHEET - 58-11 - BARRIERS, SIGNS, AND LIGHTS

8 " " " " - 5-30 - GUARD RAIL

9 " " " " - 5-31 - BOUNDARY MARKERS

10-18 CROSS-SECTIONS

STANDARD SHEET 5-30 APPROVED BY THE CHIEF ENGINEER, ON AUG. 15, 1933.
STANDARD SHEET 5-31 APPROVED BY THE CHIEF ENGINEER, ON JULY 25, 1934.

(To Be Returned to R.O.W. Division)
TOWN OF TROY
PERPETUAL
TOWN FILE
RIGHT-OF-WAY DIVISION

STATE OF VERMONT
STATE HIGHWAY DEPARTMENT

PLAN AND PROFILE OF PROPOSED
STATE HIGHWAY

NATIONAL RECOVERY HIGHWAY PROJECT

TOWN OF TROY

NEWPORT-NORTH HYDE PARK ROAD

FROM 150 FEET EAST OF THE SCHOOL HOUSE IN TROY
VILLAGE SOUTHWESTERLY 0.646 MILES TO THE TROY-
WESTFIELD TOWN LINE

LENGTH OF PROJECT: 3412.1 FEET = 0.646 MILES.

FED. ROAD DIST. NO.	STATE	PLAN NO.	YEAR	SHEET NO.	TOTAL SHEETS
9	VT.	11435	1934	1	10

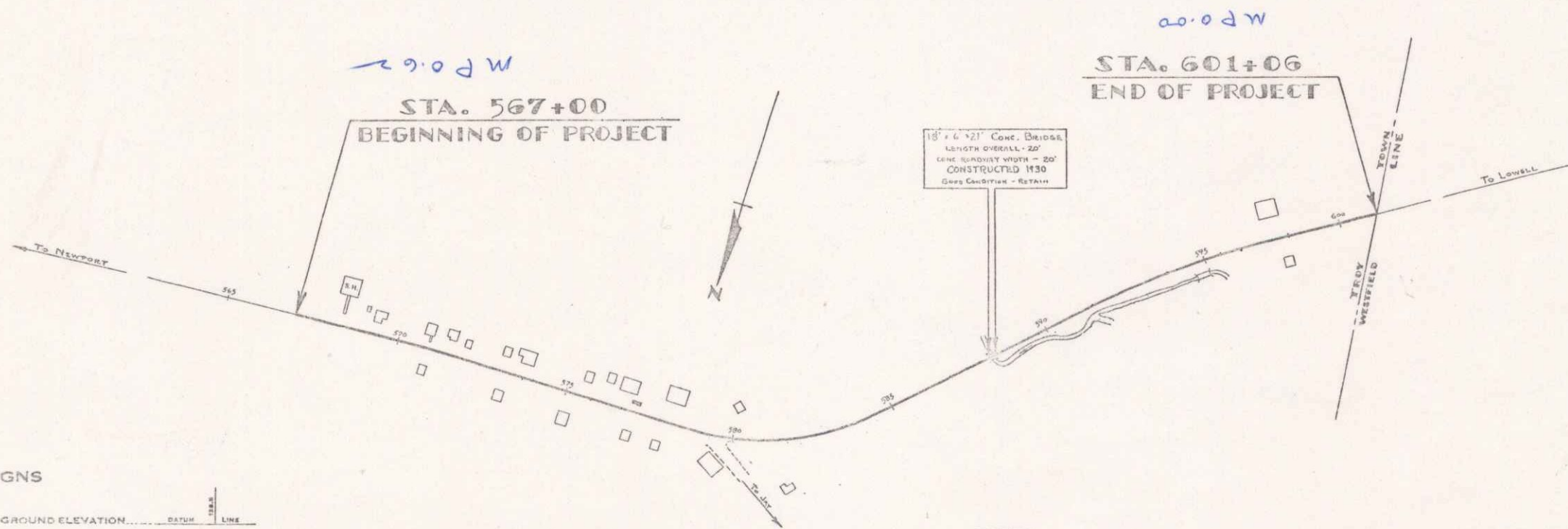
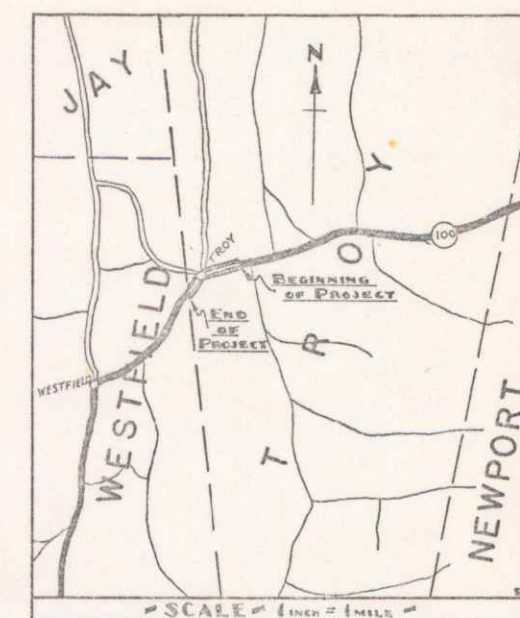

CONVENTIONAL SIGNS

COUNTY LINE	---
TOWN LINE	---
FENCE LINE	---
STONE WALL	---
UNFENCED PROPERTY	---
GUARD RAIL	---
TRAVELED WAY	---
RAILROAD	---
RETAINING WALL	---
CUT	---
SURFACE	---
CULVERT	---
DROP INLET	---
TROLLEY POLE	---
POWER POLE	---
TELEPHONE POLE	---
TREES	---
HEDGE	---

GROUND ELEVATION	BATH	LINE
GRADE ELEVATION	BATH	LINE

CURVE DATA

DEFLECTION ANGLE	Δ
DEGREE OF CURVE	D
RADIUS OF CURVE	R
TANGENT DISTANCE	T
LENGTH OF CURVE	L
EXTERNAL DISTANCE	E
POINT OF INTERSECTION	P. I.
POINT OF CURVE	P. C.
POINT OF TANGENT	P. T.
POINT ON TANGENT	P. O. T.

SCALES

PROFILE	1" = 20'
PLAN	1" = 50'
PIERCE - HOR.	1" = 50'
PIERCE - VER.	1" = 10'
CROSS-SECTIONS	1" = 5'

NOTE

THESE PLANS ARE SUBJECT TO SUCH REVISIONS AS MAY BE REQUIRED BY THE BUREAU OF PUBLIC ROADS AND THE COMMISSIONER OF HIGHWAYS. CONSTRUCTION IS TO BE CARRIED ON IN ACCORDANCE WITH THE PLANS AND STANDARD ROAD AND BRIDGE SPECIFICATIONS OF 1930 INCLUDING ALL SUBSEQUENT APPROVED REVISIONS, THE NATIONAL RECOVERY ACT SPECIAL PROVISIONS, AND SUCH REVISED SPECIFICATIONS AND SPECIAL PROVISIONS AS ARE SUBMITTED WITH THE PLANS.

Date 01/14/1935
Project: NRH 127D (1935)
Route: VT 100
P.W. 00P.045

APPROVED: JAN 14 1935
COMMISSIONER OF HIGHWAYS
SUBMITTED BY ORDER OF THE STATE HIGHWAY

RECOMMENDED
DISTRICT ENGINEER
BUREAU OF PUBLIC ROADS
RECOMMENDED FOR APPROVAL
CHIEF ENGINEER
BUREAU OF PUBLIC ROADS
APPROVED
CHIEF OF BUREAU OF PUBLIC ROADS

CORRECTED BY
SERIES NRH NO. 1147 D
SHEET 1 OF 10

DIST. #9 TROY