

**INDEX OF SHEETS**

SHEET NO. 1	TITLE PAGE
" 2	TYPICAL CROSS-SECTION OF IMPROVEMENT
" 3	DETAILS OF CONSTRUCTION - BANKING & WIDENING TABLE
4-9	PLAN & PROFILE SHEETS
10	STD. STRUCTURE SHEET
11	"
12	"
13	"
14	"
15-29	CROSS SECTIONS
STANDARD SHEET	5-30
STANDARD SHEET	5-31
STANDARD SHEET	5-28
STANDARD SHEET	5-29

2 1/2" GRAVEL MIXED-III PLACE SURFACE COURSE

5B-II - BARRICADES, SIGNS, AND LIGHTS

5-28 PIPE CULVERTS

5-29 BOX CULVERTS

5-30 GUARD RAIL

5-31 BOUNDARY MARKERS

APPROVED BY THE CHIEF ENGINEER ON AUG. 15, 1933

ON JULY 25, 1934

ON JULY 14, 1933

FED. ROAD DIST. NO.	STATE	PROJ. NO.	YEAR	SHEET NO.	TOTAL SHEETS
9	VT.	79-C(1935)	1	29	

STATE OF VERMONT  
STATE HIGHWAY DEPARTMENT

PLAN AND PROFILE OF PROPOSED  
STATE HIGHWAY

TOWN OF WESTFIELD.....  
NEWPORT - LOWELL ROAD

FROM THE TROY-WESTFIELD TOWN LINE SOUTH-WESTERLY TO A POINT 1000 FT. SOUTH OF MILL BROOK BRIDGE  
LENGTH OF PROJECT 7392.5 FT. = 1.400 MILES

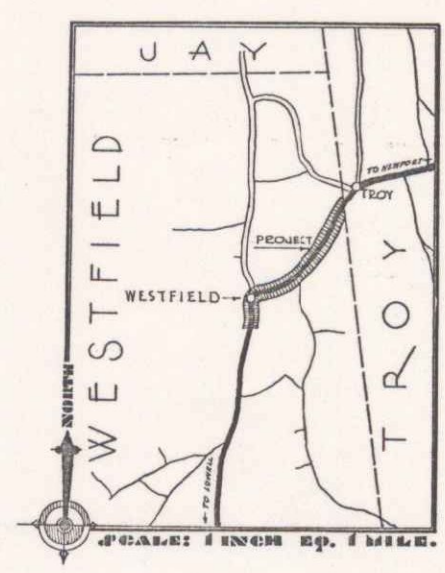

(To Be Returned to H.O.M. Division)

TOWN OF WESTFIELD

PERMISSAL

TOWN FILE

RIGHT-OF-WAY DIVISION

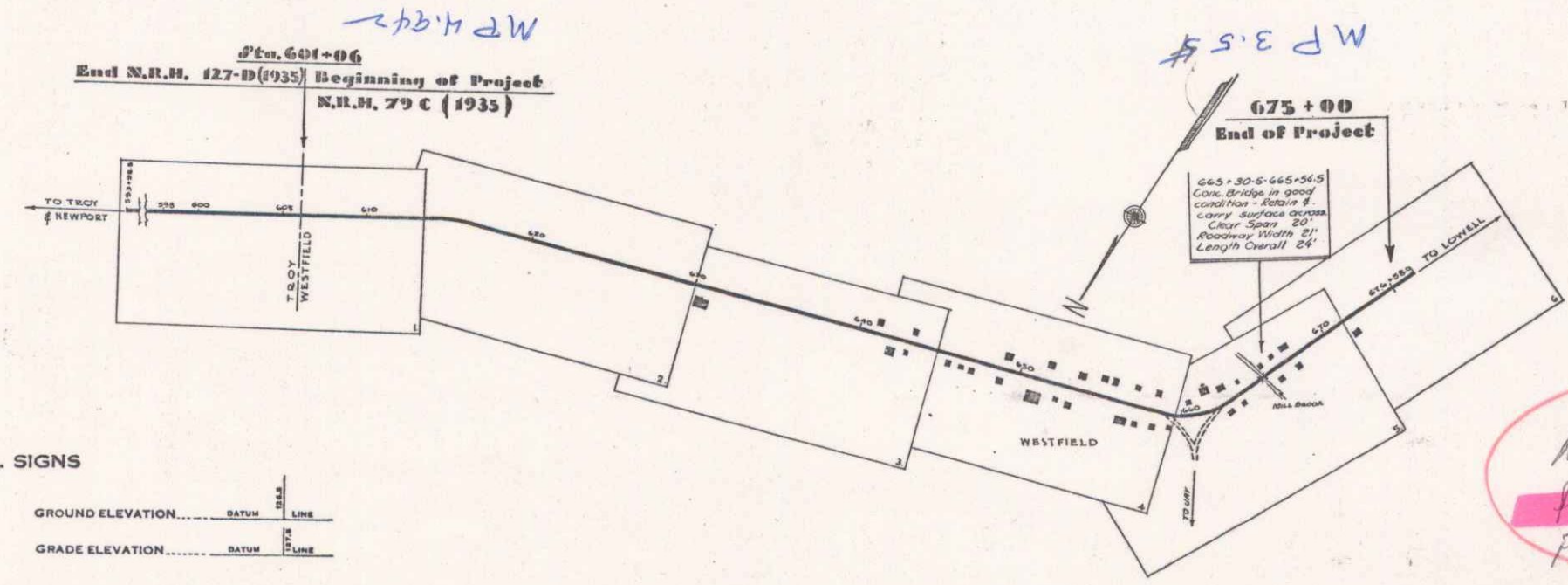

**CONVENTIONAL SIGNS**

COUNTY LINE	GROUND ELEVATION
TOWN LINE	GRADE ELEVATION
FENCE LINE	
STONE WALL	
UNFENCED PROPERTY	
GUARD RAIL	
TRAVELED WAY	
RAILROAD	
RETAINING WALL	
CENTER LINE	
SURVEY LINE	
CULVERT	
DROP INLET	
TROLLEY POLE	
POWER POLE	
TELEPHONE POLE	
TREES	
HEDGE	

**CURVE DATA**

DEFLECTION ANGLE	Δ
DEGREE OF CURVE	D
RADIUS OF CURVE	R
TANGENT DISTANCE	T
LENGTH OF CURVE	L
EXTERNAL DISTANCE	E
POINT OF INTERSECTION	P. I.
POINT OF CURVE	P. C.
POINT OF TANGENT	P. T.
POINT ON TANGENT	P. O. T.

**SCALE**

TITLE PAGE	1" = 500 FT.
PLANS	1" = 50 FT.
PROFILE	1" = 10 FT.
CROSS SECTIONS	1" = 5 FT.

**NOTE**

These plans are subject to such revisions as may be required by the Bureau of Public Roads and the Commissioner of Highways. Construction is to be carried on in accordance with the plans and standard road and bridge specifications of 1930 including all subsequent approved revisions, the National Recovery Act special provisions, and such revised specifications and special provisions as are submitted with the plans.

ROUTE: VT 100

PIN: 000644

PROJECT: NRH 79C(1935)

APPROVED: January 17, 1935

COMMISSIONER OF HIGHWAYS

SUBMITTED BY ORDER OF THE STATE HIGHWAY DEPARTMENT

RECOMMENDED

DISTRICT ENGINEER

BUREAU OF PUBLIC ROADS

RECOMMENDED FOR APPROVAL

CHIEF ENGINEER

APPROVED

DIRECTOR - BUREAU OF PUBLIC ROADS

CORRECT: JANUARY 17, 1935

Road Engineer

SERIES 4474 NO. 786

FILED

SHEET 1 OF 29

DIS. # 9 PLANS