

INDEX OF SHEETS

SHEET NO.	TITLE PAGE
1	TYPICAL CROSS-SECTION OF IMPROVEMENT
2	BANKING AND WIDENING TABLES
3	PLAN AND PROFILE
4	Standard Structure Sheet 5-28: Pipe Culverts
5	Standard Structure Sheet 5-31: Boundary Markers
6	Standard Structure Sheet 5-40: Barricades, Signs, and Lights
7	Standard Structure Sheet 5-41: Rounding of Slopes
8-14	Cross-sections

STANDARD STRUCTURE SHEETS  
APPROVED BY THE CHIEF ENGINEER.

5-28	JULY 11, 1933.
5-31	JULY 23, 1934.

(To Be Returned To R.O.M. Division)  
Town of Westfield  
PERMITAL  
TOWN FILE  
HIGHWAY DIVISION

STATE OF VERMONT  
STATE HIGHWAY DEPARTMENT

PLAN AND PROFILE OF PROPOSED  
STATE HIGHWAY

FEDERAL AID PROJECT

TOWN OF WESTFIELD

MORRISVILLE—NEWPORT ROAD

BEGINNING AT A POINT 2.076 MILES NORTHEASTERLY OF THE WESTFIELD-LOWELL  
TOWN LINE AND EXTENDING SOUTHWESTERLY 0.254 MILES ON ROUTE 100

LENGTH OF ROADWAY:  $\frac{1318.8}{1313.2}$  FT =  $\frac{0.249}{0.248}$  MI.  
LENGTH OF BRIDGE : 33.0 FT = 0.006 MI.  
LENGTH OF PROJECT :  $\frac{1346.2}{1351.8}$  FT =  $\frac{0.254}{0.256}$  MI.

FED. ROAD DIST. NO.	STATE	FED. AID PROJ. NO.	FISCAL YEAR	SHEET NO.	TOTAL SHEETS
9	Vt.	79A(2)	1941	1	14

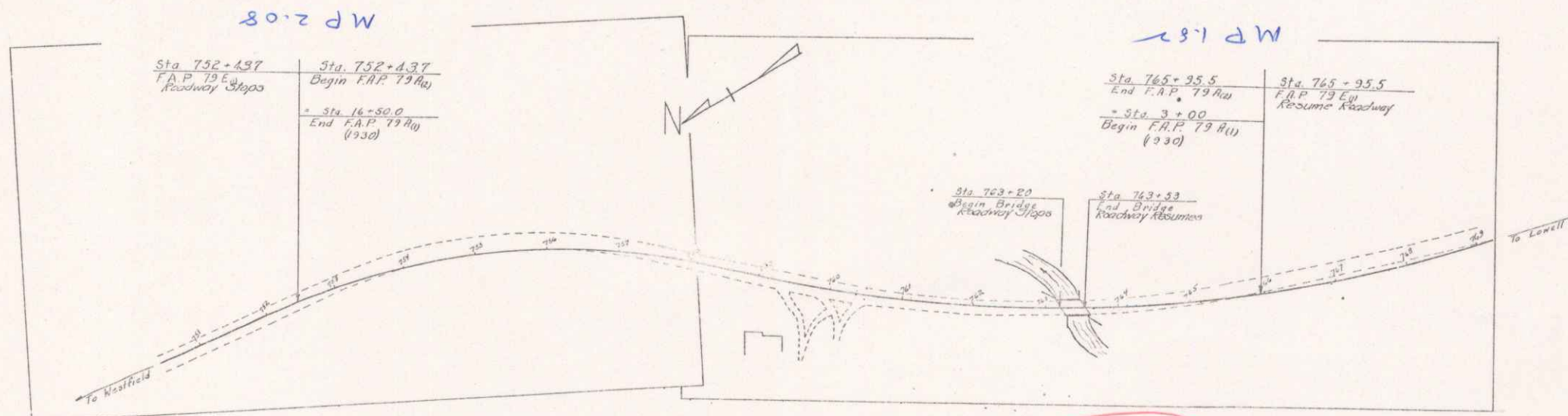
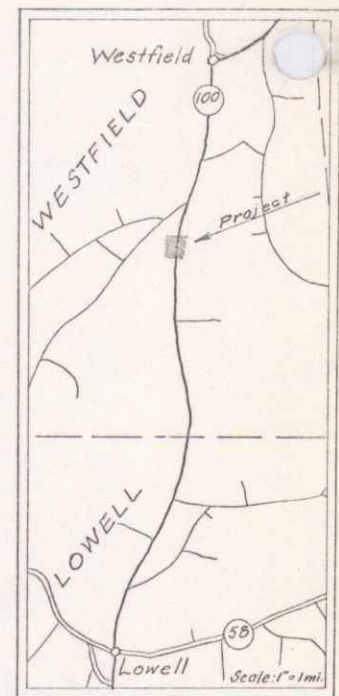

RECORD PLANS  
By - W.H. Chase

- COUNTY LINE
- TOWN LINE
- FENCE LINE
- STONE WALL
- UNFENCED PROPERTY
- GUARD RAIL
- TRAVELED WAY
- RAILROAD
- RETAINING WALL
- CENTER LINE
- SURVEY LINE
- CULVERT
- DROP INLET
- TROLLEY POLE
- POWER POLE
- TELEPHONE POLE
- TREE
- HEDGE

Received Plans  
Westfield F.A.P. 79A(2)  
County Engineer - L. H. Chase  
1941

GROUND ELEVATION	DATUM	LINE
DATE		
GRADE ELEVATION	DATUM	LINE
DATE		

CURVE DATA	
DEFLECTION ANGLE	Δ
DEGREE OF CURVE	D
RADIUS OF CURVE	R
TANGENT DISTANCE	T
LENGTH OF CURVE	L
EXTERNAL DISTANCE	E
POINT OF INTERSECTION	P. I.
POINT OF CURVE	P. C.
POINT OF TANGENT	P. T.
POINT ON TANGENT	P. O. T.

SCALES	
TITLE	1" = 100'
TYPICAL	1" = 5'
PLAN	1" = 50'
PROFILE	1" = 10'
CROSS SECTIONS	1" = 5'

Project: F.A.P. 79A(2)  
Date: 10/19/1942  
Route: VT 100  
AD: 000642

THESE PLANS ARE SUBJECT TO SUCH REVISIONS AS MAY BE REQUIRED BY THE PUBLIC ROADS ADMINISTRATION OR THE COMMISSIONER OF HIGHWAYS.

CONSTRUCTION IS TO BE CARRIED ON IN ACCORDANCE WITH THE PLANS AND THE STANDARD ROAD AND BRIDGE SPECIFICATIONS OF 1934, AS APPROVED DECEMBER 29TH, 1936 BY THE PUBLIC ROADS ADMINISTRATION, INCLUDING ALL SUBSEQUENT APPROVED REVISIONS AND SUCH REVISED SPECIFICATIONS AND SPECIAL PROVISIONS AS ARE SUBMITTED WITH THE PLANS.

APPROVED: [Signature]	APPROVED: [Signature]	SERIES F No. 79A(2) FILED
ROAD ENGINEER	DISTRICT HIGHWAY COMMISSIONER	SHEET 1 OF 14

DIST. #9 PLANS  
1