

INDEX OF SHEETS

SHEET NO. 1	TITLE PAGE
" 2	TYPICAL CROSS-SECTION OF IMPROVEMENT
" 3	BANKING AND WIDENING TABLES
" 4	PLAN AND PROFILE STA
" 5	Standard Structure Sheet S-31: Boundary Markers
" 6	Standard Structure Sheet S-40: Barricades, Signs, and Lights
" 7	Standard Structure Sheet S-41: Rounding of Cut Slopes
" 8-9	Cross-sections

Standard Structure Sheets Approved
by the Chief Engineer

5-28	July 11, 1933
5-30	Aug 13, 1934
5-31	July 25, 1934

(To Be Returned To R.O.W. Division)
 Form of Vt 100
 PERMIT
 TOWN FILE
 RIGHT-OF-WAY DIVISION

STATE OF VERMONT
STATE HIGHWAY DEPARTMENT

PLAN AND PROFILE OF PROPOSED
STATE HIGHWAY

FEDERAL AID PROJECT

TOWN OF WESTFIELD

MORRISVILLE--NEWPORT ROAD

BEGINNING AT A POINT 900.5 FEET NORTHEASTERLY OF THE WESTFIELD-
LOWELL TOWN LINE AND EXTENDING 0.132 MILES ON ROUTE 100

LENGTH OF PROJECT: 601.0 FEET = 0.113 MILES

FED. ROAD DIST. NO.	STATE	FED. AID PROJ. NO.	FISCAL YEAR	SHEET NO.	TOTAL SHEETS
9	Vt.	79 B(2)	1941	1	9

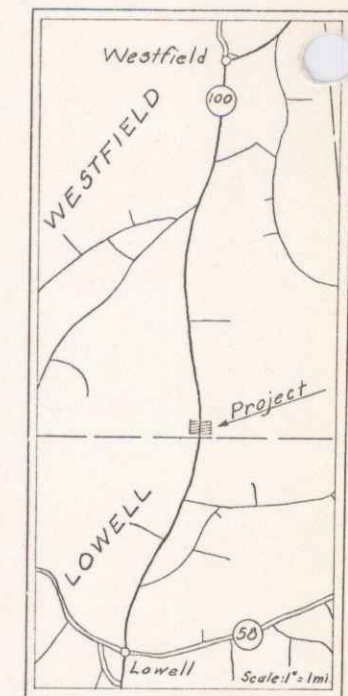

ROUTE VT 100
 PROJECT: FAP 79 B(2)
 DATE: 10/14/1940
 PIN: 002641

RECORD PLANS

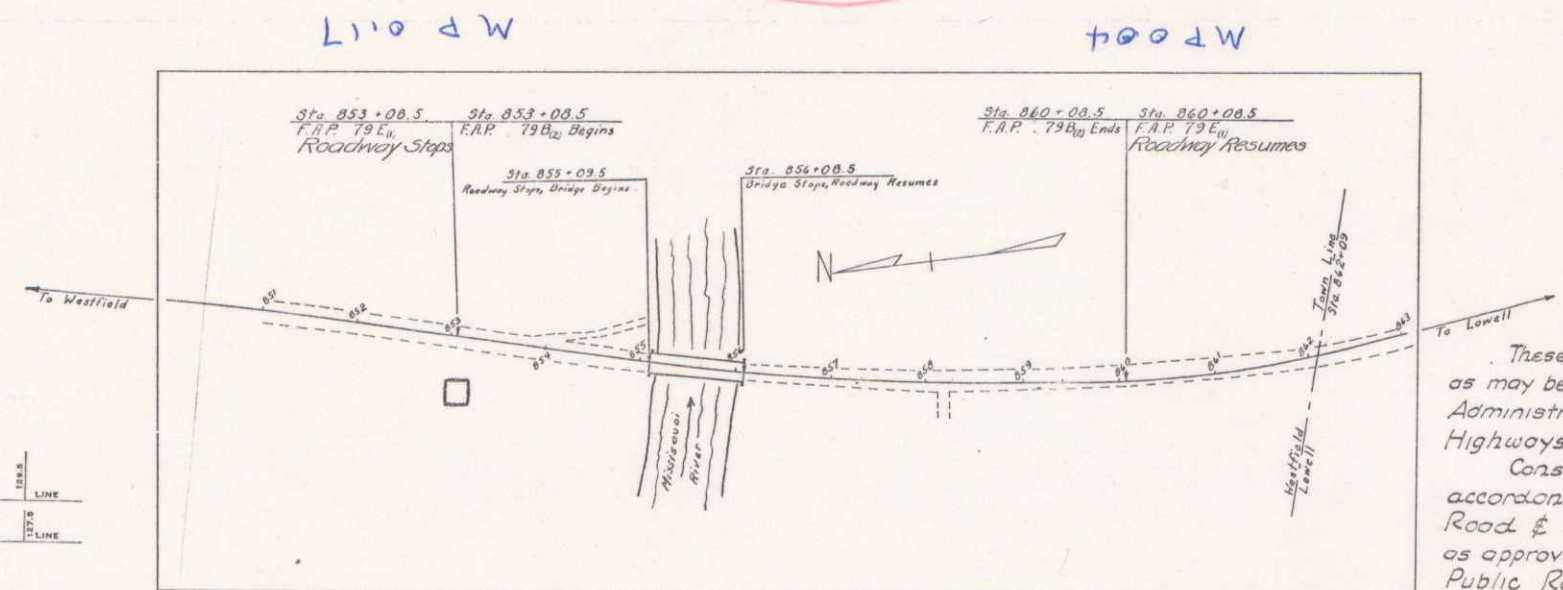

CONVENTIONAL SIGNS

COUNTY LINE	-----	GROUND ELEVATION	DATUM	LINE
TOWN LINE	-----	GRADE ELEVATION	DATUM	LINE
FENCE LINE	-----			
STONE WALL	-----			
UNFENCED PROPERTY	-----			
GUARD RAIL	-----			
TRAVELED WAY	-----			
RAILROAD	-----			
RETAINING WALL	-----			
CENTER LINE	-----			
SURVEY LINE	-----			
CULVERT	-----			
DROP INLET	-----			
TROLLEY POLE	-----			
POWER POLE	-----			
TELEPHONE POLE	-----			
TREES	-----			
HEDGE	-----			

CURVE DATA

DEFLECTION ANGLE	Δ
DEGREE OF CURVE	D
RADIUS OF CURVE	R
TANGENT DISTANCE	T
LENGTH OF CURVE	L
EXTERNAL DISTANCE	E
POINT OF INTERSECTION	P. I.
POINT OF CURVE	P. C.
POINT OF TANGENT	P. T.
POINT ON TANGENT	P. O. T.

SCALES

Title: 1" = 100'

Plan: Horiz.

Profile: Vert.

Cross-sections: 1" = 5'

APPROVED: *[Signature]*
COMMISSIONER OF HIGHWAYS
SUBMITTED BY ORDER OF THE STATE HIGHWAY BOARD

These plans are subject to such revisions as may be required by the Public Roads Administration or the Commissioner of Highways.

Construction is to be carried on in accordance with the plans and the Standard Road & Bridge Specifications of 1936, as approved December 29th, 1936, by the Public Roads Administration, including all subsequent approved revisions and such revised specifications and special provisions as are submitted with the plans.

Approved: <i>[Signature]</i> 1940 ROAD ENGINEER	Approved: <i>[Signature]</i> 1940 DISTRICT HIGHWAY COMMISSIONER	SERIES FAP NO. 79-B(2) FILED SHEET 1 OF 9
--	--	--