

INDEX OF SHEETS

SHEET NO. 1	TITLE PAGE
2	TYPICAL CROSS-SECTION OF IMPROVEMENT (Grading, Drainage, Base, Guard Rail, with Double Tack Coat of Refined Tar (item 29))
3	BANKING AND WIDENING TABLES
4-13	PLAN AND PROFILE
14	DETAIL SHEET 10' X 10' REINF. CONC. BOX STA. 219+37.5
15	STANDARD STRUCTURE SHEET S-28 PIPE CULVERTS
16	" " " " S-30 GUARD RAIL
17	" " " " S-30-A F.A. MARKERS
18	" " " " S-40 BARRICADES, SIGNS & LIGHTS
19	" " " " S-41 ROUNDING OF SLOPES
20-54	CROSS SECTIONS

STANDARD STRUCTURE SHEETS
APPROVED BY THE CHIEF ENGINEER

S-28 JULY 11, 1933
S-30 AUGUST 15, 1934

FED. ROAD DIST. NO.	STATE	FED. AID PROJ. NO.	FISCAL YEAR	SHEET NO.	TOTAL SHEETS
9	Vt.	237A(1)	1	54	

STATE OF VERMONT
STATE HIGHWAY DEPARTMENT

PLAN AND PROFILE OF PROPOSED
STATE HIGHWAY
FEDERAL AID PROJECT
TOWN OF HYDE PARK
HYDE PARK—NEWPORT ROAD

RECORD PLANS
By
E. H. Spaulding 3/9/42

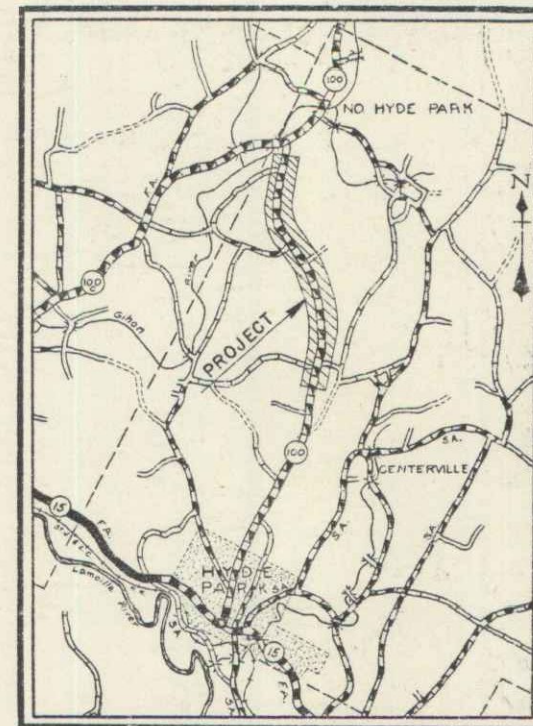

Scale: 1/16" = 1 mi.

BEGINNING AT A POINT ON ROUTE 100, 2.94 MILES NORTHERLY FROM THE INTERSECTION OF ROUTES 15 & 100 IN HYDE PARK VILLAGE AND EXTENDING NORTHERLY 2.445 MILES TO A POINT 250 FEET SOUTH OF THE INTERSECTION OF ROUTES 100 & 100-C.
LENGTH OF PROJECT 12911.2 FEET = 2.445 MILES.

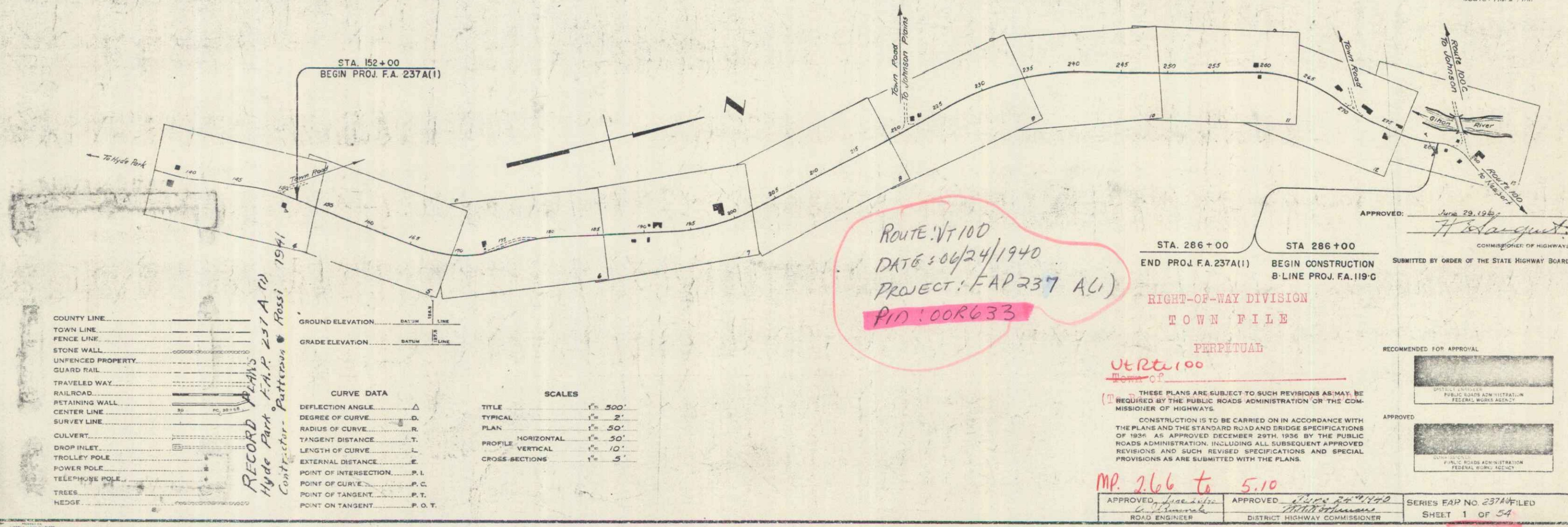

COUNTY LINE	---
TOWN LINE	---
FENCE LINE	---
STONE WALL	---
UNFENCED PROPERTY	---
GUARD RAIL	---
TRAVELED WAY	---
RAILROAD	---
RETAINING WALL	---
CENTER LINE	---
SURVEY LINE	---
CULVERT	---
DROP INLET	---
TROLLEY POLE	---
POWER POLE	---
TELEPHONE POLE	---
TREES	---
HEDGE	---

CURVE DATA	
DEFLECTION ANGLE	Δ
DEGREE OF CURVE	D
RADIUS OF CURVE	R
TANGENT DISTANCE	T
LENGTH OF CURVE	L
EXTERNAL DISTANCE	E
POINT OF INTERSECTION	P. I.
POINT OF CURVE	P. C.
POINT OF TANGENT	P. T.
POINT ON TANGENT	P. O. T.

SCALES	
TITLE	1" = 500'
TYPICAL	1" = 2'
PLAN	1" = 50'
PROFILE HORIZONTAL	1" = 50'
PROFILE VERTICAL	1" = 10'
CROSS-SECTIONS	1" = 5'

ROUTE VT 100
DATE 3/06/24/1940
PROJECT: FAP 237 ALI
PID: 00R633

APPROVED: June 29, 1942
H. H. Spaulding
COMMISSIONER OF HIGHWAYS
SUBMITTED BY ORDER OF THE STATE HIGHWAY BOARD

STA. 286+00
END PROJ. F.A. 237A(1)
RIGHT-OF-WAY DIVISION
TOWN FILE
PERPETUAL

UT 237A(1)
M-100-C
THESE PLANS ARE SUBJECT TO SUCH REVISIONS AS MAY BE REQUIRED BY THE PUBLIC ROADS ADMINISTRATION OR THE COMMISSIONER OF HIGHWAYS.
CONSTRUCTION IS TO BE CARRIED ON IN ACCORDANCE WITH THE PLANS AND THE STANDARD ROAD AND BRIDGE SPECIFICATIONS OF 1934 AS APPROVED DECEMBER 29TH, 1936 BY THE PUBLIC ROADS ADMINISTRATION, INCLUDING ALL SUBSEQUENT APPROVED REVISIONS AND SUCH REVISED SPECIFICATIONS AND SPECIAL PROVISIONS AS ARE SUBMITTED WITH THE PLANS.

MP. 266 to 5.10
APPROVED: [Signature] ROAD ENGINEER
APPROVED: [Signature] DISTRICT HIGHWAY COMMISSIONER
SERIES FAP NO. 237A(1) FILED
SHEET 1 OF 54

RECORD PLANS
Hyde Park F.A.P. 237A(1)
Contractor - Patterson & Foss 1941