

PROJECT: Duxbury  
 DRAWN BY: A. Duggan  
 DATE: 11/89  
 TITLE: (vertical)  
 SHEET: C.E.H. 11/89

PROJECT: Duxbury  
 DRAWN BY: A. Duggan  
 DATE: 11/89  
 TITLE: (vertical)  
 SHEET: C.E.H. 11/89

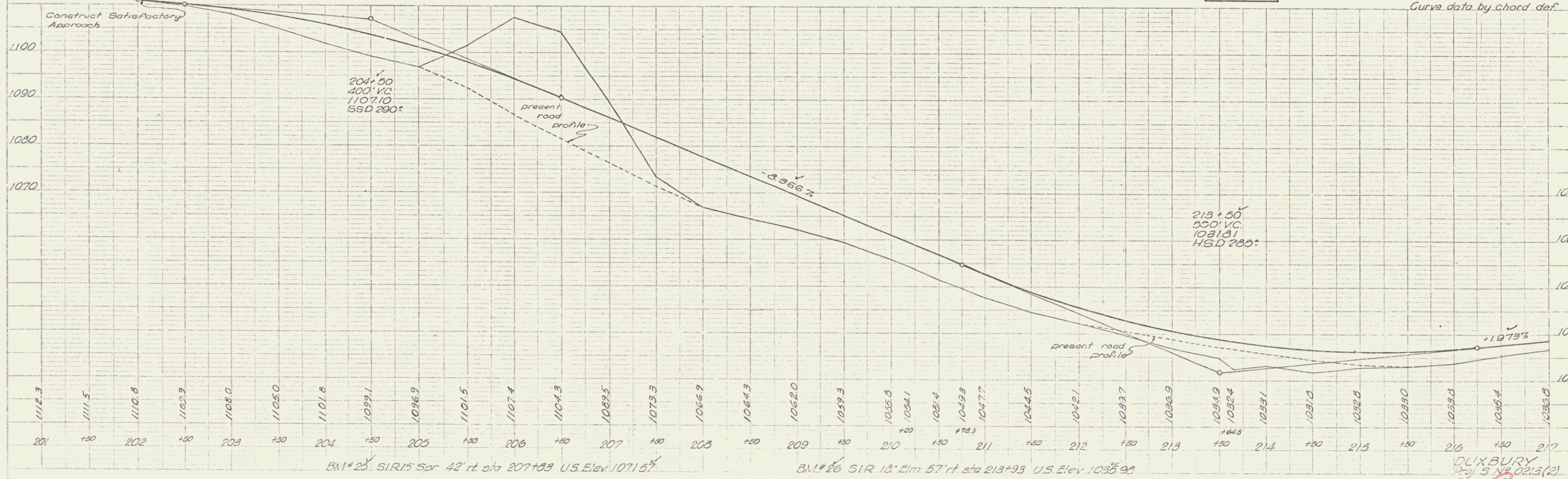
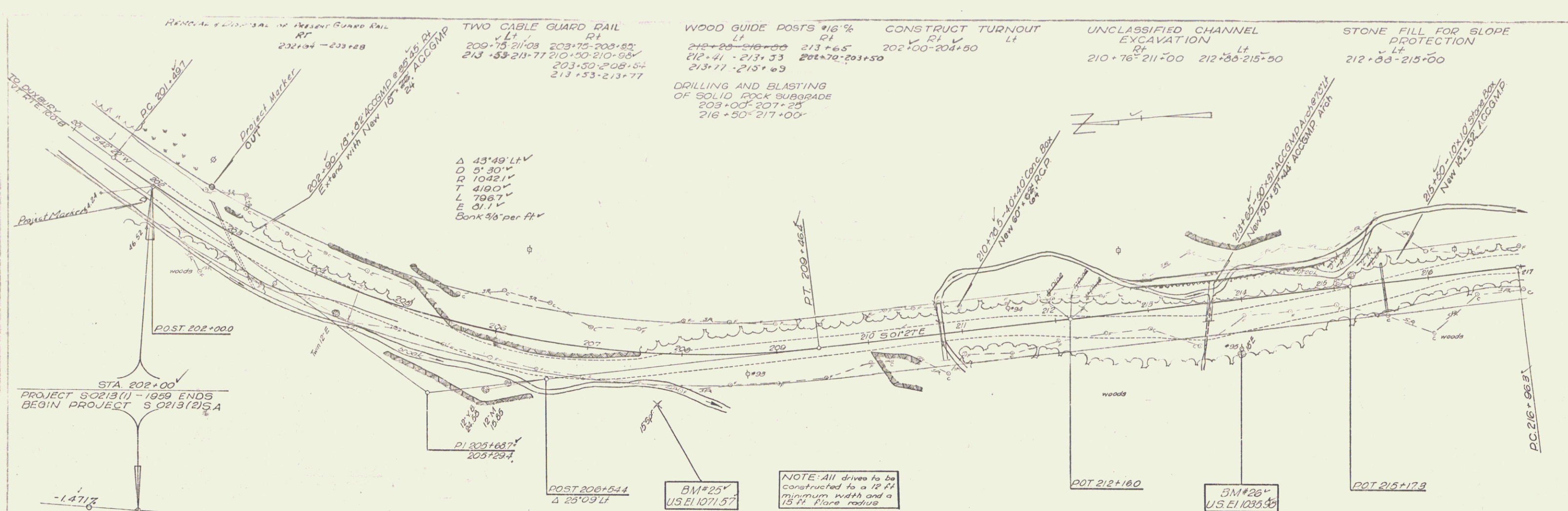

REMOVE EXISTING 4" WOODEN GUARD RAIL  
 RT 202+00 - 203+00  
 TWO CABLE GUARD RAIL  
 LT 203+00 - 203+50  
 RT 203+50 - 204+00  
 LT 204+00 - 204+50  
 RT 204+50 - 205+00  
 LT 205+00 - 205+50  
 RT 205+50 - 206+00  
 LT 206+00 - 206+50  
 RT 206+50 - 207+00  
 LT 207+00 - 207+50  
 RT 207+50 - 208+00  
 LT 208+00 - 208+50  
 RT 208+50 - 209+00  
 LT 209+00 - 209+50  
 RT 209+50 - 210+00  
 LT 210+00 - 210+50  
 RT 210+50 - 211+00  
 LT 211+00 - 211+50  
 RT 211+50 - 212+00  
 LT 212+00 - 212+50  
 RT 212+50 - 213+00  
 LT 213+00 - 213+50  
 RT 213+50 - 214+00  
 LT 214+00 - 214+50  
 RT 214+50 - 215+00  
 LT 215+00 - 215+50  
 RT 215+50 - 216+00  
 LT 216+00 - 216+50  
 RT 216+50 - 217+00  
 UNCLASSIFIED CHANNEL EXCAVATION  
 LT 210+76 - 211+00  
 RT 212+38 - 215+50  
 STONE FILL FOR SLOPE PROTECTION  
 LT 212+38 - 215+00

$\Delta$  43°49' Lt V  
 D 5' 30" V  
 T 1042.1 V  
 L 419.0 V  
 E 0.1 V  
 Bank 4/8" per ft V

DRILLING AND BLASTING  
 OF SOLID ROCK SUBGRADE  
 203+00 - 207+00  
 216+50 - 217+00

NOTE: All drives to be  
 constructed to a 12 ft  
 minimum width and a  
 15 ft. flare radius

DUXBURY  
 Proj. 9 No. 0213(2)  
 Sheet 7 of 56