

CABLE GUED RAIL	RT.	LT.	ANCHORS
18+74 - 19+06	RT.	32'	1
18+82 - 19+14	LT.	32'	1
19+31 - 20+31	RT.	40'	1
19+37 - 20+21	LT.	26'	1
TOTALS ROWY.	72'	56'	4
TOTALS BRIDGE	83'	85'	

STA 17+00
BEGIN STATE PROJECT 157-N
INDEX OF SHEETS
1-2 PLAN & PROFILE SHEETS
3 ABUTMENT DETAILS
4 SUPERSTRUCTURE DETAILS
5 S.B.-SC - CURB & RAIL
6 S-30 - CABLE GUED RAIL
7 S.B-20 - DETAILS C.E.L.L. & GEN. NOTES
8 S-11 - SIGNS, LIGHTS & BARRICADES
9-14 SECTIONS.

TYPE	BRIDGE DATA	
	PRESENT	PROPOSED
OVERALL SPAN	45.7'	84'
ROADWAY WIDTH	15'	24'
CLEAR HEIGHT	4.8' AN	8'
WATERWAY	41.1'±	38.7'±
ABUTMENTS	DRY STONE - POOR	STUB ON PILES
FLOOR	2-LAYERS 3" PLANK	CONCRETE

Pin: 208625
Route: VT 100
Date: 01/01/1939

APPROVED: *January 1, 1938*
DISTRICT HIGHWAY ENGINEER
CORRECT: *A.D. Bishop*
BRIDGE ENGINEER
APPROVED: *May 4, 1938*
COMMISSIONER OF HIGHWAYS

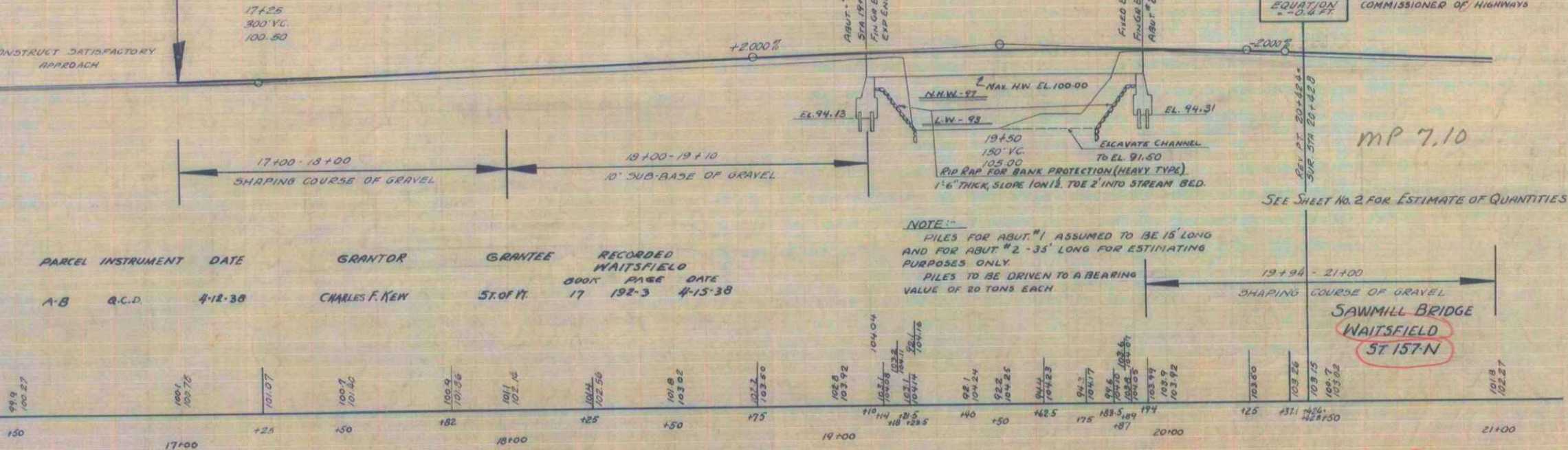
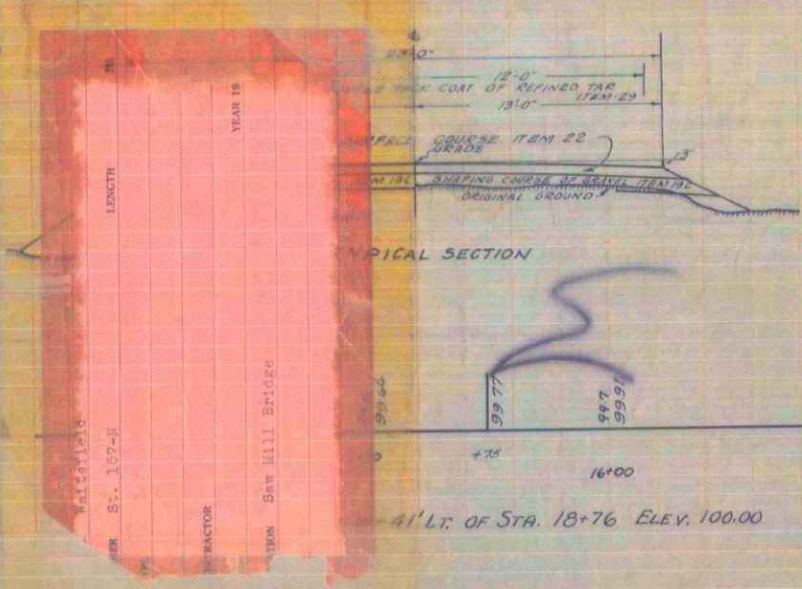
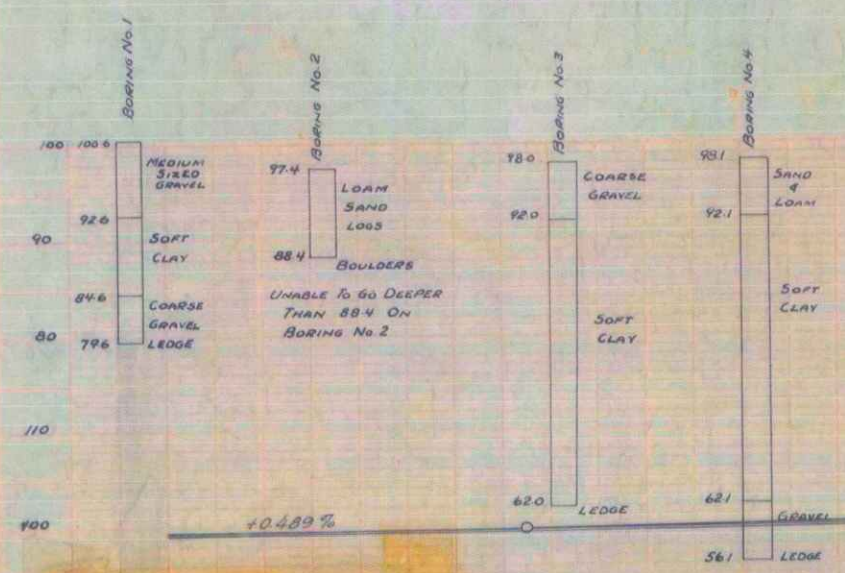

PARCEL INSTRUMENT	DATE	GRANTOR	GRANTEE	RECORDED	WAITSFIELD	BOOK	PAGE	DATE
A-B	Q.C.D.	4-12-30	CHARLES F. NEW	ST. OF VT.	17	192-3	4-15-38	

NOTE: PILES FOR ABUT. #1 ASSUMED TO BE 15' LONG AND FOR ABUT. #2 - 35' LONG FOR ESTIMATING PURPOSES ONLY. PILES TO BE DRIVEN TO A BEARING VALUE OF 20 TONS EACH.

SEE SHEET NO. 2 FOR ESTIMATE OF QUANTITIES

SAWMILL BRIDGE
WAITSFIELD
ST 157-N

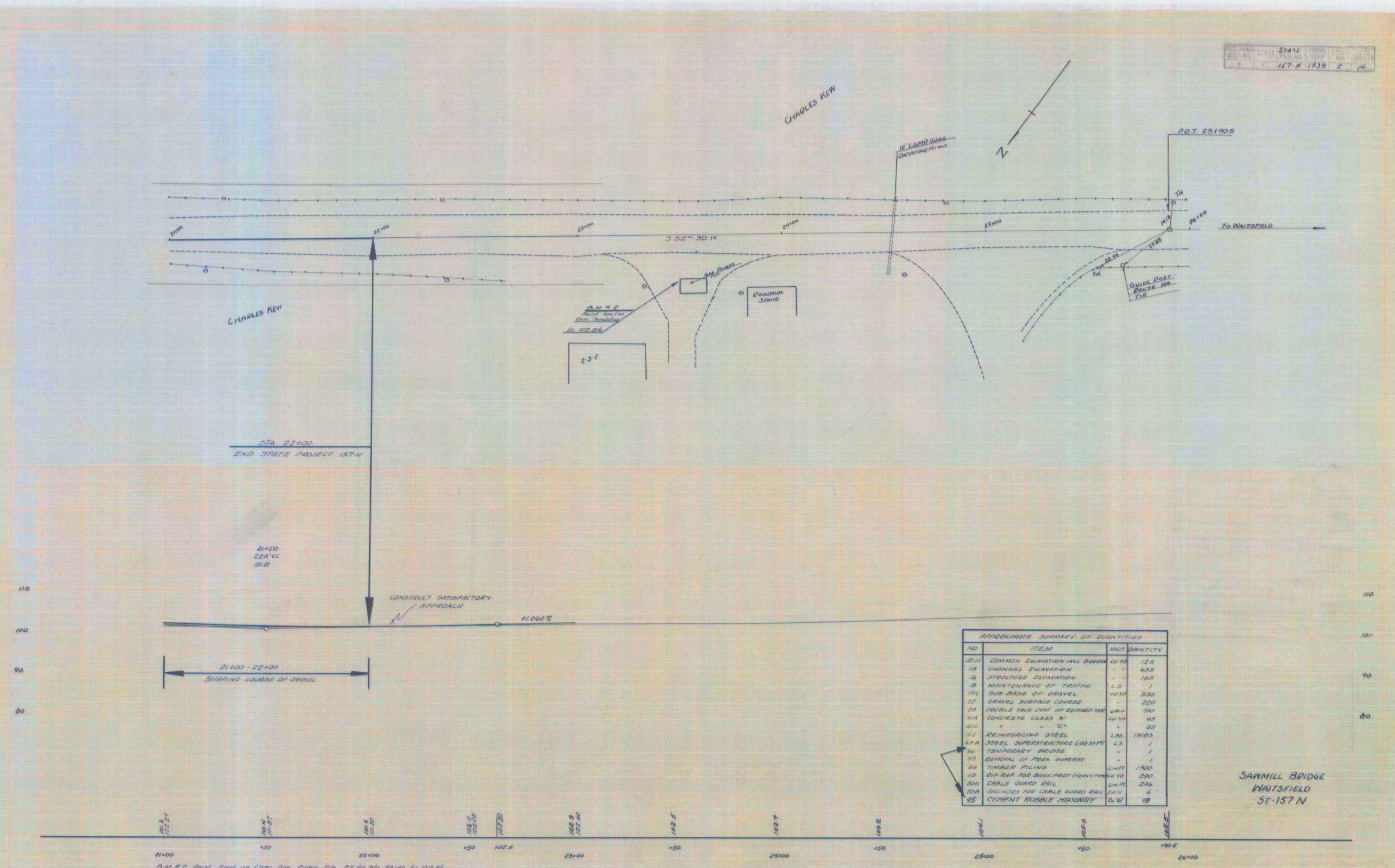

APPROXIMATE SUMMARY OF QUANTITIES

NO	ITEM	UNIT	QUANTITY
10-11	COMMON EXCAVATION INC. OPEN	CU YD	12.5
12	CHANNEL EXCAVATION	" "	63.8
13	STRUCTURE EXCAVATION	" "	18.5
14	MAINTENANCE OF TOPPING	L.S.	1
15	3/4" BASE OF GRAVEL	CU YD	350
16	GRAVEL SURFACE COURSE	" "	220
17	DOUBLE THICK COAT OF REINFORCED	CU YD	750
18	CONCRETE CLASS 3"	CU YD	65
19	" "	" "	85
20	REINFORCING STEEL	LB.	17103
21	STEEL SUPERSTRUCTURE (ASBPM)	L.S.	1
22	TEMPORARY BRIDGE	" "	1
23	REMOVAL OF PILES SURFACE	" "	1
24	TIMBER PILING	LINEAL	1200
25	PILE CAP FOR BULK HEAD (CONCRETE)	CU YD	230
26	CABLE GUARD RAIL	LINEAL	200
27	ENCLOSURE FOR CABLE GUARD RAIL	CU YD	6
28	CEMENT RUBBLE MASONRY	CU YD	10

SAWMILL BRIDGE
 WAITSFIELD
 57-157 N

D.M. #2 Avail Spot on Conc. Dam Pump Feb. 22 21-36 23-60 21-102-56