

INDEX OF SHEETS

- NO. 1 TITLE PAGE
- 2 TYPICAL CROSS-SECTION OF IMPROVEMENT
- 3 BANKING AND WIDENING TABLES
- 4 QUANTITY SHEET (ITEMS)
- 5 QUANTITY SHEET (DRAINAGE)
- 6-10 EARTHWORK SHEETS
- 11-26 PLAN AND PROFILE SHEETS
- 27 CONSTRUCTION DETAILS (DRAINAGE & MARKERS)
- 28 CONSTRUCTION DETAILS CD 1 (DITCHES)
- 29 CONSTRUCTION DETAILS CD 2 (TYPICAL GRADING)
- 30 CONSTRUCTION DETAILS CD 4 (GRANITE CURB)
- 31 STANDARD STRUCTURE SHEET S 40 (BARRICADES, SIGNS & LIGHTS)
- 32 STANDARD STRUCTURE SHEET S 45-46 (PLANK GUARD RAIL)
- 33 STANDARD STRUCTURE SHEET S 48-46 (THREE CABLE GUARD RAIL)
- 34 STANDARD STRUCTURE SHEET S 53-48 (R.C.P. DROP INLET)
- 35 DEAD END ANCHORAGE AT BRIDGE APPROACH
- 36 DETAILS OF ABUTMENT NO. 1
- 37 DETAILS OF ABUTMENT NO. 2
- 38 DETAILS OF PIER NO. 1
- 39 DETAILS OF PIER NO. 2
- 40 DETAILS OF SUPERSTRUCTURE
- 41 REINFORCING STEEL SCHEDULE
- 42 BORING NOTES
- 43-47 CHANNEL SECTIONS
- 48 STANDARD STRUCTURE SHEET S 18 30 (H-20H BRIDGE)
- 49 STANDARD STRUCTURE SHEET S 8 20 BRIDGE DETAILS
- 50 STANDARD STRUCTURE SHEET S 8 51 BRIDGE RAILING
- 51 STANDARD STRUCTURE SHEET S 8 11 (BARRICADES, SIGNS & LIGHTS)
- 52 PLAN OF 10' X 10' RCB
- 53 REINFORCING STEEL SCHEDULE
- 54 RETAINING WALL EXTENSION
- 55 DETAILS OF WING NO. 1 AND 2
- 56 DETAILS OF WING NO. 3 AND 4
- 57 BARREL EXPANSION JOINT DETAIL
- 58-61 CHANNEL SECTIONS
- 62 DETAILS OF ABUTMENT NO. 1
- 63 DETAILS OF ABUTMENT NO. 2
- 64 DETAILS OF SUPERSTRUCTURE
- 65 REINFORCING STEEL SCHEDULE
- 66 BORING DATA
- 67-71 CHANNEL SECTIONS
- 72-135 CROSS SECTIONS

STANDARD STRUCTURE SHEET APPROVED BY THE CHIEF ENGINEER
VERMONT STATE DEPARTMENT OF HIGHWAYS.

S 40 JUNE 10, 1950

MP 3.220

STATE OF VERMONT
STATE HIGHWAY DEPARTMENT

PLAN AND PROFILE OF PROPOSED
STATE HIGHWAY

SECONDARY PROJECT

TOWN OF WARREN

COUNTY OF WASHINGTON

GRANVILLE WOODS-WAITSFIELD ROAD

VERMONT ROUTE 100

BEGINNING AT A POINT APPROXIMATELY 16,516.6 FEET SOUTHWESTERLY OF THE
WAITSFIELD-WARREN TOWN LINE AND EXTENDING NORTHEASTERLY 14,173.6 FEET

LENGTH OF ROADWAY 13,952.6 FT. = 2.642 MILES

LENGTH OF BRIDGES 221.0 FT. = 0.042 MILE

LENGTH OF PROJECT 14,173.6 FT. = 2.684 MILES

U.S.G.S. MAP REFERENCE
LINCOLN MOUNTAIN QUADRANGLE
W 72° 52' N 44° 07'
SCALE 1" = 1 MILE

DATE: 12/18/1952
PROJECT: S 157(6)
PIN: 100R620

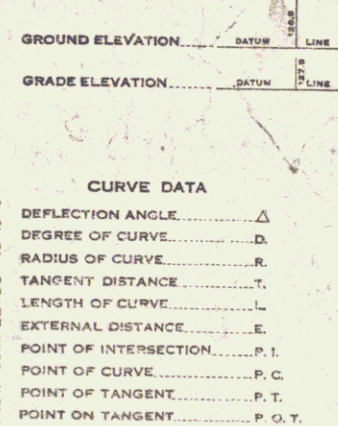
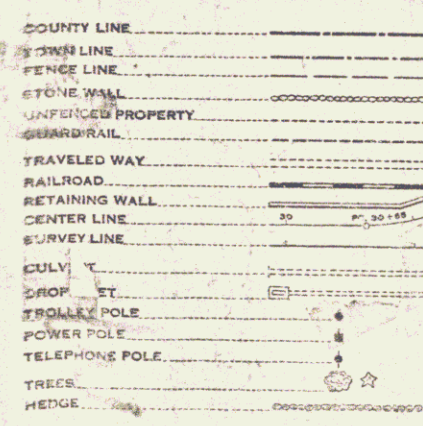
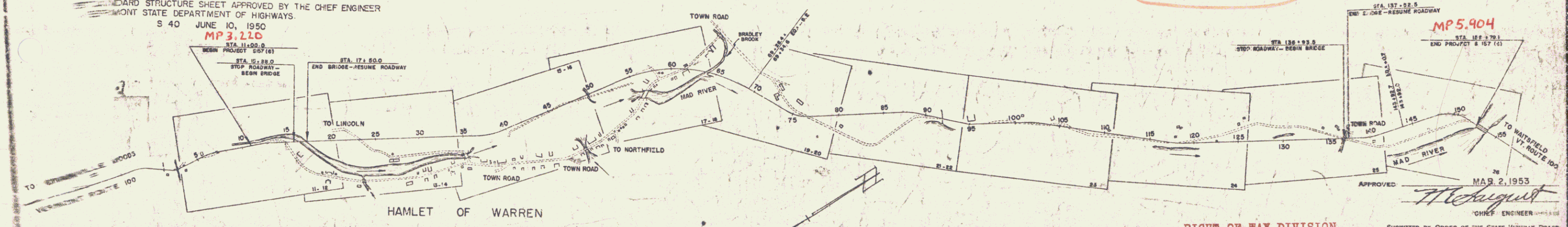
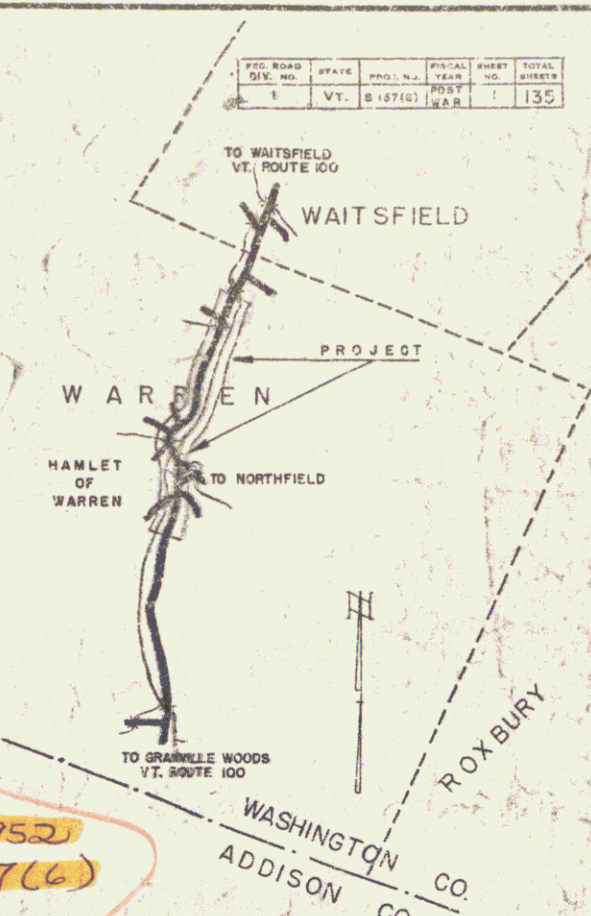

SCALES

TITLE	1" = 500'
TYPICAL	1" = 2'
PLAN	1" = 50'
PROFILE HORIZONTAL	1" = 5'
PROFILE VERTICAL	1" = 10'
CROSS SECTIONS	1" = 5'

PROJECT NAME & NUMBER	WARREN S 157 (6)	TYPE	MIP SURF. CRSE	PAVEMENT AREA	33049 S.Y.
RECORD PLANS					
MATERIALS					
SUB-BASE OF GRAVEL	BROOKS PIT WARREN	REINF. STEEL	VT. STRUCT. STEEL CO., BURLINGTON		
	KING'S GRAVEL BAR, WAITSFIELD	RCP	VT. CONG. PIPE CORP., WINDSOR		
CR. GRAVEL	BASS CORP. PLANT, WAITSFIELD	ACCOMP	NEW ENG. MET. CULV. CO., BOSTON, MASS.		
STRUCT. STEEL	BETHLEHEM ST. CO., BETHLEHEM, PA.	CABLE FOR G.R.	AM. ST. & WIRE CO., NEW HAVEN, CONN.		
CUTBACK ASPHALT	SOC. VACUUM, E. PROV. R.I.	GUARD RAIL PAINT	FRANKLIN PAINT CO., FRANKLIN, MASS. & BRADLEY LABS., BRATTLEBORO		
CEMENT	LOVE STAR PORT. CEM. CO., HUDSON, N.Y.				
CONTRACTOR	LAMBERT CONST. CO. INC.	CONTRACT DATED	MAY 1, 1953		
RESIDENT ENGR.	A. GRAHAM	CONTRACT STARTED	MAY 11, 1953		
INSPECTORS	L. LAVIN	CONTRACT COMPLETED	OCTOBER 19, 1954		
RECORD PLANS	L. LAVIN	CONTRACT ACCEPTED	OCTOBER 19, 1954		

RIGHT-OF-WAY DIVISION
TOWN FILE
PERPETUAL
Town of Ut Rte 100 MA 3.22 - 5.90
(To Be Returned To P.O.W. Division)

THESE PLANS ARE SUBJECT TO SUCH REVISIONS AS MAY BE REQUIRED BY THE BUREAU OF PUBLIC ROADS OR THE COMMISSIONER OF HIGHWAYS.
CONSTRUCTION IS TO BE CARRIED ON IN ACCORDANCE WITH THE PLANS AND THE STANDARD ROAD AND BRIDGE SPECIFICATIONS OF 1948, AS APPROVED JULY 25, 1949 BY THE BUREAU OF PUBLIC ROADS INCLUDING ALL SUBSEQUENT APPROVED REVISIONS AND SUCH REVISED SPECIFICATIONS AND SPECIAL PROVISIONS AS ARE SUBMITTED WITH THE PLANS.

APPROVED	APPROVED	APPROVED	APPROVED	PROJECT S No. 157(6) FILED
CONSTRUCTION ENGINEER	SECONDARY ENGINEER	BRIDGE ENGINEER	HIGHWAY ENGINEER	SHEET 1 OF 135

APPROVED
MAR 2, 1953
CHIEF ENGINEER
SUBMITTED BY ORDER OF THE STATE HIGHWAY BOARD