

Warren Dam Jobs

| PARCEL INSTRUMENT DATE | GRANTOR        | GRANTEE | RECORDED      | REMARKS |
|------------------------|----------------|---------|---------------|---------|
| A W.D.O.E. 8-7-42      | EFFIE LAMORDER | WARREN  | 20 363 912-42 | BARN    |

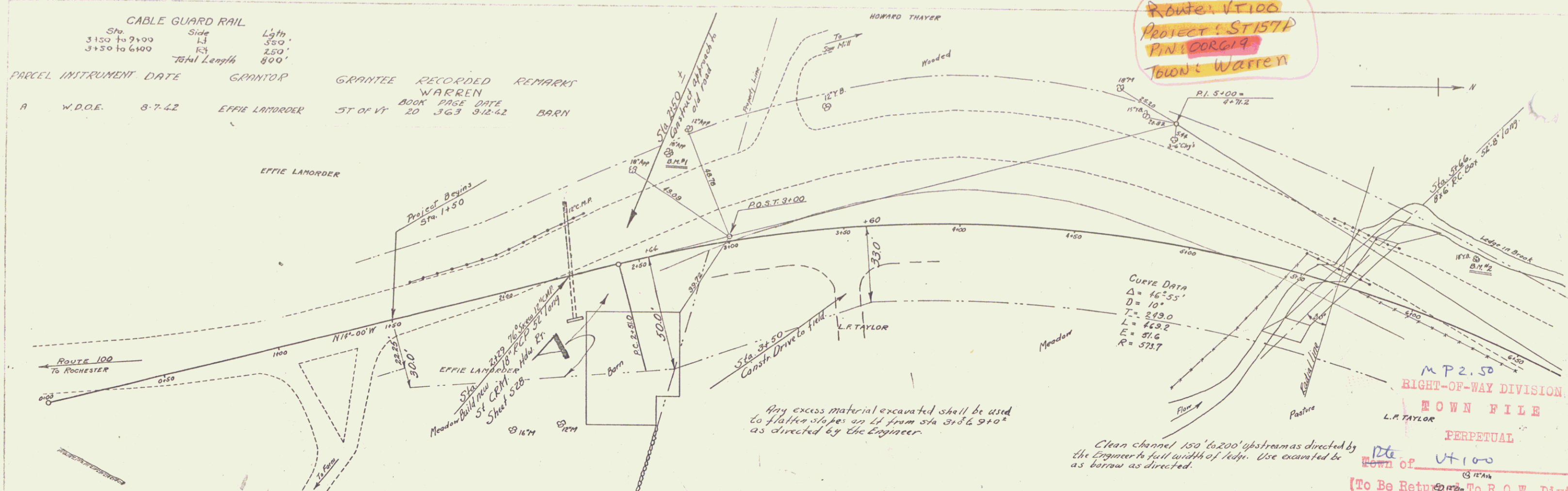

Route VT 100  
 Project ST 157A  
 PIN COOR 19  
 Town Warren

Curve Data  
 $\Delta = 46^{\circ}55'$   
 $D = 10'$   
 $T = 249.0$   
 $L = 443.2$   
 $E = 51.6$   
 $R = 573.7$

MP 2.50  
 RIGHT-OF-WAY DIVISION  
 TOWN FILE  
 L.R. TAYLOR  
 PERPETUAL

Clean channel 150' to 200' upstream as directed by the Engineer to full width of bed. Use excavated as borrow as directed.

(To Be Returned To R.O.W. Division)

|              | PRESENT    | PROPOSED    |
|--------------|------------|-------------|
| OVERALL SPAN | 8.0'       | 9.5'        |
| CLEAR SPAN   | 4.0'       | 6.0'        |
| CLEAR HEIGHT | 2.00'      | 24.0'       |
| ROADWAY      | 32.0'      | 48.0'       |
| WATERWAY     | 32.0'      | 48.0'       |
| TYPE         | CONC. PILE | 316' RC BOX |

|                                  |          |
|----------------------------------|----------|
| 174.001 Concrete for Box         | 55.17 CY |
| 15 Channel Excavation            | 36.5 CY  |
| 16 Structure Excavation          | 12.5 CY  |
| 100 Sub-base of Gravel           | 98.0 CY  |
| 22 Gravel Surface Course         | 48.0 CY  |
| 418 Concrete Class #1            | 68 CY    |
| 42 Reinforcing Steel             | 9050 Lbs |
| 688 Riprap for Base Part         | 50 CY    |
| 522 18" LGMPAC                   | 40 LF    |
| 100 Temp Brk & Maint of Traffic  | 1 LS     |
| 37 Removal of Present Bridge     | 1 LS     |
| 804 Cable Guard Rail             | 80 LF    |
| 803 Anchors for Cable Guard Rail | 4 EA     |
| 424 12" Reinforced Concrete Pipe | 52 LF    |

\* Reinforcing steel furnished by STATE or contractor. All other materials hauling from State Highway garage on Curve Road to job site and placement in structure.

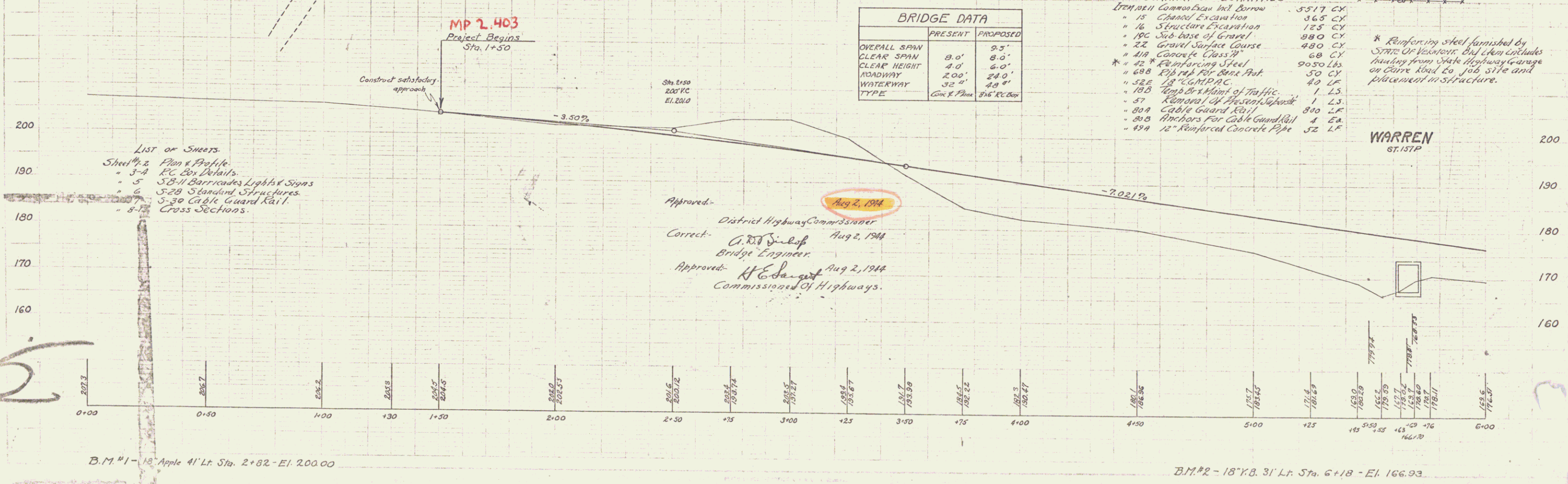

- List of Sheets
- Sheet #2 Plan & Profile
  - 3-4 RC Box Details
  - 5 SB-11 Barricades Lights & Signs
  - 6 SB-29 Standard Structures
  - 7-30 Cable Guard Rail
  - 8-7 Cross Sections

Approved: *[Signature]* Aug 2, 1944  
 District Highway Commissioner

Correct: *[Signature]* Aug 2, 1944  
 Bridge Engineer

Approved: *[Signature]* Aug 2, 1944  
 Commissioner of Highways

B.M. #1 - 18' Apple 41' Lt. Sta. 2+82 - El. 200.00

B.M. #2 - 18' Y.B. 31' Lt. Sta. 6+18 - El. 166.93

Sheet of 2 sheets