

INDEX OF SHEETS

- SHEET NO 1 TITLE PAGE
- 2 TYPICAL CROSS-SECTION OF IMPROVEMENT DOUBLE TRACK COAST OF REFINED TAR WITH PEA-STONE SEAL, ITEM 512-A MOD
- 3 BANKING AND WIDENING TABLES
- 4 QUANTITY SHEET (ITEMS) (DRAINAGE)
- 5-7 EARTHWORK SHEETS
- 8 CONSTRUCTION DETAILS CO (DRAINAGE AND MARKERS)
- 9 CONSTRUCTION DETAILS CO-1 (DITCHES)
- 10 STANDARD STRUCTURE SHEET S-40 (BARRICADES, SIGNS AND LIGHTS)
- 11 STANDARD STRUCTURE SHEET S-45-45 (TWO CABLE GUARD RAIL)
- 12 STANDARD STRUCTURE SHEET S-53-48 (PRECAST REINF. CONC PIPE D.I.)
- 13-21 PLAN AND PROFILE SHEETS
- 22 DETAILS OF NEW POSTS AND U.S. HEADWALL STA. 193+39
- 23 REINFORCING STEEL SCHEDULE
- 24-47 CROSS SECTIONS

STANDARD STRUCTURE SHEET APPROVED BY THE CHIEF ENGINEER, VERMONT STATE DEPARTMENT OF HIGHWAY. ...

5-40 JUNE 10, 1950

PROJECT NAME & NUMBER	TYPE	PAVEMENT AREA
LONDONDERRY-WESTON ST 242 L	DBL. TRACK COAST	24924 S.Y.
RECORD PLANS		
MATERIALS		
SUB-BASE OF GRAVEL WOODCOCK PIT, WESTON FOSTER PIT, WESTON	REINF. STEEL ALBANY STEEL & IRON SUPPLY CO. ALBANY, N. Y.	
REFINED TAR OLD COLONY TAR CO. CANON, MASS. WARREN T. TINS CO. WILMINGTON, MASS.	R.C.P. VT. CONC. PIPE CORP., WINDSOR WESTMINSTER, STA.	
PEASTONE SEAL DAILEY PL. SO. SHAFTSBURY	A.C.C.G.M.P. BERGER METAL CULVERT CO. WESTMINSTER, STA.	
CEMENT ATLAS PORT. CEM. CO., HUDSON, N. Y.	G.R. CABLE AM. STEEL & WIRE CO., NEW HAVEN, CONN. BERGER METAL CULVERT CO. WESTMINSTER, STA.	
CONC. AGGREGATES DAILEY PL. SO. SHAFTSBURY	6" UNDERDRAIN	
CONTRACTOR WM. E. DAILEY	CONTRACT DATED JUNE 22, 1954	
RESIDENT ENG'R. WALTER HENRY	CONTRACT STARTED JULY 12, 1954	
INSPECTORS	CONTRACT COMPLETED JULY 30, 1955	
RECORD PLANS G. A. A.	CONTRACT ACCEPTED JULY 30, 1955	

STATE OF VERMONT  
DEPARTMENT OF HIGHWAYS

PROPOSED IMPROVEMENT

STATE PROJECT  
TOWNS OF **LONDONDERRY-WESTON**  
COUNTIES OF WINDHAM-WINDSOR  
VERMONT ROUTE 8  
LONDONDERRY-WESTON ROAD

BEGINNING AT A POINT 2,072.0 FEET SOUTH OF THE LONDONDERRY-WESTON TOWN LINE AND EXTENDING NORTHERLY 11,277 FEET. (EXCLUDING BRIDGE)

LENGTH OF PROJECT 11,215.7 FEET = 2.124 MILES

FED. ROAD DIST. NO.	STATE PROJECT NO.	YEAR	SHEET NO.	TOTAL SHEETS
1	VT 242(L) W&S	1	47	

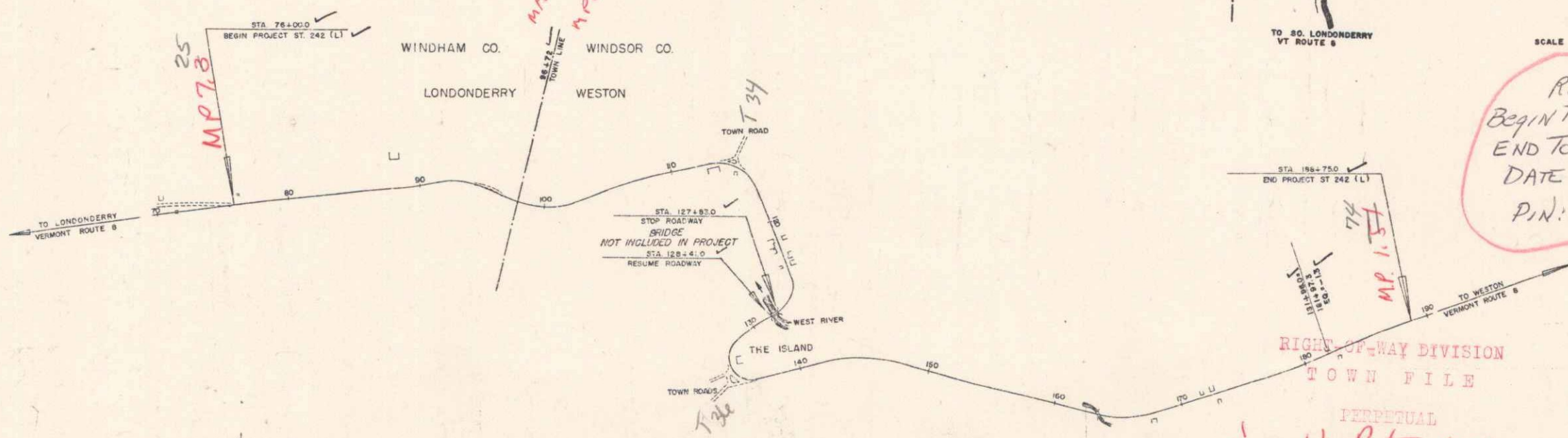
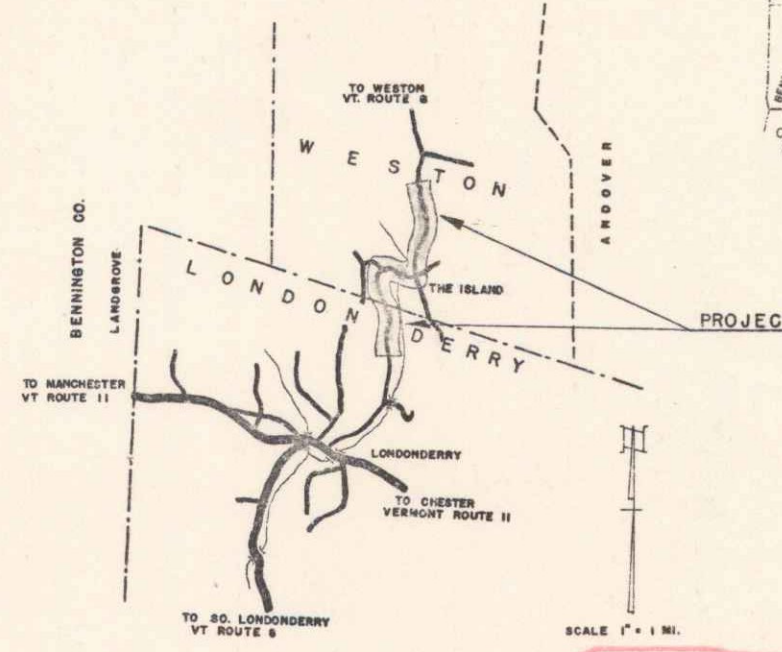
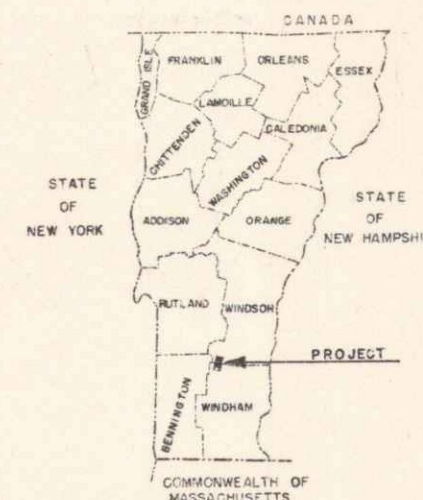

ROUTE: VT100  
BEGIN TOWN: LONDONDERRY  
END TOWN: WESTON  
DATE: 03/23/1954  
P.I.N.: 008608

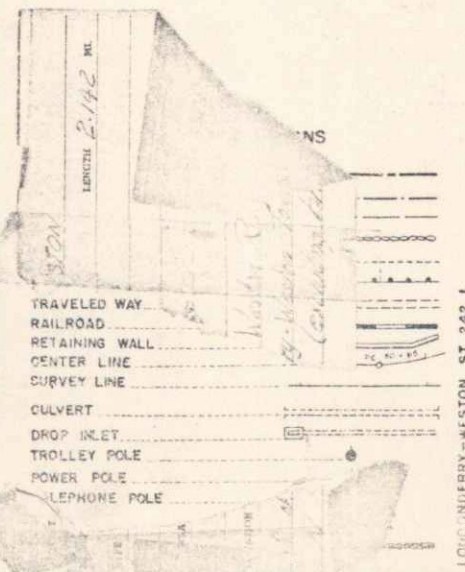

GROUND ELEVATION	DATUM	LINE
GRADE ELEVATION	DATUM	LINE

Londonderry  
Weston  
MP 7.8 to 7.65  
MP 0.0 to 1.54

APPROVED	DATE	APPROVED	DATE	APPROVED	DATE	APPROVED	DATE
CONSTRUCTION ENGINEER	6/11/50	SENIOR ENGINEER	6/11/50	DESIGN ENGINEER	6/11/50	DISTRICT ENGINEER	6/11/50

NOTE: ANY FURTHER INFORMATION CONCERNING FINAL QUANTITIES, ADJUSTS OR OTHER DETAILS RELATIVE TO THIS PROJECT MAY BE FOUND IN EITHER THE FIELD BOOKS OR THE ESTIMATE FILE.

DEPARTMENT OF COMMERCE  
BUREAU OF PUBLIC ROADS

APPROVED: \_\_\_\_\_  
DISTRICT ENGINEER

PROJECT ST. NO. 242 (L)

SHEET 1 OF 47 SHEETS