

INDEX OF SHEETS

1	TITLE SHEET
2	TYPICAL CROSS SECTION OF IMPROVEMENT (18" BIT. CONC. PAVT., ITEM 361-C, MOD. SPECIAL ONE COURSE MIX)
3	QUANTITY SHEET (ITEM AND DRAINAGE)
4	EARTHWORK SHEET
5-7	PLAN AND PROFILE SHEETS
8	PR #4 - GENERAL PLAN AND ELEVATION
9	PR #5 - SUPERSTRUCTURE DETAILS
10	PR #6 - ABUTMENT #1 DETAILS
11	PR #7 - ABUTMENT #2 DETAILS
12	PR #8 - REINFORCING SCHEDULE
13	PR #9 - CHANNEL SECTIONS
14	STANDARD SHEET B-1 (RANKING TABLES)
15	STANDARD SHEET B-5 (TYPICAL SLOPE GRADING)
16	STANDARD SHEET D-2 (CRM HEADWALLS)
17	STANDARD SHEET E-2 (BARRICADES, SIGN AND LIGHTS - FOR BRIDGES)
18	STANDARD SHEET E-9 (FEDERAL AID - CONSTRUCTION IDENTIFICATION SIGNS)
19	STANDARD SHEET G-3 (THREE CABLE GUARD RAIL)
20	STANDARD SHEET G-4 (MARKER AND GUIDE POSTS)
21	STANDARD SHEET J-1 (PROJECT MARKERS, BOUNDARY MARKERS)
22	STANDARD SHEET SB - 20-60 (WF BEAM BRIDGES)
23-26	CROSS SECTION SHEETS
4A	FINAL EARTHWORK SHEET 2 CULVERT SHEETS 4 LEDGE, STRUCTURE, ETC. SHEETS BENCH MARKS BASED ON ASSUMED ELEVATIONS

**STATE OF VERMONT
DEPARTMENT OF HIGHWAYS
PROPOSED IMPROVEMENT**

**TOWN OF WHITINGHAM
COUNTY OF WINDHAM
VERMONT ROUTE # 8
JACKSONVILLE - READSBORO ROAD**

FEDERAL AID SECONDARY PROJECT
BEGINNING AT A POINT APPROXIMATELY 4.35 MILES
EASTERLY OF THE READSBORO-WHITINGHAM TOWN
LINE AND EXTENDING WESTERLY 0.076 MILES.

LENGTH OF ROADWAY 378.0 FEET 0.072 MILES
LENGTH OF BRIDGE 22.0 FEET 0.004 MILES
LENGTH OF PROJECT 400.0 FEET 0.076 MILES

1960 ADT	500
1980 ADT	700
1980 DHV	130
V	40 MPH
D	60 %
T	7 %

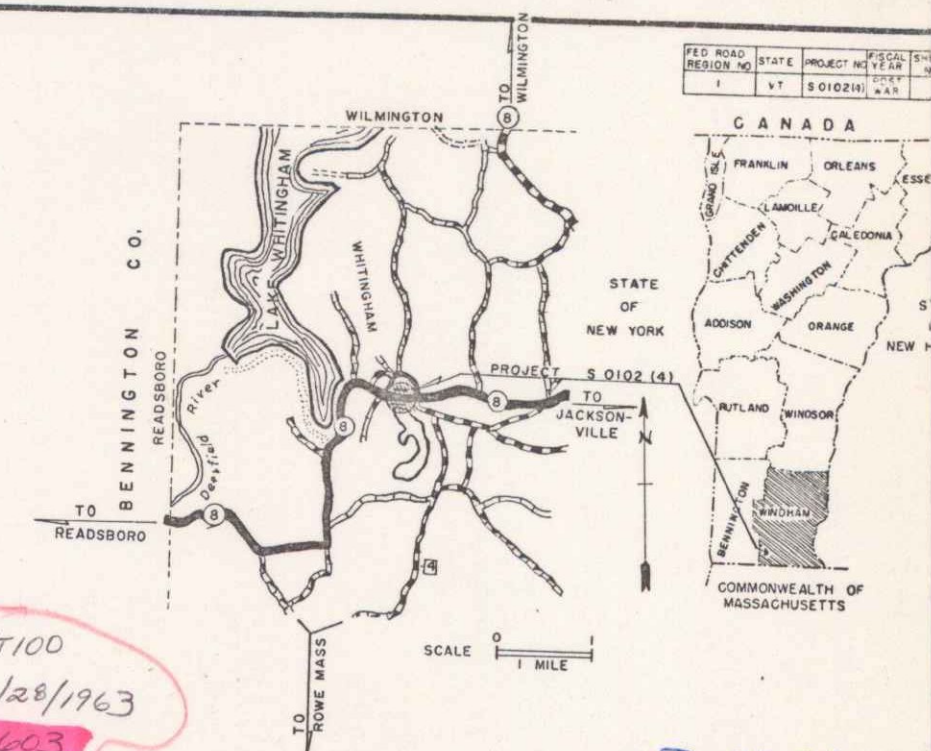

*Route: VT100
DATE: 06/28/1963
PIN: 00R663
PROJECT: S0102(4)*

*B-#31
MP 4.30
RIGHT-OF-WAY DIVISION
TOWN FILE
PERPETUAL
Town of VT100*

**PROJECT NAME & NUMBER TYPE PAVEMENT AREA
WHITINGHAM (S 0102(4)) BIT. CONC. PAVT. 1,004 S. Y.
RECORD PLANS
MATERIALS**

SUBBASE OF GRAVEL-LA SHORE PIT - STAMFORD, VT.
CUTBACK ASPHALT - MOBIL OIL CO. - ALBANY, N. Y.
BITUMINOUS CONCRETE, CONCRETE CLASS "B" & SAND - W.E. DAILEY (PLANT) -
SO. SHAFTSBURY, VT.
TAR EMULSION - TRIRAM CORP. - FRAMINGHAM, MASS.
REINF. CONC. PIPE - MARTIN MARIETTA CO. - WINDSOR, VT.
ASPH. CTD. CORR. GALV. METAL PIPE - NORTHEASTERN CULVERT CORP. -
WESTMINSTER, VT.
THREE CABLE GUARD RAIL & STEEL MARKER POSTS - S.T. GRISWOLD & CO.
INC. - ESSEX JUNCTION, VT.
REINFORCING STEEL - REPUBLIC STEEL CORP. - YOUNGSTOWN, OHIO.
STRUCTURAL STEEL - VERMONT STRUCTURAL STEEL CORP. - BURLINGTON, VT.
CONTRACTOR - W.M. MORSE CONST. CO., INC. CONTRACT: DATED - AUGUST 26,
BENNINGTON, VT. STARTED - AUGUST 26,
RES. ENG. - JOSHUA DAVIS & J.W. STEARNS. COMPLETED - JULY 1, 1964
RECORD PLANS - JAMES W. STEARNS. ACCEPTED - JULY 1, 1964

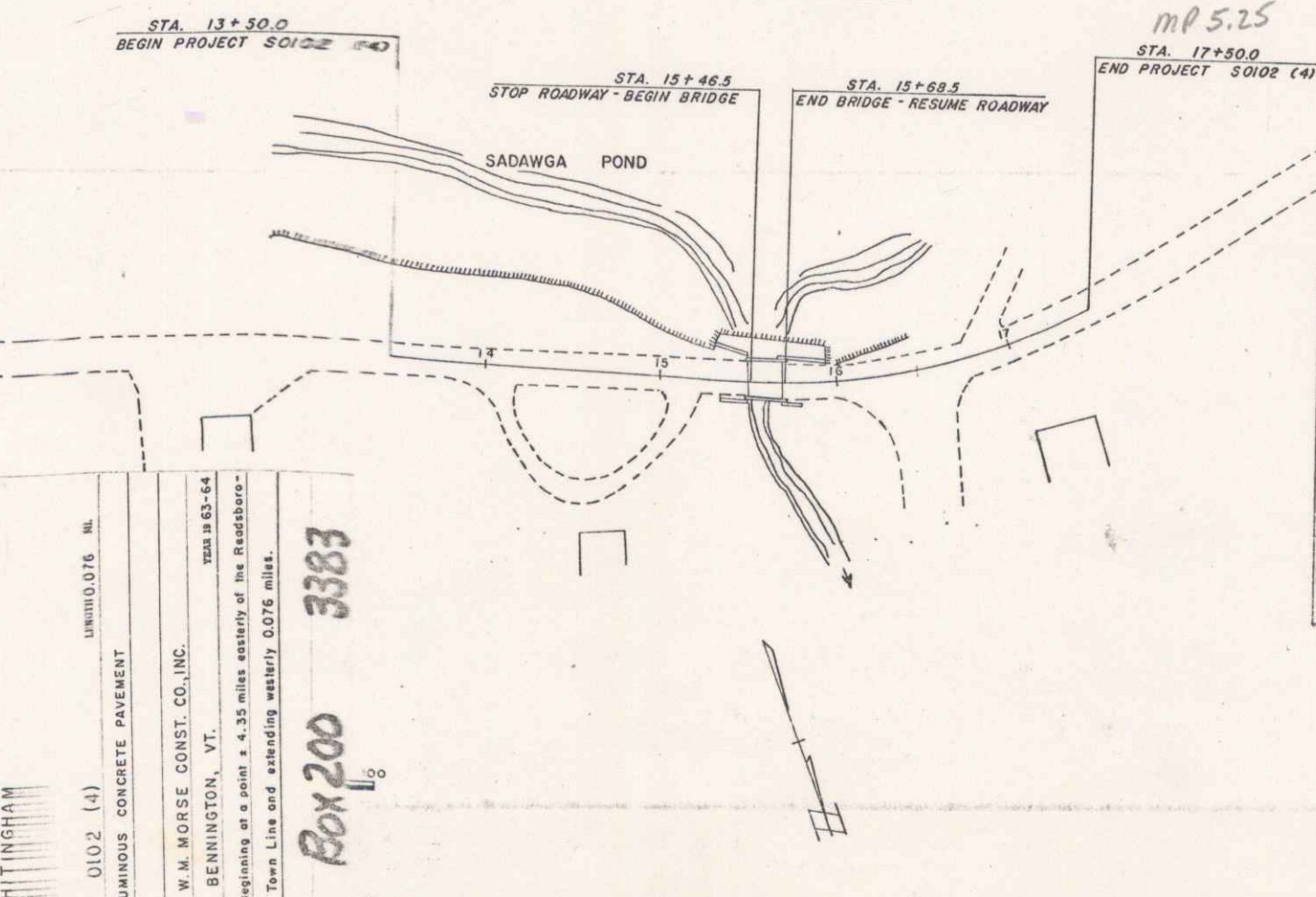
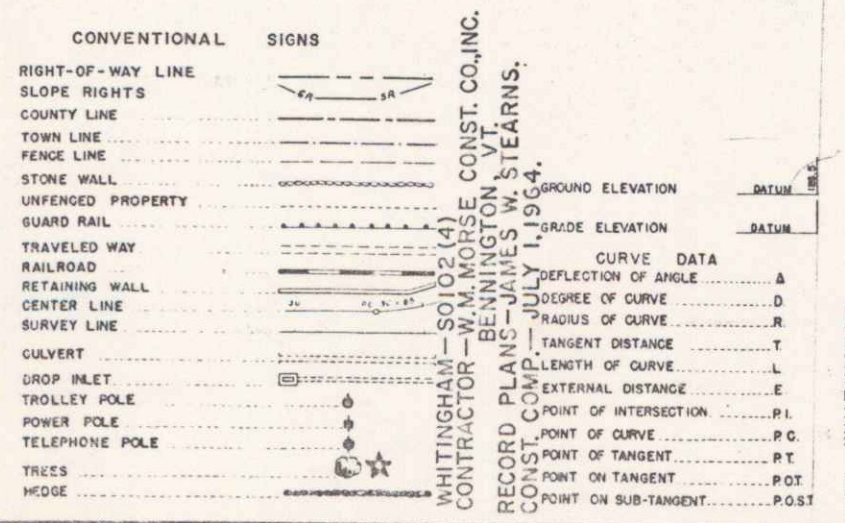

WHITINGHAM - S0102(4)
CONTRACTOR - W.M. MORSE CONST. CO., INC.
RECORD PLANS - JAMES W. STEARNS.
JULY 1, 1964

WHITINGHAM
PROJECT
TOWN S 0102 (4)
TYPE BITUMINOUS CONCRETE PAVEMENT
CONTRACTOR W. M. MORSE CONST. CO., INC.
BENNINGTON, VT.
Location Beginning at a point 4.35 miles easterly of the Readsboro-Whitingham Town Line and extending westerly 0.076 miles.

Box 200 3383

THESE PLANS ARE SUBJECT TO SUCH REVISIONS AS MAY BE
REQUIRED BY THE BUREAU OF PUBLIC ROADS OR THE COMMISSIONER
OF HIGHWAYS.

CONSTRUCTION IS TO BE CARRIED ON IN ACCORDANCE WITH
THE PLANS AND THE STANDARD SPECIFICATIONS FOR HIGHWAY AND BRIDGE
CONSTRUCTION OF JANUARY 1956 SUBMITTED TO THE BUREAU OF
PUBLIC ROADS AS APPROVED JULY 5, 1956, INCLUDING ALL SUBSEQUENT
APPROVED REVISIONS AND SUCH REVISED SPECIFICATIONS AND SPECIAL
PROVISIONS AS ARE SUBMITTED WITH THE PLANS.

DEPARTMENT OF COMMERCE
BUREAU OF PUBLIC ROADS

APPROVED _____
DIVISION ENGINEER

PROJECT S NO. 0102 (4)

SHEET 1 OF 26 SHEETS

APPROVED _____ DATE 4/26/63
APPROVED E. W. Stearns DATE 6/27/63
APPROVED _____ DATE 6/26/63
APPROVED _____ DATE 6/26/63
APPROVED G. M. P. DATE 6/27/63
APPROVED _____ DATE 6/28/63

PLAN
 PROJECT: WHITINGHAM
 SHEET: 5 OF 26
 DATE: 10/10/00
 DRAWN BY: M. J. [unclear]
 CHECKED BY: [unclear]

PROFILE
 PROJECT: WHITINGHAM
 SHEET: 5 OF 26
 DATE: 10/10/00
 DRAWN BY: M. J. [unclear]
 CHECKED BY: [unclear]

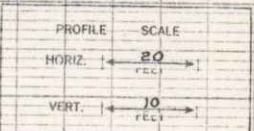
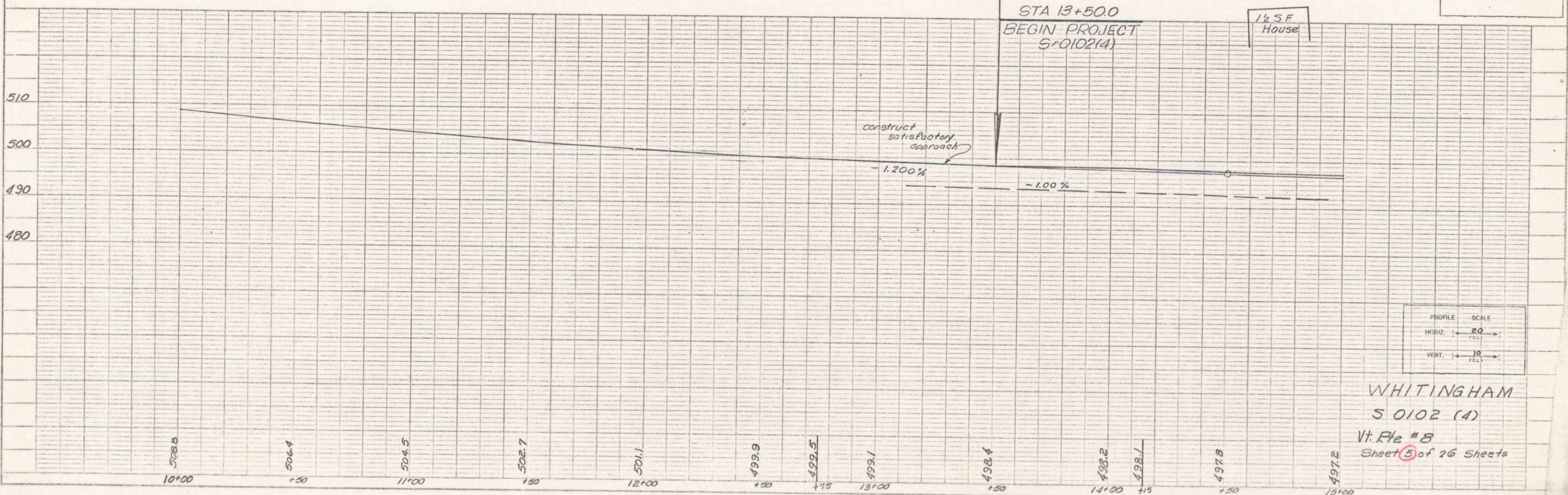
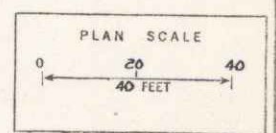
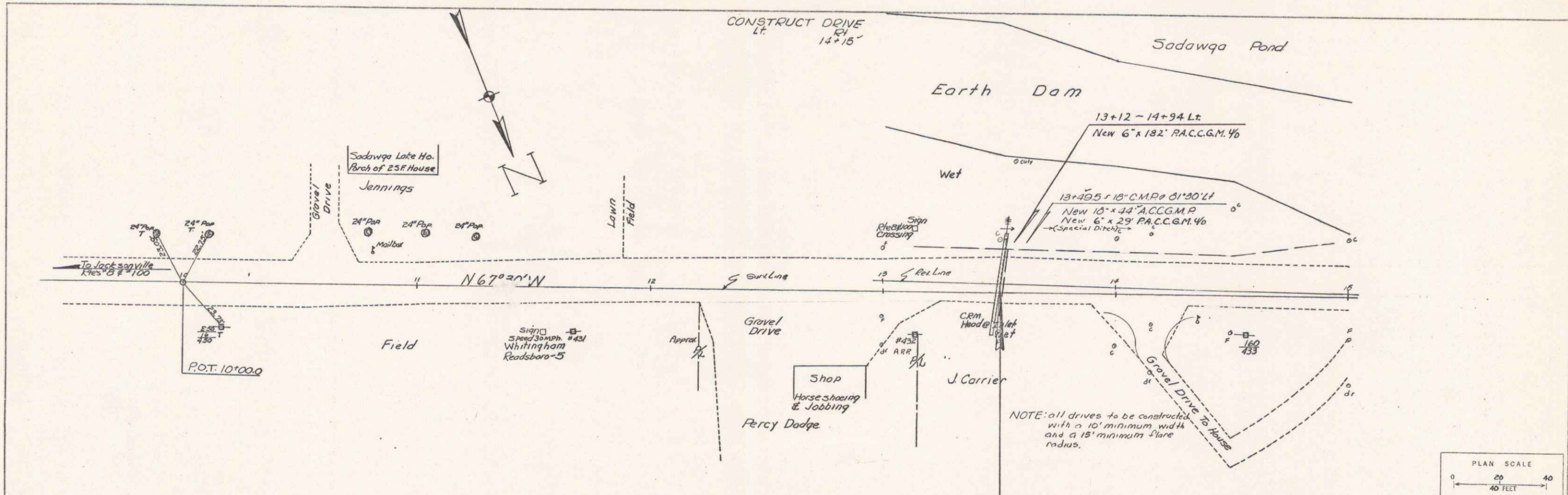

WHITINGHAM
 S 0102 (4)
 Vt. Rte # 8
 Sheet 5 of 26 Sheets

PLAN & PROFILE FOR ROAD CONSTRUCTION
 PROJECT: WHITINGHAM
 SHEET: 5 OF 26
 DATE: 10/10/00

BR-1

2

PLAN
 MAPING
 5/22
 12/62
 NOTE BOOK
 NO.

PROFILE
 MAPING
 5/22
 12/62
 NOTE BOOK
 NO.

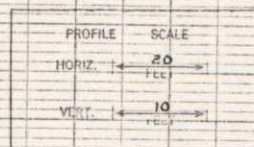
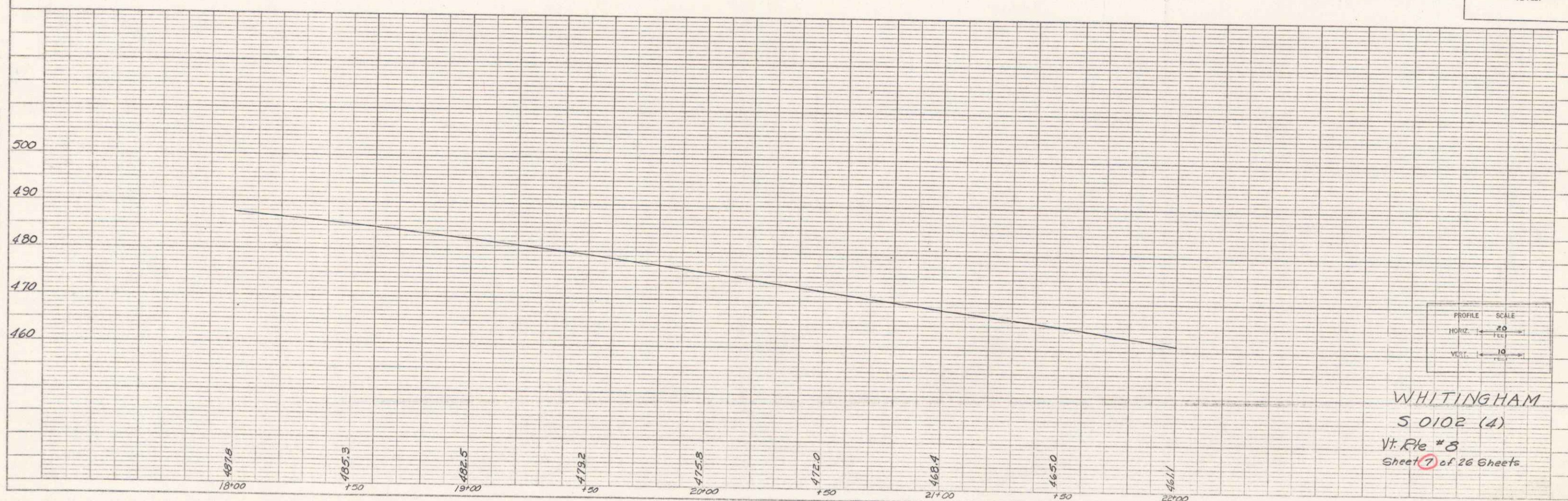
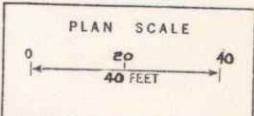
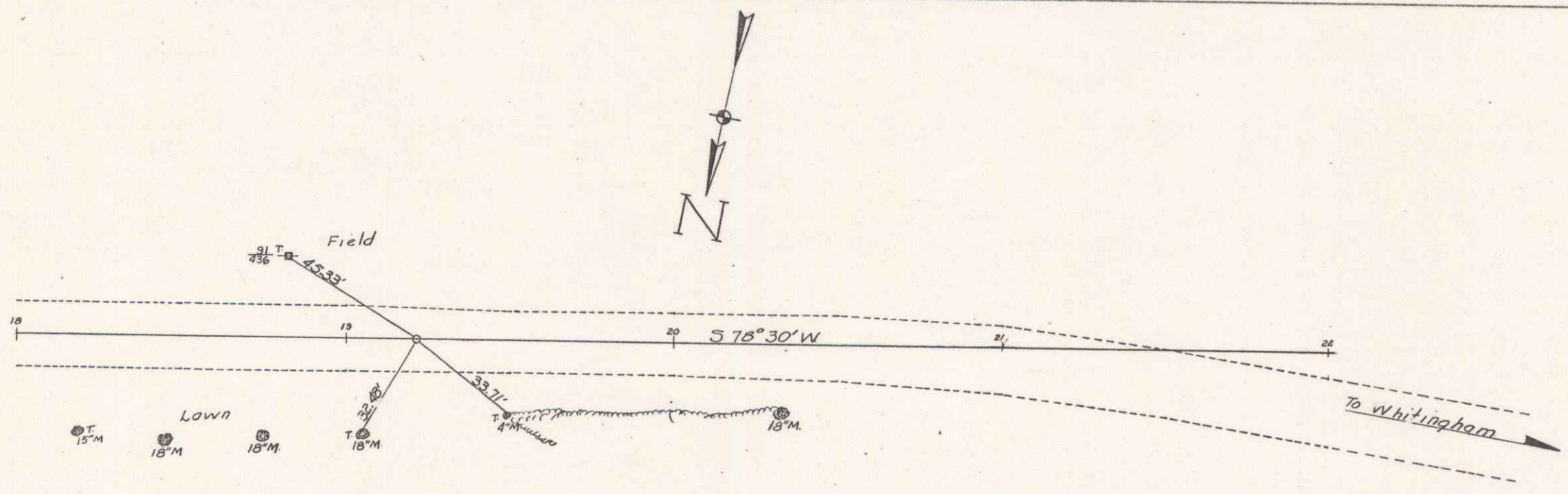

WHITINGHAM
 S 0102 (4)
 Vt. Rte #8
 Sheet 7 of 26 Sheets

PLATE 1 - PLAN - PROFILE - C.P.R. & E. STANDARD
 NEWELL & STUBBS CO., NEW YORK
 MADE IN U.S.A.

BR-3

4