

REV. CURVE
 Δ 44° 17' 11"
 D 31'
 E 319.0
 T 300.0
 L 66 1/2'
 T 7.7

REV. PI 39+168.6
 39+22.8
 SUB. PI 39+168.6
 39+22.8
 Δ 44° 17' 11"
 D 31'

B.M. - T
 5" POPLAR
 ELEV. 98.90

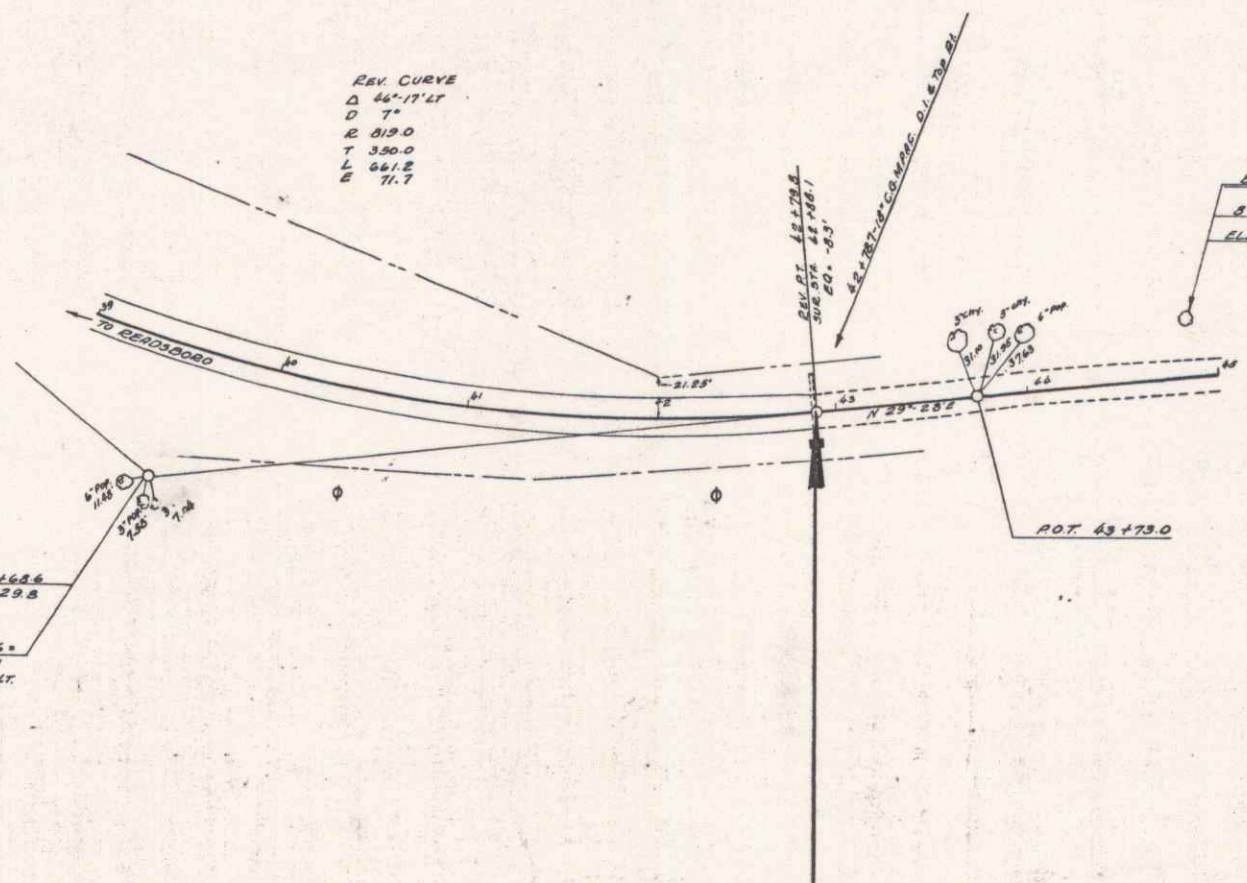

STA. 42+79.8
 END P.W.R. DOCKET 1040-E
 STA. 42+79.8
 BEGIN P.W.R. DOCKET 1040-E
 EXTENSION

ELEVATION
 -0.3 FT

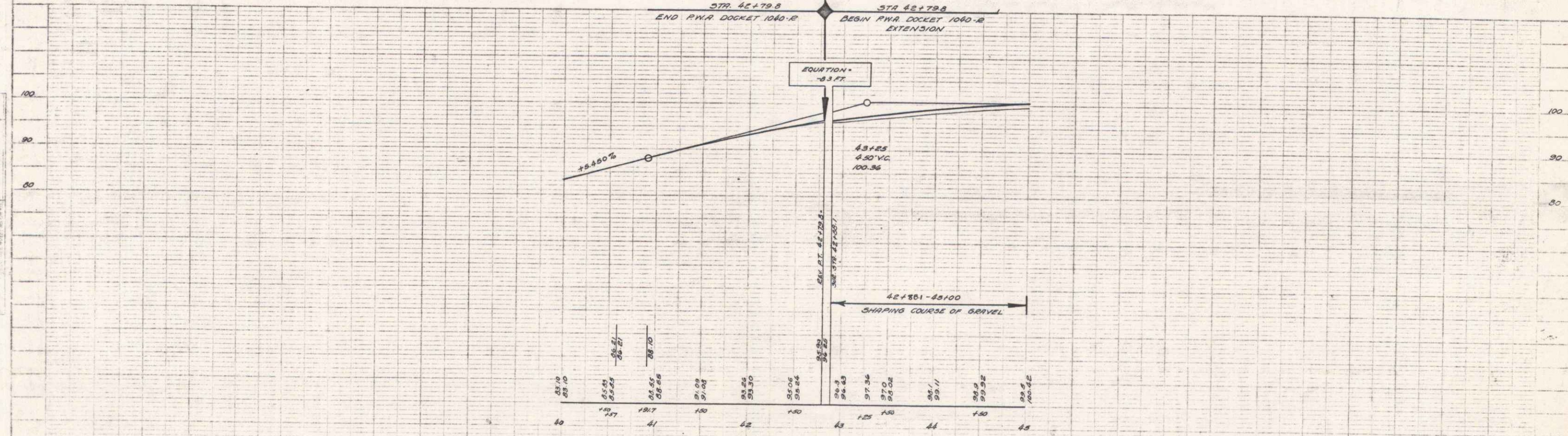

B.M. #1 SPIKE IN TRUNK 5" POPLAR 26 FT LT STA. 44+166 ELEV. 98.30