

DATE 7/19/39  
 DRAWN BY J.M. CASS  
 CHECKED BY J.M. CASS

SCALE 1" = 40' HORIZ.  
 1" = 10' VERT.

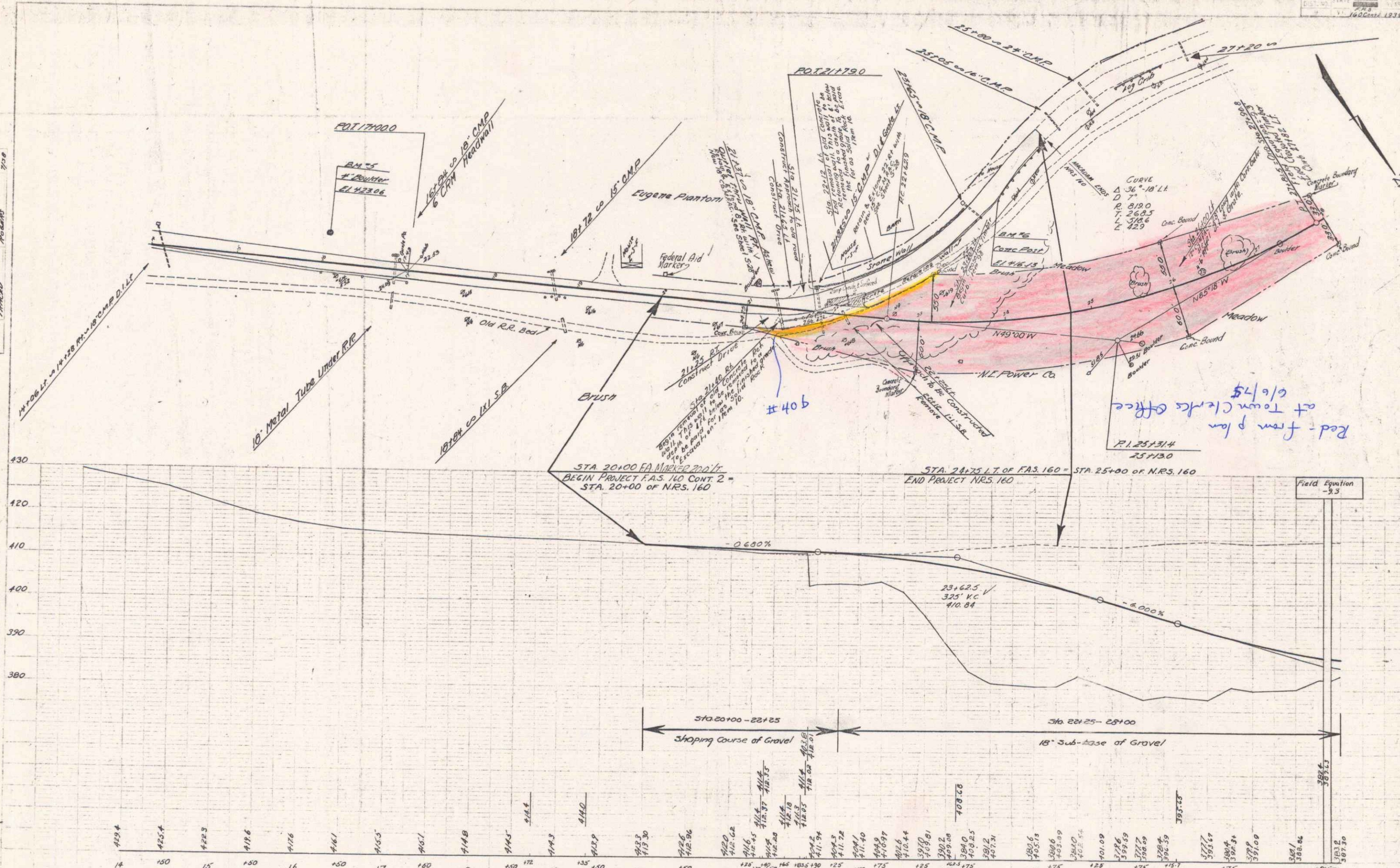

B.M. #5 Spot on Boulder 34 Ft Lt. of Sta. 16+00 Elev. 423.06  
 B.M. #6 Spot on Concrete 140 Ft. Lt. of Sta. 24+00 Elev. 416.13

Red - from plan  
 at Town Clerk's Office  
 6/6/75