

Vermont Department of Highways
 State Engineer
 State Capitol Building
 Montpelier, Vermont
 1930-1935
 1935-1940
 1940-1945
 1945-1950
 1950-1955
 1955-1960
 1960-1965
 1965-1970
 1970-1975
 1975-1980
 1980-1985
 1985-1990
 1990-1995
 1995-2000
 2000-2005
 2005-2010
 2010-2015
 2015-2020
 2020-2025
 2025-2030
 2030-2035
 2035-2040
 2040-2045
 2045-2050
 2050-2055
 2055-2060
 2060-2065
 2065-2070
 2070-2075
 2075-2080
 2080-2085
 2085-2090
 2090-2095
 2095-2100

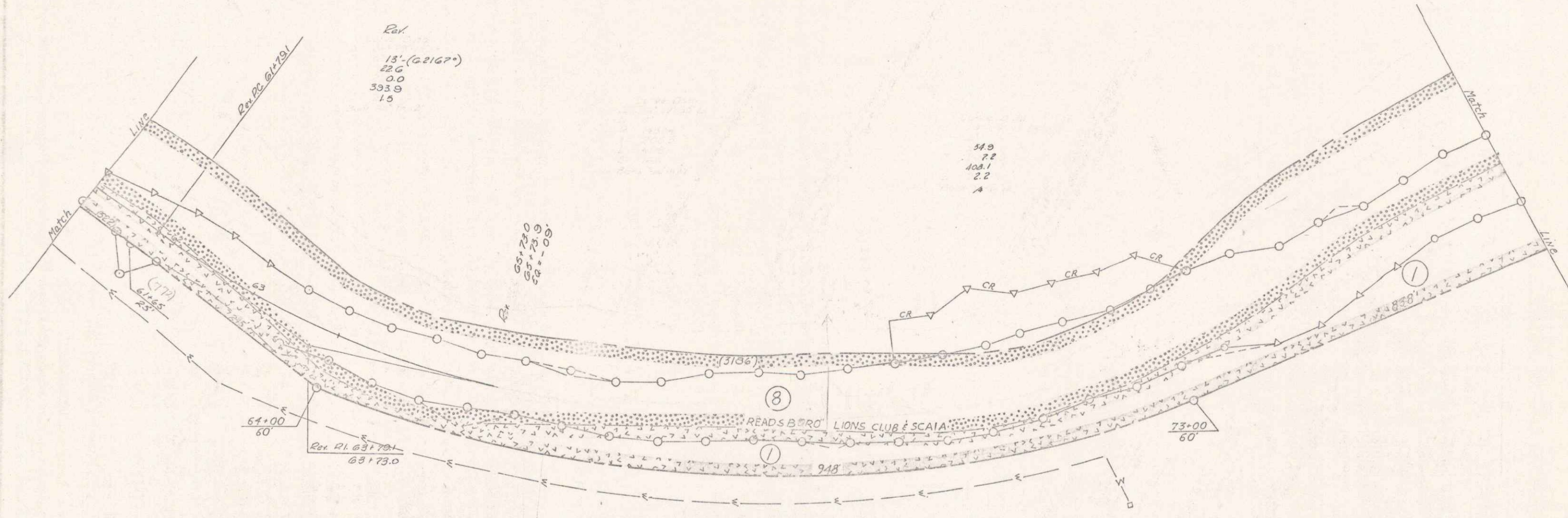

Elev
 13' (22167)
 22.6
 0.0
 393.9
 1.5

54.9
 7.2
 108.1
 2.2
 A

65+72.0
 65+70.9
 68+1+09

VERMONT DEPARTMENT OF HIGHWAYS
 RIGHT-OF-WAY PLANS
 PROJECT READSBORO
 NO 50102(6)
 SHEET 6 OF 67