

INDEX OF SHEETS

SHEET NO	TITLE
2	TYPICAL (1 1/2" BITUMINOUS CONCRETE PAVEMENT)
3	SUMMARY OF QUANTITIES
4	ITEM DETAIL DRAINAGE SHEET
5-8	EARTHWORK SHEETS (INCL. CHANNEL EXC. & STONE FILL - ROADWAY QUANTITIES)
9-10	RIGHT-OF-WAY DETAIL SHEETS
11-24	PLAN AND PROFILE SHEETS
25	DETAILS OF METAL BIN-TYPE RETAINING WALL
BRIDGE SHEETS	
26-39	BR-100 SERIES (PLAN & DETAILS OF REINFORCED CONCRETE ARCH)
40-53	BR-200 SERIES (PLAN & DETAILS OF BRIDGE AT STA. 136+00)
BRIDGE STANDARDS	
54	SCB-32-67 (DETAILS OF W-BEAM BRIDGES-A,B,C DETAILS) JAN. 24, 1968
55	SCB-32-67 (DETAILS OF W-BEAM BRIDGES-A,B,C DETAILS) JAN. 24, 1968
56	SB-R1-64 (SHEET 1 OF 2) (ALUMINUM BRIDGE RAILING DETAILS) JAN. 31, 1968 R
57	SB-R1-64 (SHEET 2 OF 2) (ALUMINUM BRIDGE RAILING DETAILS) JAN. 31, 1968 R
58	SB-R2-65 (BRIDGE RAILING DETAILS) NOV. 8, 1966 R
59	SCB-30-65 (DETAILS OF W-BEAM BRIDGES) FEB. 24, 1966 R
ROADWAY STANDARDS	
60	A-61 (DRILLING & BLASTING OF SOLID ROCK SUB-GRADE) AUG. 7, 1967 R
61	B-1 (SINKING TABLES) JULY 17, 1967 R
62	B-5 (TYPICAL SLOPE GRADING) MARCH 10, 1965
63	B-6 (MUCK EXCAVATION) MARCH 10, 1965
64	B-10 (SLOPE EMBANKMENT) MARCH 10, 1965
65	B-11 (SLOPE STABILIZATION) MARCH 10, 1965
66	C-1 (TREATED TIMBER CURB) OCT. 23, 1968 R
67	D-2 (C.R.M. HEADWALLS) (STANDARD UNDERDRAIN) JULY 25, 1967 R
68	D-3 (TREATED GUTTERS) JULY 19, 1967 R
69	D-4 (UNDERDRAIN FLUSHING BASINS & COVERS) (METAL PIPE ELBOW) AUG. 1, 1966 R
70	D-6 (R.C.D.I. W/ GRATE, FOR DITCHES) DEC. 23, 1966
71	D-8 (R.C.D.I. W/ GRATE - BOTTOM SECTION, OR W/ COVER) MARCH 10, 1965
72	D-10 (R.C.D.I. - TOP SECTION) MARCH 10, 1965
73	D-11 (DETAILS OF GRATES & COVERS FOR R.C.D.I.'S) MARCH 10, 1965
74	D-16 (D.I. TYPE II) (C.I. GRATE - TYPE B) JULY 19, 1967 R
75	E-31 (FEDERAL AID CONSTRUCTION IDENTIFICATION SIGNS) AUG. 31, 1967 R
76	E-32 (ROAD CONSTRUCTION APPROACH SIGNS) JAN. 6, 1967
77	E-33 (BRIDGE CONSTRUCTION APPROACH SIGNS) MAY 3, 1967 R
78	E-34 (ON PROJECT CONSTRUCTION SIGNS) MAY 3, 1967 R
79	G-2A (TWO CABLE GUARD RAIL & ANCHORS) MARCH 10, 1965
80	G-2B (DEAD END ANCHORAGE FOR TWO CABLE GUARD RAIL) MARCH 10, 1965
81	G-4 (WOOD MARKER POSTS) (WOOD GUIDE POSTS) DEC. 30, 1965 R
82	H-1A (METAL BIN-TYPE RETAINING WALL - SHEET 1) MARCH 10, 1965
83	H-1B (METAL BIN-TYPE RETAINING WALL - SHEET 2) MARCH 10, 1965
J-1	(PROJECT MARKERS) (BOUNDARY MARKERS) MARCH 10, 1965
CROSS SECTIONS	
84-131	BANKING TRANSITIONS
132-133	CROSS SECTIONS

**STATE OF VERMONT
DEPARTMENT OF HIGHWAYS
PROPOSED IMPROVEMENT**

**TOWN OF READSBORO
COUNTY OF BENNINGTON
VERMONT ROUTE # 100**

STAMFORD-READSBORO ROAD

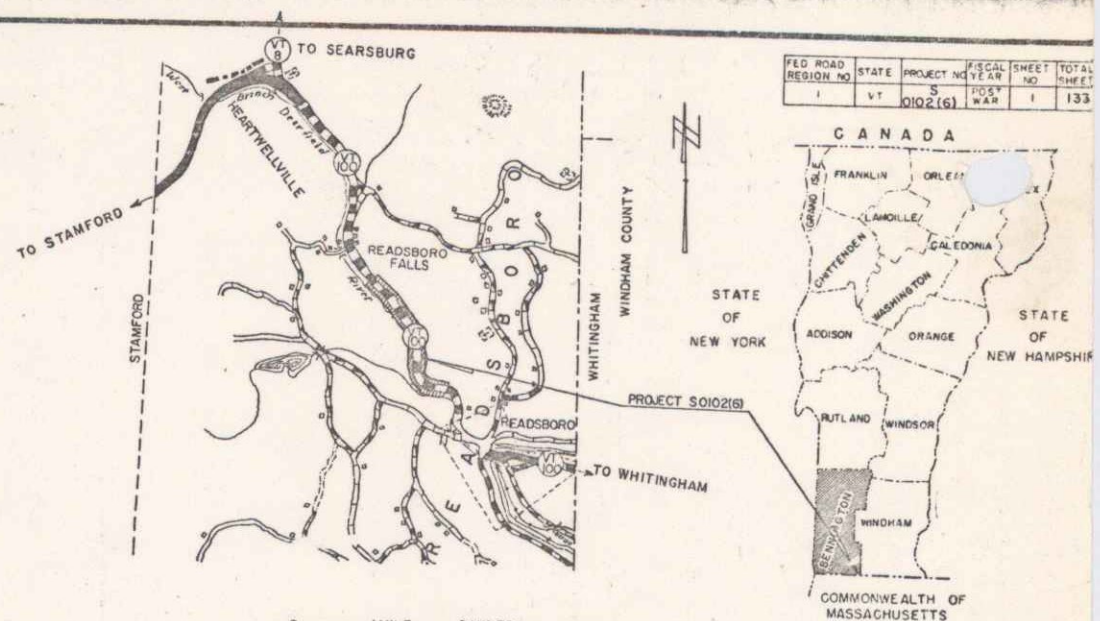

FEDERAL AID SECONDARY PROJECT

BEGINNING AT A POINT APPROXIMATELY 6.539 MILES EASTERLY OF THE STAMFORD-READSBORO TOWN LINE AND EXTENDING NORTHWESTERLY 4.7005 MILES

LENGTH OF ROADWAY = 8,860.1 FEET = 1.6760 MILES
 LENGTH OF BRIDGE = 1,188 FEET = 0.2225 MILES
 LENGTH OF PROJECT = 8,978.9 FEET = 1.7005 MILES

PROJECT NAME & NUMBER TYPE PAVEMENT AREA
 READSBORO S 0102(6) BIT.CONC. 21,922 S.Y.
RECORD PLANS
MATERIALS

- SUBBASE OF GRAVEL - ZUK PIT - READSBORO, VT.
- GRAVEL BACKFILL - ALLEN PIT - READSBORO, VT.
- ASPHALT - MOBIL OIL CO. - ALBANY, N.Y.
- JOINT SEALER - PREFORMED - D. S. BROWN CO. - NO. BALTIMORE, OHIO.
- BITUMINOUS CONCRETE & CONCRETE CLASS B - W.E. DAILEY PLANT - SO. SHAFTSBURY, VT.
- REINFORCING STEEL - BETHLEHEM STEEL CO. - BETHLEHEM, PA.
- STRUCTURAL STEEL & BRIDGE RAILING - VERMONT STR. STEEL CO. - BURLINGTON, VT. STA. 144+000
- METAL CULV. PIPE & METAL BIN TYPE RETAINING WALL - NORTHEASTERN CULVERT CORP. - WESTMINSTER, VT.
- C.I. COVERS FOR FLUSHING BASINS - ETHERIDGE FOUNDRY & MACHINE CO. - PORTLAND, ME.
- A & B TYPE GRATES - E.L. LEBARON FOUNDRY CO. - BROCKTON, MA.
- REINF. CONC. PIPE, P.R.C.C.D.I., TREATED TIMBER CURB & TWO CABLE GUARD RAIL - S.T. GRISWOLD & CO., INC. - WILLISTON, VT.
- WATER REPELLENT - KIBBY EQUIPMENT CO. - WHITE RIVER JCT., VT.
- BRIDGE PAINT - AMSTERDAM COLOR WORKS - NEW YORK, N.Y.

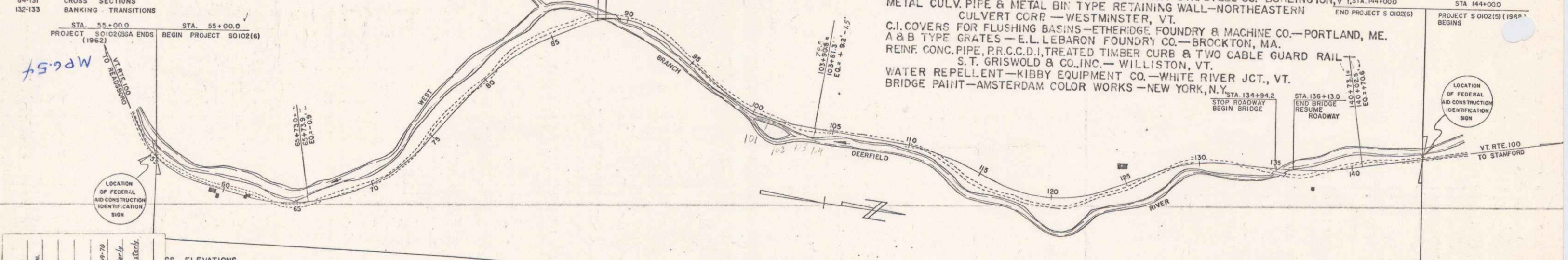

PROJECT READSBORO
 NUMBER S 0102(6)
 TYPE Bituminous Concrete

CONTRACTOR EARLE & MERRY, INC.
 RUTLAND, VT.
 Location Beginning at Point approximately 6.539 miles easterly of the Stamford-Readsboro Town Line and extending northwest 4.7005 miles.

RIGHT OF WAY LINE
 SLOPE RIGHTS

CONTRACTOR - EARLE & MERRY, INC.
 RUTLAND, VT.
 COMPLETE - OCTOBER 20, 1970.

M

1965 ADT = 320
 1965 ADT = 580
 1965 DHV = 120
 D = 67
 T = 8
 V = 40 M.P.H.

CONTRACTOR
 EARLE & MERRY, INC. - RUTLAND, VT.
 RESIDENT ENGINEER - PAUL J. JETTE
 INSPECTORS - F. GILMAN & PETER LANE
 RECORD PLANS - A.G. SPIDLE.

CONTRACT
 DATED - MARCH 26, 1969.
 STARTED - APRIL 1, 1969.
 COMPLETED - OCTOBER 20, 1970.
 ACCEPTED - OCTOBER 20, 1970.

Per: 000596

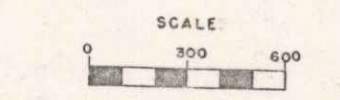

APPROVED *E.H. Nickony*
 DATE 11/12/68

APPROVED *H.M. Smith*
 DATE 11/12/68

APPROVED *[Signature]*
 DATE 11/12/68

APPROVED *[Signature]*
 DATE 9/2/65

APPROVED *[Signature]*
 DATE 11/2/65

APPROVED *G.M. [Signature]*
 DATE 11/12/68

APPROVED *R.D. [Signature]*
 DATE 11/12/68

THESE PLANS ARE SUBJECT TO SUCH REVISIONS AS MAY BE REQUIRED BY THE BUREAU OF PUBLIC ROADS OR THE COMMISSIONER OF HIGHWAYS.

CONSTRUCTION IS TO BE CARRIED ON IN ACCORDANCE WITH THESE PLANS AND THE STANDARD SPECIFICATIONS FOR HIGHWAY AND BRIDGE CONSTRUCTION DATED APRIL 1964 SUBMITTED BY THE BUREAU OF PUBLIC ROADS AS APPROVED OCT. 12, 1964, INCLUDING ALL SUBSEQUENT APPROVED REVISIONS AND SUCH REVISED SPECIFICATIONS AND SPECIAL PROVISIONS AS ARE INCORPORATED WITH THE PLANS.

DEPARTMENT OF TRANSPORTATION
 BUREAU OF PUBLIC ROADS

APPROVED

DIVISION ENGINEER DATE

PROJECT S NO. 0102(6)

SHEET 1 OF 133 SHEETS