

Two Cast Guard Rail
145+30 - 147+00

Gravel Excavation
155+50 - 158+00

Stone Fill and Stone
Protection (Left Side)
158+00 - 158+00

Drainage Excavation of
Road Side
158+00 - 158+00

Excavation & Removal of
Surfaces (Right Side)
158+00 - 158+00

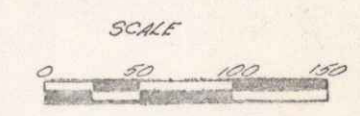
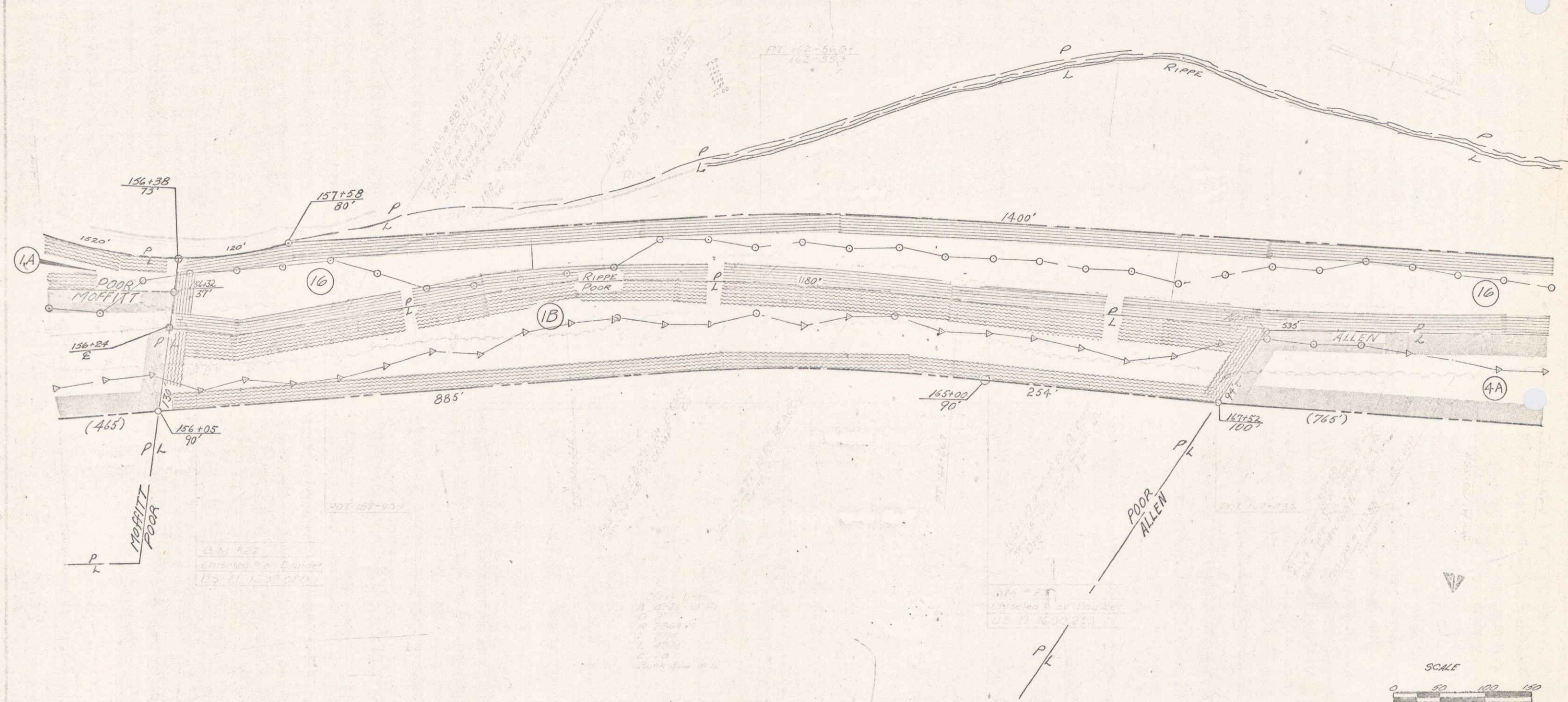

VERMONT DEPARTMENT OF HIGHWAYS
 RIGHT-OF-WAY PLANS
 PROJECT: READSBORO
 No: 3 0102 (3)
 SHEET: 7 OF 21