

UNCLASSIFIED CHANNEL EXCAVATION
L_T
142+00-146+25

STONE FILL FOR SLOPE
PROTECTION (LIGHT TYPE)
L_T
142+00-146+25

WOOD GUIDE POSTS 8" x 6"
L_T
142+00-143+92

TWO CABLE GUARD RAIL
L_T
144+00-147+52

DRILLING & BLASTING OF
SOLID ROCK SUBGRADE
L_T
144+95-147+75

DEMOLITION & DISPOSAL
OF BUILDING
R_T
#1 151+50' #3 154+60'
#2 152+00' #5 154+85'
#4 154+80'

GENERAL NOTE:
Drives are to be constructed with a
minimum width of 12 feet with a minimum
20 foot flare radius.
All existing road pavement within
2 feet of subgrade shall be thoroughly
scarified and broken up. Payment to be
included under the bid price of Common
Excavation, Item 103-A-1.
Grade of Channel Relocation shall be so
constructed that some pools and cover
will be furnished for the trout in the stream.

EXCAVATION & REMOVAL OF ROAD
SURFACES AND/OR PAVEMENTS
L_T
149+50-155+00
150+00

CONSTRUCT DRIVE
R_T
154+00-155+00 155+00 R_T
149+50-
15+00
148+00

B.M. #21
SIR 15' Beech
U.S. EL 1599.698

B.M. #21-A
SIR 15' MAPLE
EL. 1613.19

STA 144+000'
BEGIN PROJECT S 0102 (5)
Construct Satisfactory Approach

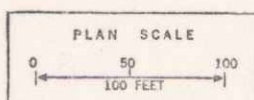
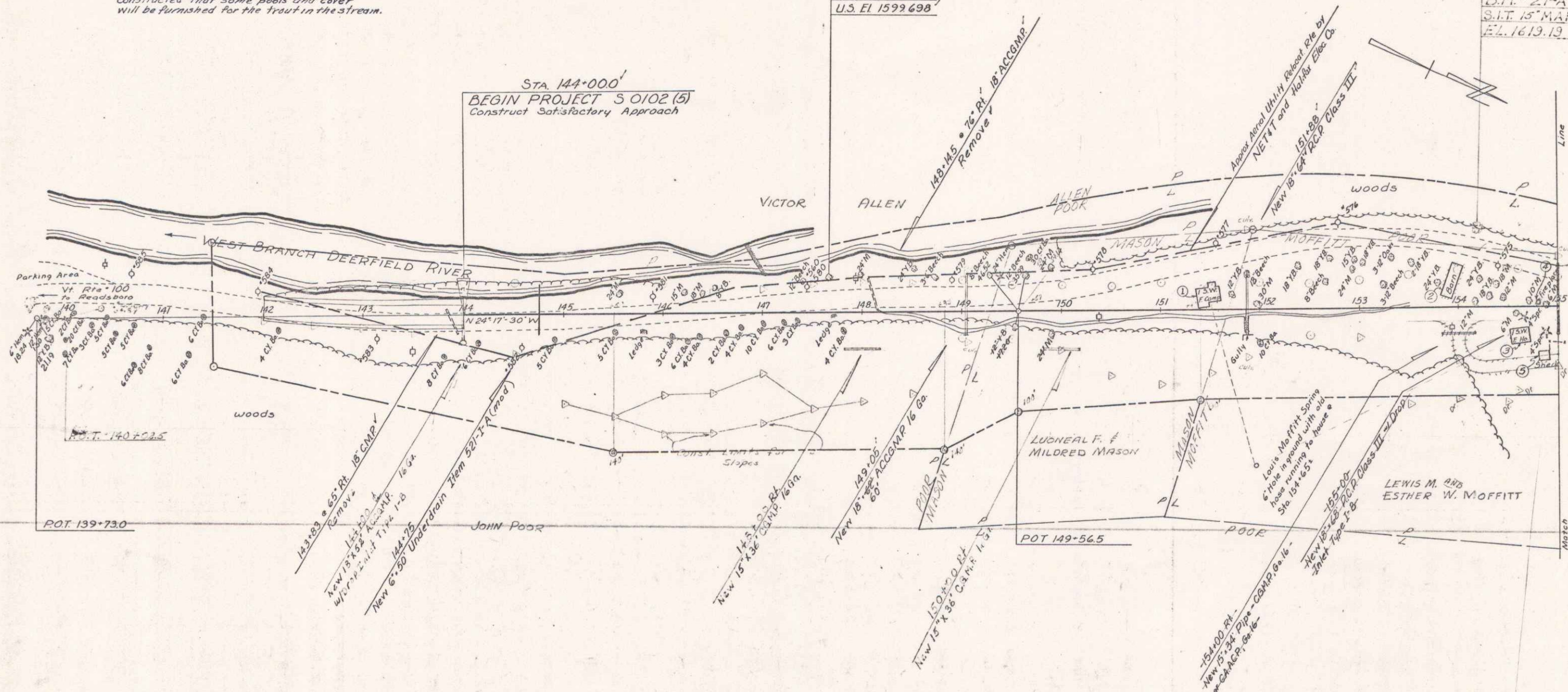

SURVEYED BY Jewett DATE 1963
DRAWN BY Banks DATE 1963
TRACED BY Saig DATE Dec 1963
READSBORO
PROJ. S NO. 0102 (5)
SHEET 13 OF 103