

INDEX OF SHEETS

SHEET NO. 1	TITLE PAGE
" 2	TYPICAL CROSS-SECTION OF IMPROVEMENT GRADING, BASE & CULVERTS
" 3	BANKING AND WIDENING TABLES
" 4-9	PLAN & PROFILE SHEETS
" 10	STANDARD STRUCTURE SHEET 528 PIPE CULVERTS
" 11	" " " " 529 BOX "
" 12	" " " " 530 UNDER DRAIN
" 13	" " " " 531 BARRICADES, SIGNS & LIGHTS
" 14-28	CROSS SECTION SHEETS

Standard sheets 5-28 and 5-29 approved by the Chief Engineer on July 14, 1934.
Standard sheet 5-30 approved by the Chief Engineer on July 23, 1934.

(To Be Returned to R.O.W. Division)

Form of VT 22A
126
REPERVAL
TOWN FILE
HIGHWAY DIVISION

STATE OF VERMONT
STATE HIGHWAY DEPARTMENT

PLAN AND PROFILE OF PROPOSED
STATE HIGHWAY

NATIONAL RECOVERY HIGHWAY PROJECT

TOWN OF ORWELL

SHOREHAM - BENSON ROAD
FROM 900 FT. ± NORTH OF AN 8'x6' -
CONCRETE BRIDGE SOUTHERLY 1.496
MILES.

LENGTH OF PROJECT 7900.7' = 1.496 MI.

FED. ROAD DIST. NO.	STATE	FISCAL YEAR	SHEET NO.	TOTAL SHEETS
9	VT.	1934	1	28

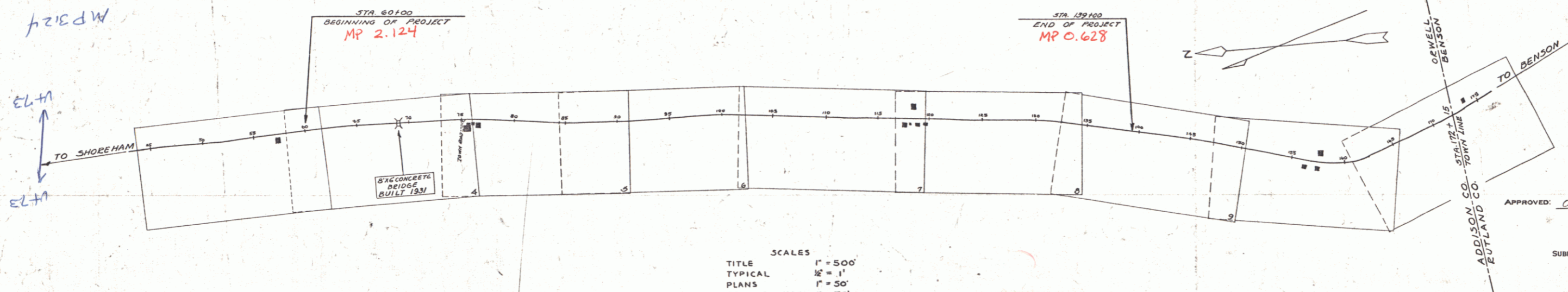
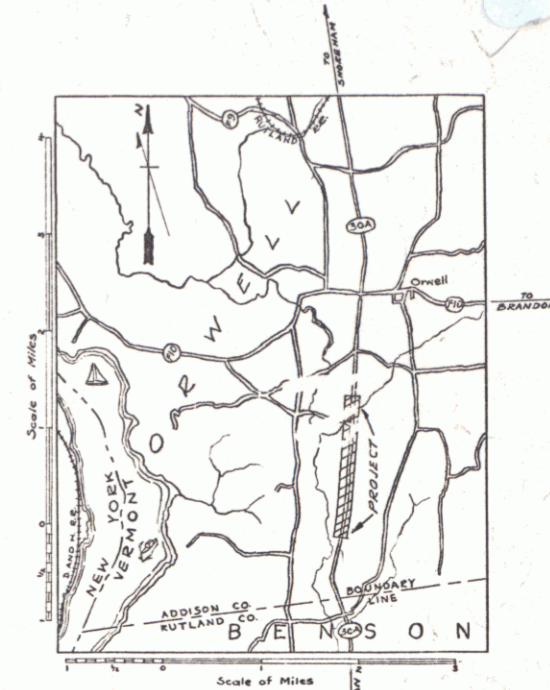

CONVENTIONAL SIGNS

- COUNTY LINE
- TOWN LINE
- FENCE LINE
- STONE WALL
- UNFENCED PROPERTY
- GUARD RAIL
- TRAVELED WAY
- RAILROAD
- RETAINING WALL
- CENTER LINE
- SURVEY LINE
- CULVERT
- DROP INLET
- TROLLEY POLE
- POWER POLE
- TELEPHONE POLE
- TREES
- HEDGE

- GROUND ELEVATION
- GRADE ELEVATION

CURVE DATA

- DEFLECTION ANGLE
- DEGREE OF CURVE
- RADIUS OF CURVE
- TANGENT DISTANCE
- LENGTH OF CURVE
- EXTERNAL DISTANCE
- POINT OF INTERSECTION
- POINT OF CURVE
- POINT OF TANGENT
- POINT ON TANGENT

SCALES

TITLE	1" = 500'
TYPICAL	1/2" = 1'
PLANS	1" = 50'
PROFILE	HOR. 1" = 50'
VERT.	1" = 10'
SECTIONS	1" = 5'

Route: VT 22A
Per: 00R591
Date: 10/3/34

These plans are subject to such revisions as may be required by the Bureau of Public Roads or the Commissioner of Highways. Construction is to be carried on in accordance with the plans and Standard Road and Bridge Specifications of 1933 with such revised specifications and special provisions as are submitted with the plans.

The attention of the contractor is called to the fact that the State Highway Board reserve the right to extend this project at the same contract prices, said cost of extension not to exceed 25% of the amount of the contract.

APPROVED: Oct. 8, 1934

H. J. Sargent
COMMISSIONER OF HIGHWAYS

SUBMITTED BY ORDER OF THE STATE HIGHWAY BOARD

RECOMMENDED [Signature]
DISTRICT ENGINEER BUREAU OF PUBLIC ROADS

RECOMMENDED FOR APPROVAL [Signature]
CHIEF ENGINEER BUREAU OF PUBLIC ROADS

APPROVED [Signature]
DIRECTOR BUREAU OF PUBLIC ROADS

CORRECTED: Oct. 8, 1934
D. J. [Signature]
ROAD ENGINEER

SERIES: N.R.S. NO. 16800 FILED
SHEET 1 OF 28