

INDEX OF SHEETS

SHEET NO. 1	TITLE PAGE
2	TYPICAL CROSS-SECTION OF IMPROVEMENT 6" GRAVEL SURFACE COURSE-ITEM 20
3	BANKING AND WIDENING TABLES
4-9	PLAN AND PROFILE SHEETS
10	STANDARD STRUCTURE SHEET 520; PIPE CULVERTS
11	" " " " 530; GUARD RAIL
12	" " " " 531; BOUNDARY MARKERS
13	" " " " 531; BOX CULVERTS
14	" " " " 540; BARRICADES, SIGNS & LIGHTS
15-28	CROSS-SECTION SHEETS

Standard Structure Sheet 528 approved by the Chief Engineer on July 16, 1933.

Standard Structure Sheet 530 approved by the Chief Engineer on Aug. 15, 1933.

Standard Structure Sheet 531 approved by the Chief Engineer on July 25, 1934.

PROJECT	ROUTE 146C
NUMBER	W.P.S.S. 146C
TYPE	GRAVEL
CONTRACTOR	C. R. Beach
YEAR	1935
LOCATION	Route 146C beginning at a point 2,650 feet south of the first turn to Benson Village and extending northerly 1.4 miles to road to Hubbardton.

FED. ROAD DIST. NO.	STATE	W.P.S.S. PROJ. NO.	FISCAL YEAR	SHEET NO.	TOTAL SHEETS
9	VT.	146C	1935	1	28

**STATE OF VERMONT
STATE HIGHWAY DEPARTMENT**

**PLAN AND PROFILE OF PROPOSED
STATE HIGHWAY**
U.S. WORKS PROGRAM STATE SECONDARY PROJECT (W.P.S.S. 146C)

TOWN OF BENSON

FAIR HAVEN-VERGENNES ROAD

BEGINNING AT A POINT 2650 FT. SOUTH OF THE FIRST TURN TO BENSON VILLAGE, AND EXTENDING NORTHERLY 1.420 MILES, TO 50 FT. SOUTH OF THE ROAD TO HUBBARDTON.

LENGTH OF PROJECT 7500.0 FT. = 1.420 MILES

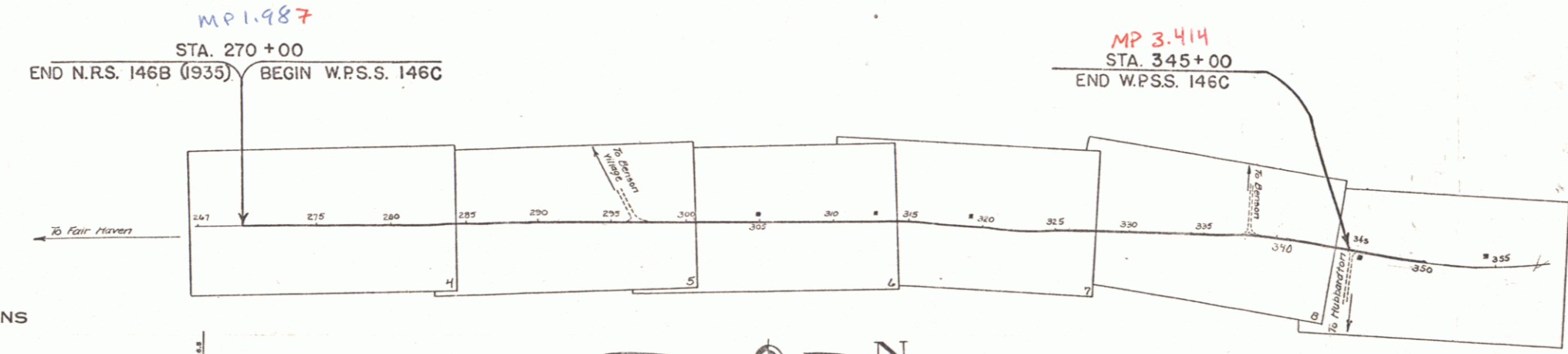
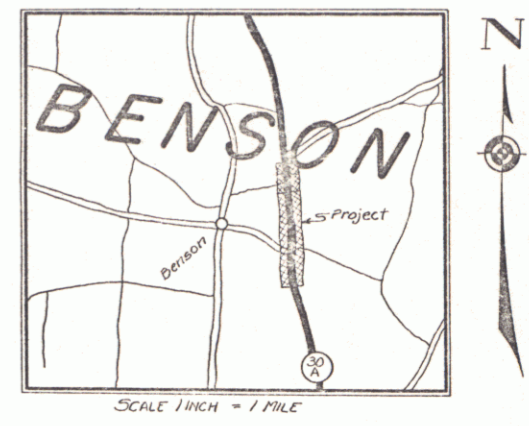

Route: VT 22A
Per: 100RS89
Date: 10/21/1935

APPROVED: Oct 21, 1935
H. Vergennes
COMMISSIONER OF HIGHWAYS
SUBMITTED BY ORDER OF THE STATE HIGHWAY BOARD

- CONVENTIONAL SIGNS**
- COUNTY LINE
 - TOWN LINE
 - FENCE LINE
 - STONE WALL
 - UNFENCED PROPERTY
 - GUARD RAIL
 - TRAVELED WAY
 - RAILROAD
 - RETAINING WALL
 - CENTER LINE
 - SURVEY LINE
 - CULVERT
 - DROP INLET
 - TROLLEY POLE
 - POWER POLE
 - TELEPHONE POLE
 - TREES
 - HEDGE

GROUND ELEVATION DATUM LINE
GRADE ELEVATION DATUM LINE

CURVE DATA

DEFLECTION ANGLE..... Δ
DEGREE OF CURVE..... D
RADIUS OF CURVE..... R
TANGENT DISTANCE..... T
LENGTH OF CURVE..... L
EXTERNAL DISTANCE..... E
POINT OF INTERSECTION..... P. I.
POINT OF CURVE..... P. C.
POINT OF TANGENT..... P. T.
POINT ON TANGENT..... P. O. T.

SCALES

TITLE	1" = 500'
TYPICAL	1" = 2'
PLAN	1" = 50'
PROFILE	1" = 10'
CROSS SECTIONS	1" = 5'

These plans are subject to such revisions as may be required by the Bureau of Public Roads or the Commissioner of Highways.
Construction is to be carried on in accordance with the plans and Standard Road and Bridge Specifications of 1930, including all subsequent approved revisions, and such revised specifications and special provisions as are submitted with the plans.
Attention of the contractor is called to the fact that the State Highway Board reserves the right to extend this project at the same contract prices. Said cost of extension not to exceed 25% of the amount of the contract.

RIGHT-OF-WAY DIVISION
TOWN FILE
PERPETUAL
Town of VT 22 A
(To Be Returned To R.O.W. Division)

RECOMMENDED _____
DISTRICT ENGINEER BUREAU OF PUBLIC ROADS
RECOMMENDED FOR APPROVAL _____
CHIEF ENGINEER BUREAU OF PUBLIC ROADS
APPROVED _____
DIRECTOR - BUREAU OF PUBLIC ROADS

Correct: Oct 21, 1935
C. J. ...
Road Engineer
SERIES W.P.S.S. NO. 146C FILED
SHEET (1) OF 28