

POOR ORIGINAL COPY

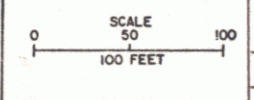
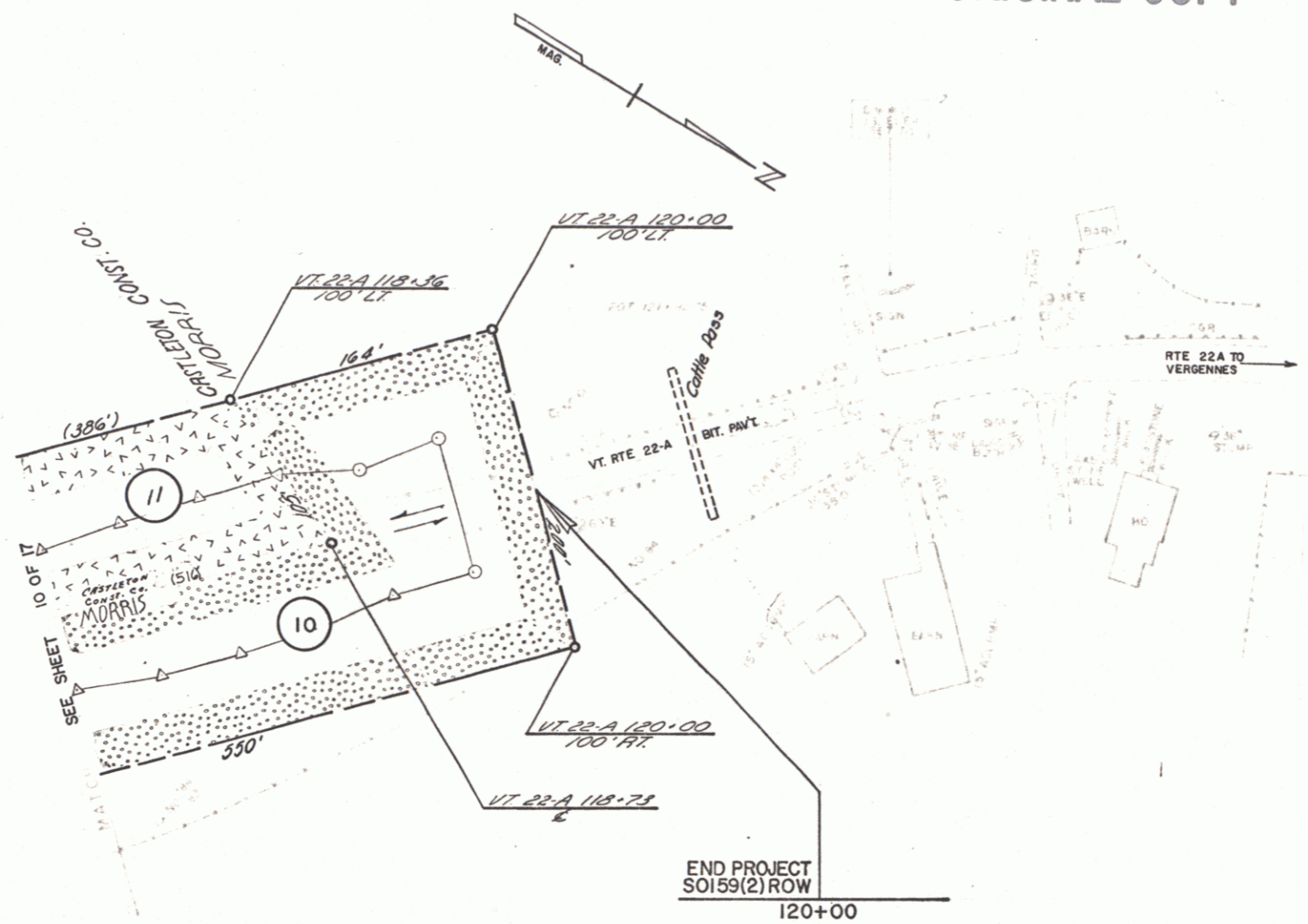

STATE OF VERMONT DEPARTMENT OF HIGHWAYS			
RELOCATION OF VT. ROUTE 22-A in the town of FAIR HAVEN PLAN STA. 117+00.00 - 122+00.00			
SCALE 50 100 FEET		SHEET 15A	
VT. HWY DEPT. JO	ANN RAS	APRIL 1967	17
SO159(2)ROW		11	