

Drilling & Blasting of Solid Rock Subgrade  
89+00-92+60

Non-Grout Port  
88+00 Lt.  
Const. Drive

STATION	STATION	POS
89+00	92+00	E

STATION	STATION	POS
98+75	98+25	W
98+35	99+30	W

STATION	STATION	POS
98+30	101+00	W
99+30	101+00	W

STATION	STATION	POS
93+30	96+00	W
97+25	101+00	W

STATION	STATION	POS
89+00	91+00	W

STATION	STATION	POS
99+00	101+00	W

PLAN  
NOTES:  
1. ALL DIMENSIONS TO FACE UNLESS OTHERWISE NOTED.  
2. ALL DIMENSIONS TO BE CHECKED BY THE CONTRACTOR.  
3. ALL DIMENSIONS TO BE CHECKED BY THE ENGINEER.  
4. ALL DIMENSIONS TO BE CHECKED BY THE SURVEYOR.

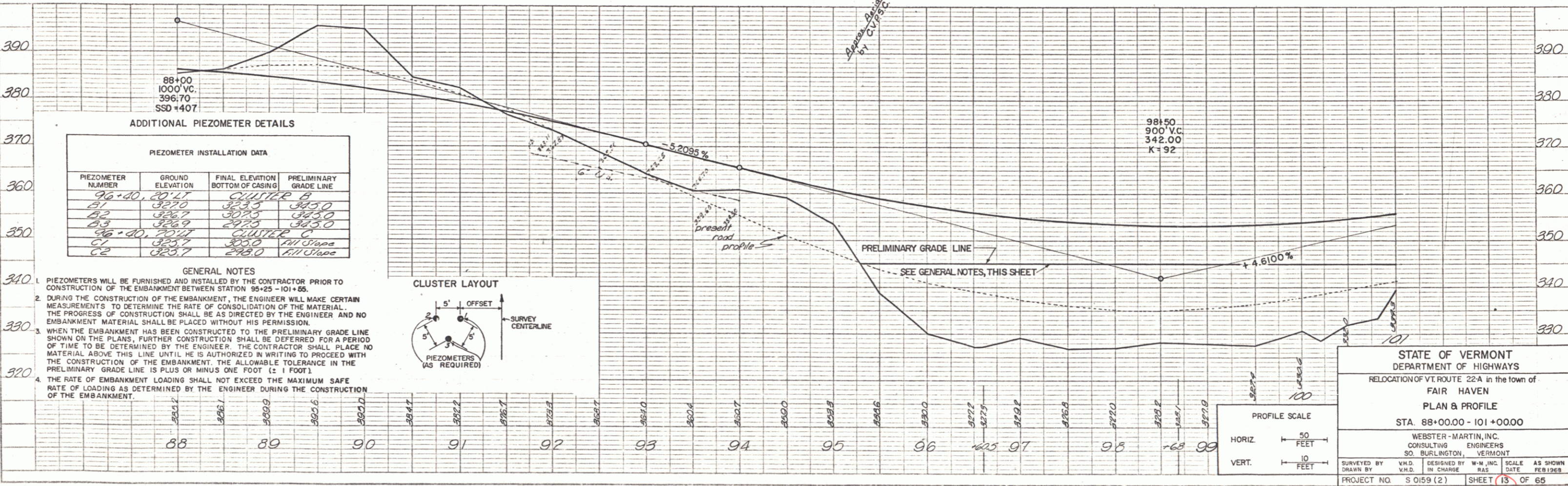
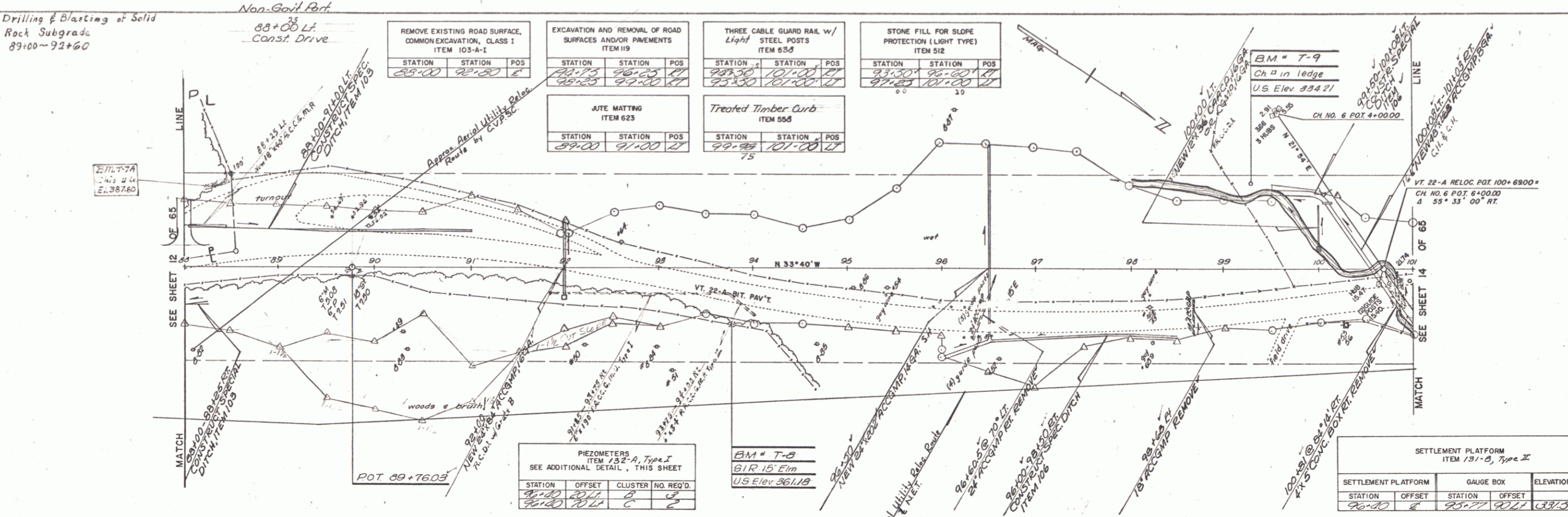

ADDITIONAL PIEZOMETER DETAILS

PIEZOMETER NUMBER	GROUND ELEVATION	FINAL ELEVATION BOTTOM OF CASING	PRELIMINARY GRADE LINE
96+40, 20' LT	3270	3235	3250
97	3267	3233	3250
98	3269	3235	3250
98+40, 20' RT	3274	3230	3250
99	3257	3230	3250

- GENERAL NOTES
- PIEZOMETERS WILL BE FURNISHED AND INSTALLED BY THE CONTRACTOR PRIOR TO CONSTRUCTION OF THE EMBANKMENT BETWEEN STATION 98+25 - 101+05.
  - DURING THE CONSTRUCTION OF THE EMBANKMENT, THE ENGINEER WILL MAKE CERTAIN MEASUREMENTS TO DETERMINE THE RATE OF CONSOLIDATION OF THE MATERIAL. THE PROGRESS OF CONSTRUCTION SHALL BE AS DIRECTED BY THE ENGINEER AND NO EMBANKMENT MATERIAL SHALL BE PLACED WITHOUT HIS PERMISSION.
  - WHEN THE EMBANKMENT HAS BEEN CONSTRUCTED TO THE PRELIMINARY GRADE LINE SHOWN ON THE PLANS, FURTHER CONSTRUCTION SHALL BE DEFERRED FOR A PERIOD OF TIME TO BE DETERMINED BY THE ENGINEER. THE CONTRACTOR SHALL PLACE NO MATERIAL ABOVE THIS LINE UNTIL HE IS AUTHORIZED IN WRITING TO PROCEED WITH THE CONSTRUCTION OF THE EMBANKMENT. THE ALLOWABLE TOLERANCE IN THE PRELIMINARY GRADE LINE IS PLUS OR MINUS ONE FOOT (± 1 FOOT).
  - THE RATE OF EMBANKMENT LOADING SHALL NOT EXCEED THE MAXIMUM SAFE RATE OF LOADING AS DETERMINED BY THE ENGINEER DURING THE CONSTRUCTION OF THE EMBANKMENT.

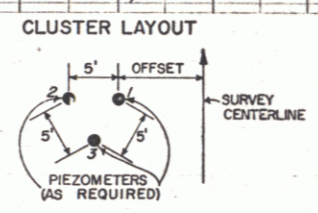

STATE OF VERMONT  
DEPARTMENT OF HIGHWAYS  
RELOCATION OF VT. ROUTE 22A in the town of FAIR HAVEN  
PLAN & PROFILE  
STA. 88+00.00 - 101+00.00  
WEBSTER - MARTIN, INC.  
CONSULTING ENGINEERS  
50 BURLINGTON, VERMONT  
SURVEYED BY: W.M. INC. DESIGNED BY: W.M. INC. SCALE: AS SHOWN  
DRAWN BY: W.M. INC. IN CHARGE: RAS DATE: FEB 1968  
PROJECT NO. S 0159 (2) SHEET 13 OF 65

PLATE 1 - PLAN, PROFILE & P.A. & S. STAKING  
REMPER & SISKIYOU CO., NEW YORK  
K & E CO. 100 DASHING  
NEW YORK