

WOOD GUIDE POSTS REQUIRED

CULV. STA.	LT.	RT.
59+32	2	2

NEW BRICK CONCRETE PIPE CONDUIT REQUIRED

STATION	DIAM.	LENG.	C.P.M.
59+32	15"	36'	27.00

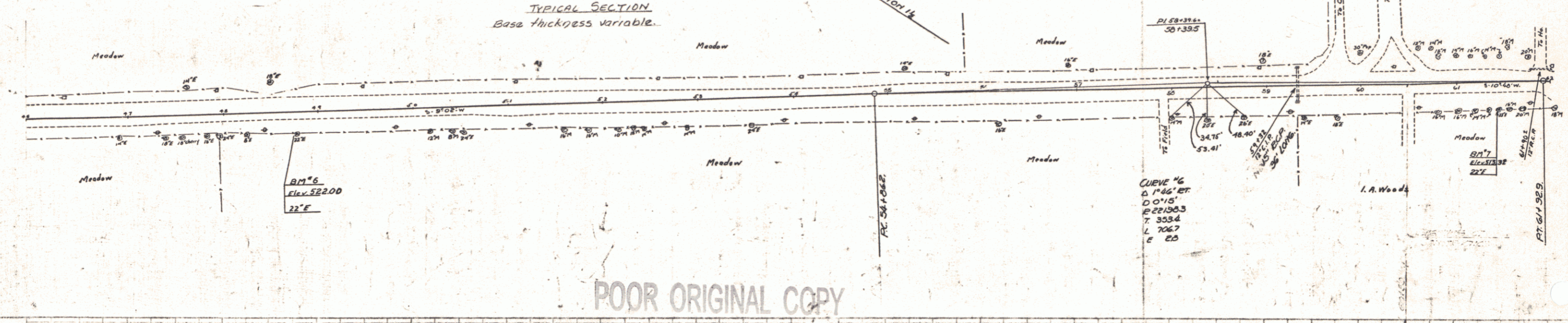
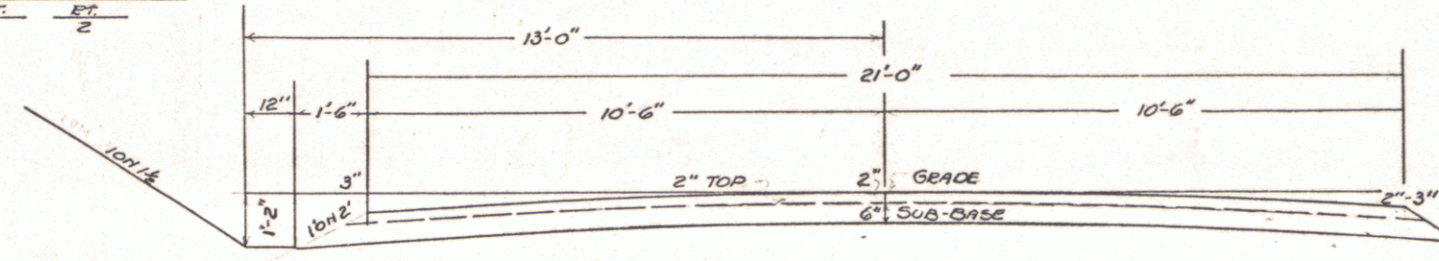

POOR ORIGINAL COPY

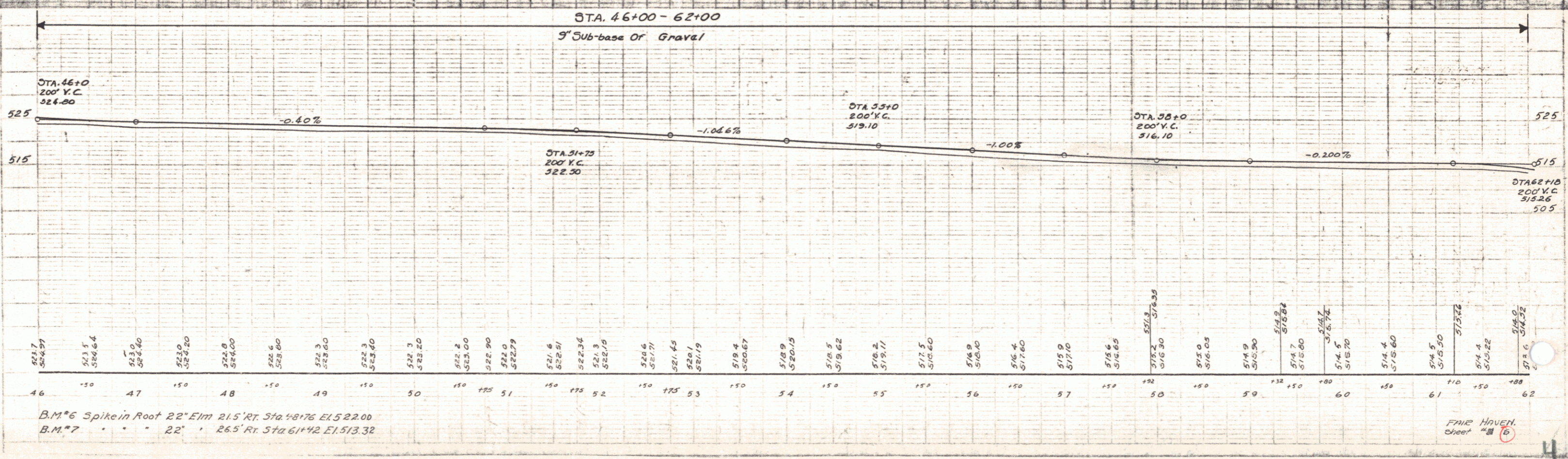

B.M.#6 Spike in Root 22" Elm 21.5' Rt. Sta 48+76 EL 522.00
 B.M.#7 " " " 22" " 26.5' Rt. Sta 61+42 EL 513.32

FRAME HOVER. Sheet # 6