

STATE OF VERMONT
 AGENCY OF TRANSPORTATION
 PROPOSED IMPROVEMENT

TOWN OF BARTON

COUNTY OF ORLEANS

VERMONT ROUTE 16

BEGINNING AT A POINT APPROXIMATELY 674 FEET
 NORTHERLY OF THE BARTON - GLOVER TOWN LINE
 AND EXTENDING NORTHERLY 314 FEET

LENGTH OF R.O.W. PROJECT 314 FEET

Route VT 16
 Project MA 3029
 Date 05/01/1980
 P.in # 00R579

R.O.W. PLANS

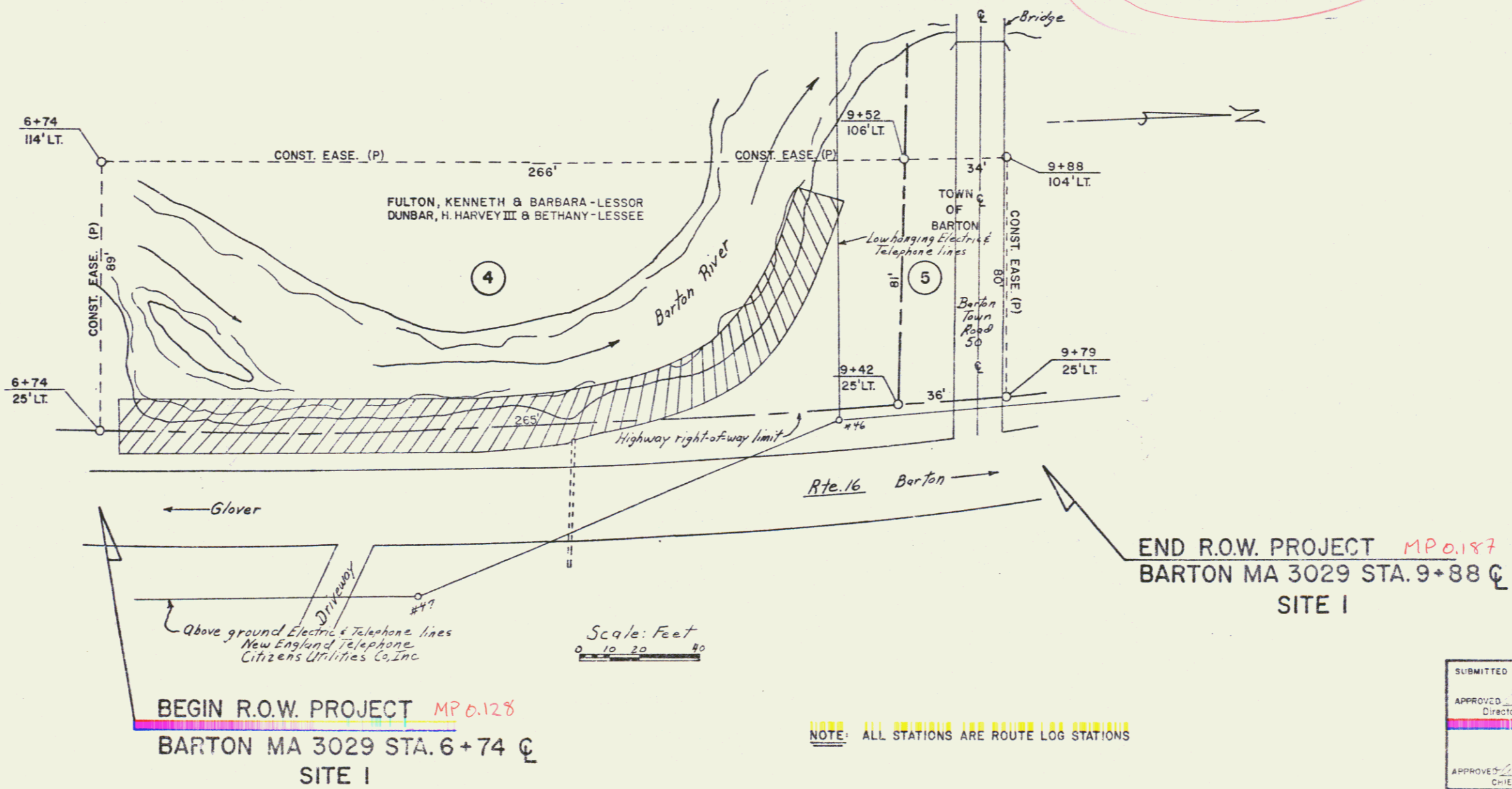

END R.O.W. PROJECT MP 0.187
 BARTON MA 3029 STA. 9+88 C
 SITE I

BEGIN R.O.W. PROJECT MP 0.128
 BARTON MA 3029 STA. 6+74 C
 SITE I

SUBMITTED BY ORDER OF THE STATE HIGHWAY BOARD	
APPROVED <i>[Signature]</i> DATE <i>5-1-80</i>	Director of Engineering and Construction
APPROVED <i>[Signature]</i> DATE <i>5-1-80</i>	CHIEF, PROPERTY ADMINISTRATION
PROJECT MA N° 3029	SHEET 3 OF 6

BEGINNING AT A POINT APPROXIMATELY 1.45 MILES
 NORTHERLY OF THE BARTON - GLOVER TOWN LINE
 AND EXTENDING NORTHERLY 0.189 MILES
 LENGTH OF R.O.W. PROJECT 998 FEET 0.189 MILES

LYON, MELVIN E. & SHIRLEY E.

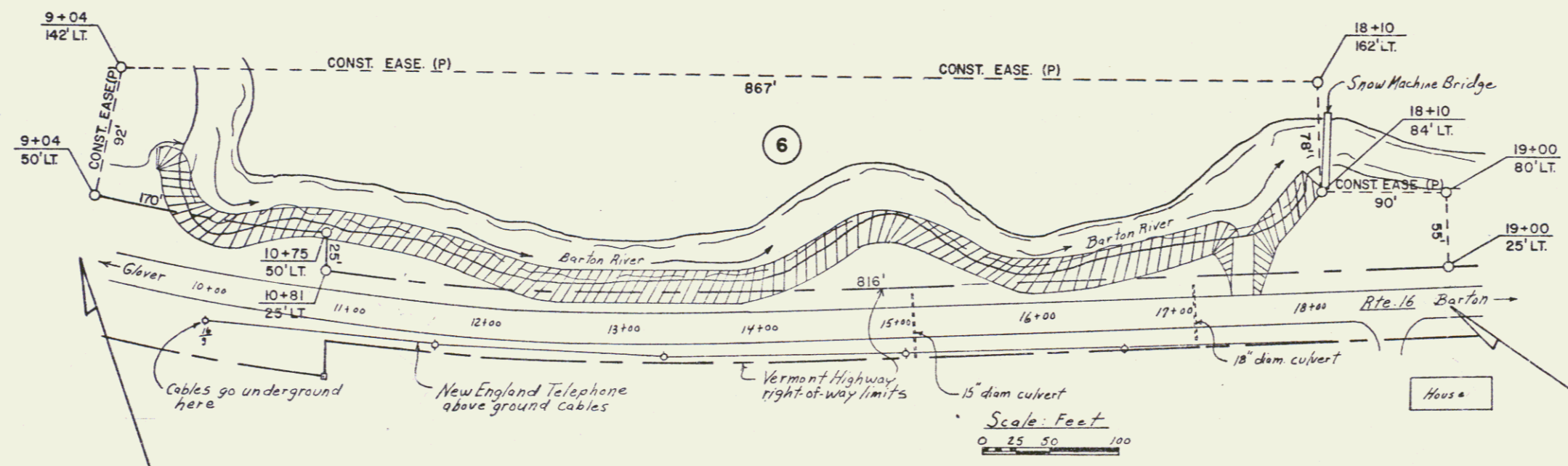

BEGIN R.O.W. PROJECT
 BARTON MA 3029 STA. 9+04 C
 SITE 2

END R.O.W. PROJECT *MP 0.360*
 BARTON MA 3029 STA. 19+00 C
 SITE 2

PROJECT BARTON MA # 3029
 SHEET 6 OF 6