

STATE OF VERMONT  
 AGENCY OF TRANSPORTATION  
 PROPOSED IMPROVEMENT

**TOWN OF BARTON**

COUNTY OF ORLEANS

**VERMONT ROUTE 16**

BEGINNING AT A POINT APPROXIMATELY 674 FEET  
 NORTHERLY OF THE BARTON - GLOVER TOWN LINE  
 AND EXTENDING NORTHERLY 314 FEET

LENGTH OF R.O.W. PROJECT 314 FEET

Route VT 16  
 Project MA 3029  
 Date 05/01/1980  
 P.in # 00R579

R.O.W. PLANS

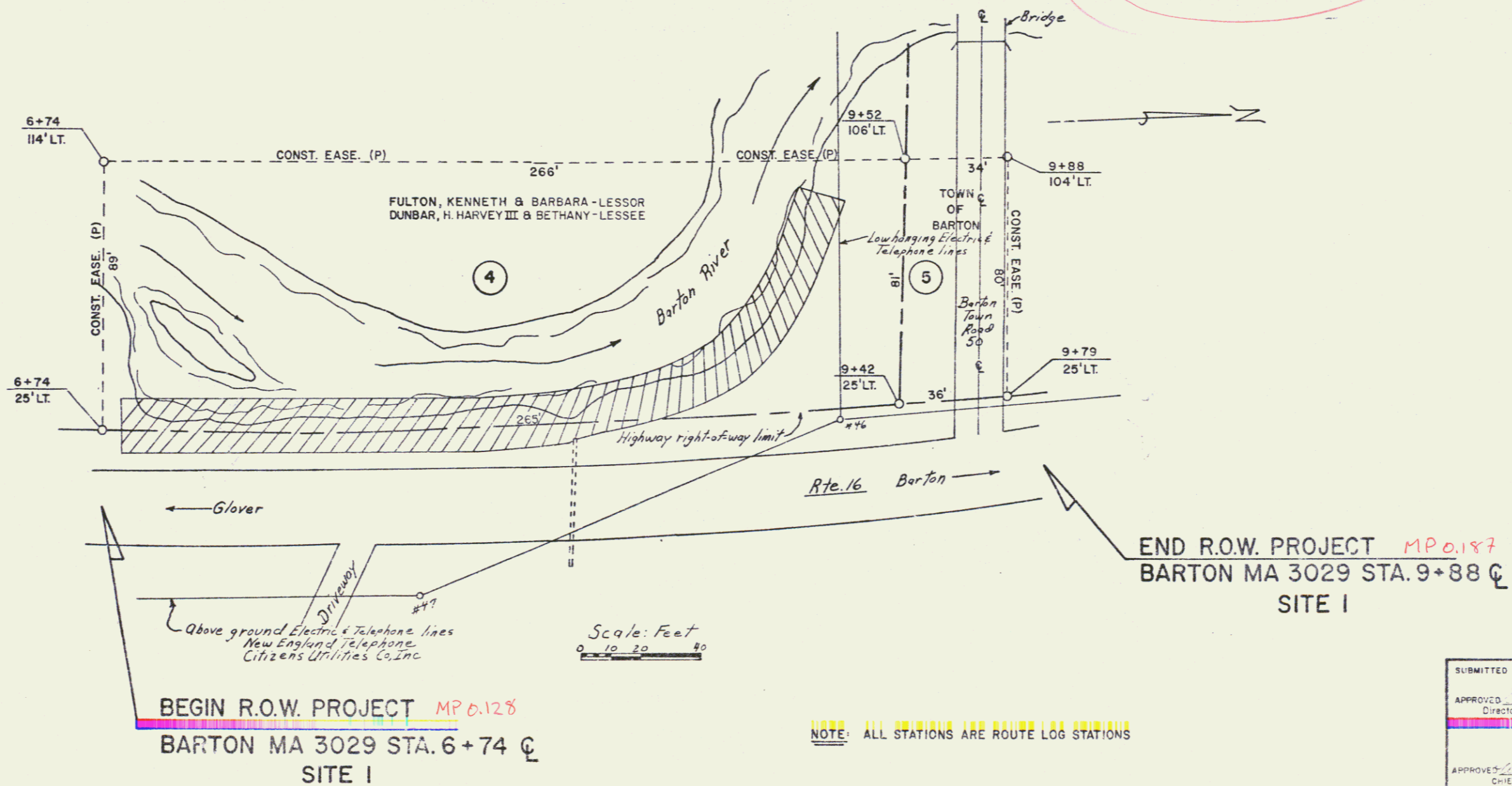

END R.O.W. PROJECT MP 0.187  
 BARTON MA 3029 STA. 9+88 C  
 SITE I

BEGIN R.O.W. PROJECT MP 0.128  
 BARTON MA 3029 STA. 6+74 C  
 SITE I

Scale: Feet  
 0 10 20 40

NOTE: ALL STATIONS ARE ROUTE LOG STATIONS

|                                                |                                          |
|------------------------------------------------|------------------------------------------|
| SUBMITTED BY ORDER OF THE STATE HIGHWAY BOARD  |                                          |
| APPROVED <i>[Signature]</i> DATE <i>5-1-80</i> | Director of Engineering and Construction |
| APPROVED <i>[Signature]</i> DATE <i>5-1-80</i> | CHIEF, PROPERTY ADMINISTRATION           |
| PROJECT MA N° 3029                             | SHEET 3 OF 6                             |