

Present drainage system on left from bridge
 end of project to be ~~retained~~ as this system
 serves as a sanitary sewer system, except
 The present drop inlets serving as a surface
 water drainage system shall be "capped" in a
 manner acceptable to the engineer to
 discontinue their use for surface water.

Wherever necessary present drop inlets are
 to be removed and connected with 8" vitrified
 clay pipe to make room for new drop inlets.

Present wood rail of bridge to be
 retained and painted, painting to be as
 an extra work item.

Curve #5
 Δ 3° 30' LR
 D 10'
 E 5729.7
 T 191.7
 L 383.3
 E 3.2

Scale
 167 L 1940 5 30

BARRIETT
WOOD
CONE
1/4" = 10'

BARRIETT
CONE
1/4" = 10'

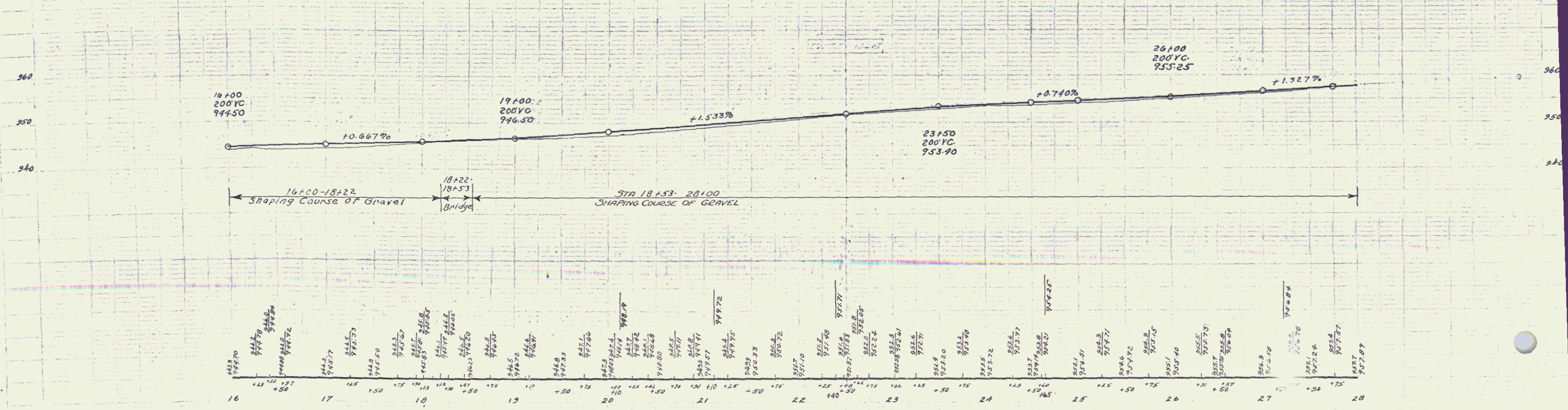
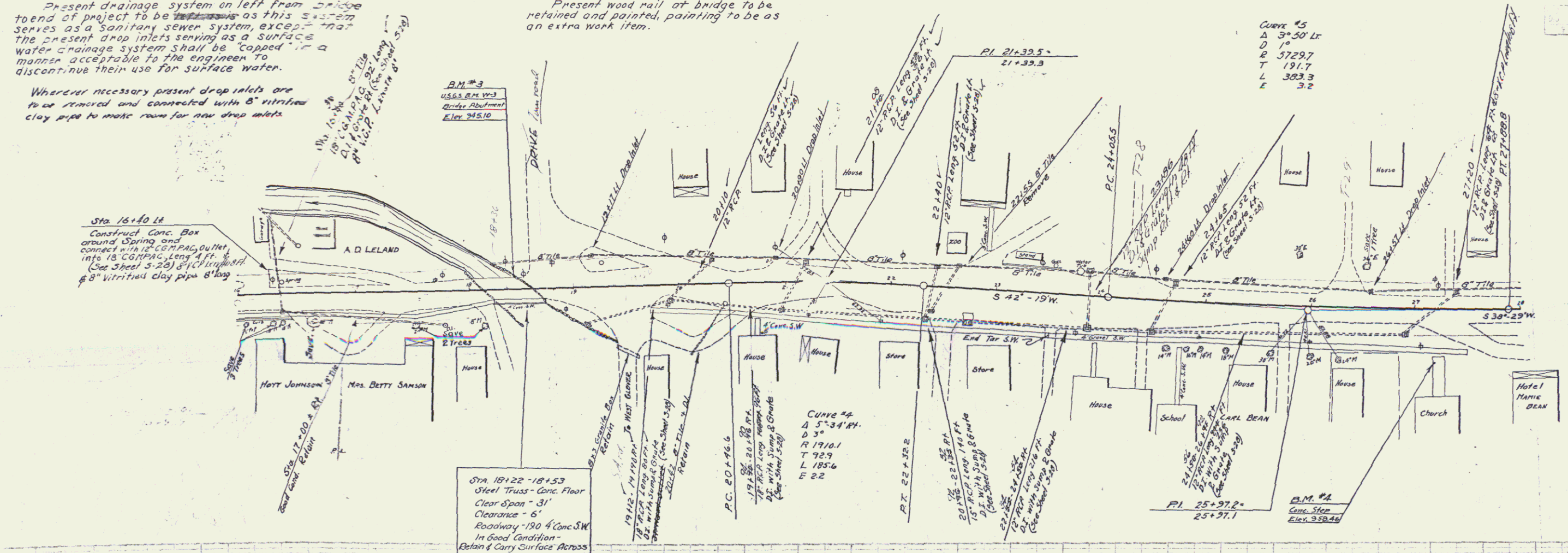

B.M. #3 SPOT ON BRIDGE ABUTMENT 15.5 FT. LT. OF STA. 18+42 ELEV. 945.10
 B.M. #4 SPOT ON CONCRETE STEPS 50 FT. RT. OF STA. 27+16 ELEV. 950.46

Series Plate No. 167 L
 Sheet 5 of 30