

F Street

Stamping Authority  
HURLEY

CONSTRUCT 3 SHOULDER  
734+00 TO 733+00 R/W

INSTRUMENT  
KIND DATE  
B, A, B W.D.O.E. 6-5-52

GRANTOR  
LAMBERT R & CATHERINE RICHARD ST. OF VT.

GRANTEE  
BOOK PAGE DATE  
24 206-07 6-12-52

RECORDED

THREE CABLE GUARD RAIL	Lt.	Rt.
727+78 - 734+92	714	

CONSTRUCT DRIVE  
727+50 LT

WATERFORD ESTATES INC.

Clearing & Grubbing Item 104  
725+00 to 736+10 24  
725+00 to 735+00 Lt

Main Line  
POST 734+500  
Traverse Line  
PI 740+99.2  
Δ 21' 44" LL

BM 88  
Spot on Conc. B-Rail  
Elevation 1206.12

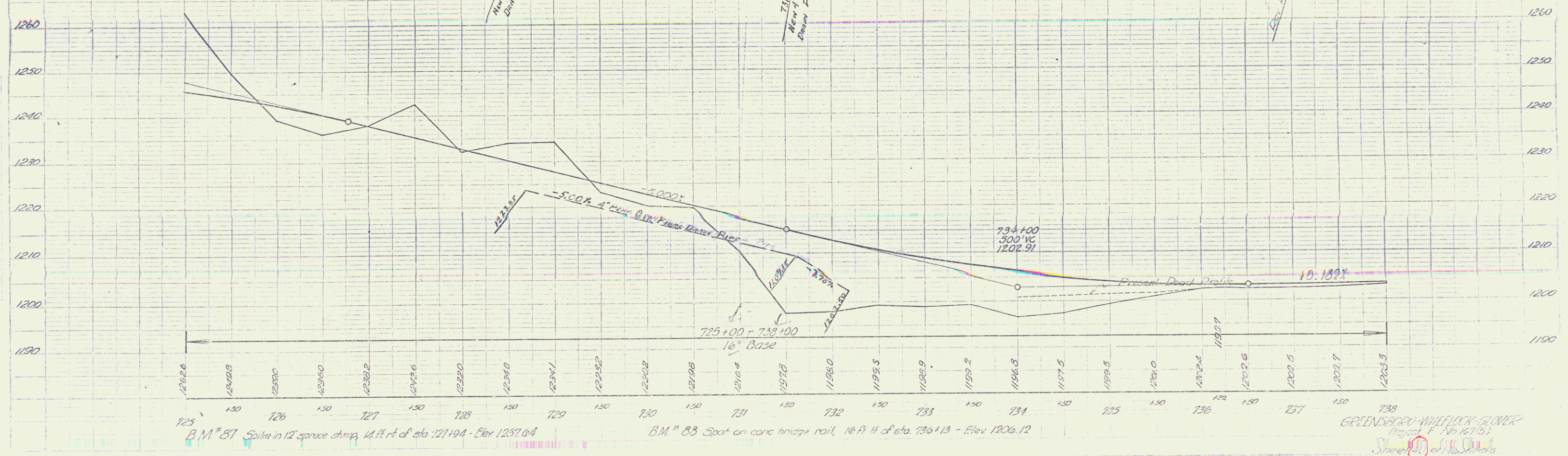

B.M. 87 Spike in 12" spruce stump, 14 ft. rt. of sta. 727+94 - Elev 1237.64

B.M. 83 Spot on conc bridge rail, 16 ft. lt. of sta. 736+13 - Elev 1206.12

GREENSBORO-WILFLOCK-GLONER  
Project E No 16715  
Shirley M. Wilflock