

INDEX OF SHEETS

SHEET NO. 1	TITLE PAGE
" 2	TYPICAL CROSS-SECTION OF IMPROVEMENT STABILIZED GRAVEL BASE COURSE OF OUTBACK ASPHALT WITH SAND SEAL, ITEM 303-B
" 3	CONSTRUCTION DETAILS (CULVERTS)
" 4	CONSTRUCTION DETAILS CD 1 (DITCHES)
" 5	CONSTRUCTION DETAILS CD 2 (TYPICAL GRADING)
" 6	BANKING AND WIDENING TABLES
7-14	EARTHWORK SHEETS
15-17	QUANTITY SHEETS (DRAINAGE)
19	QUANTITY SHEET (ITEMS)
19-41	PLAN AND PROFILE SHEETS
42	STRUCTURE SHEET STA. 447+37.1 (DETAILS)
43-47	CHANNEL SECTIONS
48	STANDARD STRUCTURE SHEET S-40 (BARRICADES, SIGNS AND LIGHTS)
49	STANDARD STRUCTURE SHEET S-40-10 (CABLE GUARD RAIL)
50	STANDARD STRUCTURE SHEET S-53-19 (P.C. R.C.P. DROP INLETS)
51	STANDARD STRUCTURE SHEET S-8-11 (BARRICADES, SIGNS AND LIGHTS)
52-146	CROSS-SECTIONS -

STANDARD STRUCTURE SHEET APPROVED BY THE CHIEF ENGINEER, VERMONT STATE DEPARTMENT OF HIGHWAYS.  
S 40 JUNE 10 1950

STATE OF VERMONT  
STATE HIGHWAY DEPARTMENT

PLAN AND PROFILE OF PROPOSED  
STATE HIGHWAY

TOWNS OF GREENSBORO-WHEELOCK-GLOVER

COUNTIES OF CALEDONIA AND ORLEANS  
GREENSBORO-GLOVER ROAD  
VERMONT ROUTE ~~16~~ NOW 16

Project Name: Greensboro-Wheelock-Glover  
Project # F167(S)  
Route Vt 16  
Pin: 00R576  
Date: 11/05/1951  
Begin. Town: Greensboro  
End. Town: Glover

STATE	NO. OF SHEETS	TOTAL SHEETS
Vt. F167(S)	1	146

BEGINNING AT A POINT 5,273.8 FEET SOUTHWESTERLY OF THE GREENSBORO-WHEELOCK TOWN LINE AND EXTENDING NORTHEASTERLY 30,338.7 FEET.  
LENGTH OF PROJECT 30,338.7 FT. = 5.746 MILES

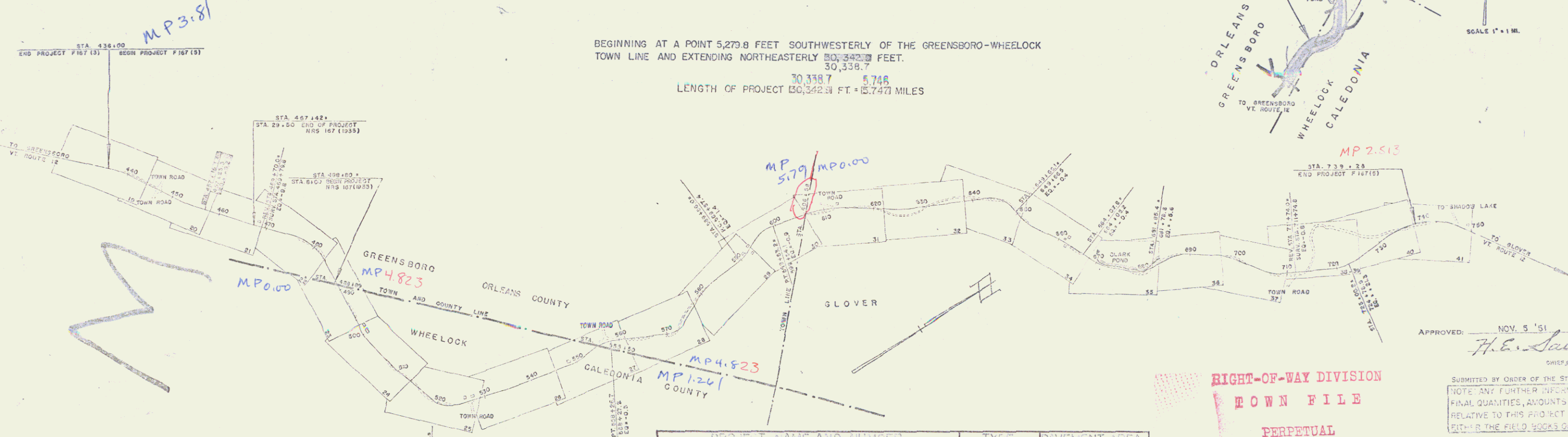

COUNTY LINE	.....
TOWN LINE	.....
FENCE LINE	.....
STONE WALL	.....
UNFENCED PROPERTY	.....
GUARD RAIL	.....
TRAVELED WAY	.....
RAILROAD	.....
RETAINING WALL	.....
C. LINE	.....
SURF LINE	.....
CULVERT	.....
DROP INLET	.....
TROLLEY POLE	.....
POWER POLE	.....
TELEPHONE POLE	.....
THREE	.....
HEAD	.....

PROJECT NAME AND NUMBER	GREENSBORO-WHEELOCK-GLOVER F167(S)
TYPE	STANDARD
PAVEMENT AREA	78,255
RECORD PLANS	
MATERIALS	
CEMENT	ALPHA PORTLAND CEMENT - DORCHESTER, N.Y.
CONC. AGGR.	NARDEAU PLANT, JOHNSON, VT.
REIN. STEEL	VT. STRUCTURAL STEEL CORP. - WINDSOR, VT.
SUB-BASE OF CR. GRAV.	NING PIT, GLOVER, VT.
HAND TOP SET	WHEELOCK PLANT - JOHNSON, VT.
CONTRACTOR	A. L. DOUGHERTY CO.
DESIGNER	W. H. WILSON - A. EASTMAN
CONTRACT DATED	MAY 1952
CONTRACT STARTED	MAY 1952
CONTRACT COMPLETED	AUG 28, 1952
CONTRACT NO.	00R576

RIGHT-OF-WAY DIVISION  
TOWN FILE  
PERPETUAL  
Town of VT 16  
(To Be Returned To R.O.W. Division)

THESE PLANS ARE SUBJECT TO SUCH REVISIONS AS MAY BE REQUIRED BY THE BUREAU OF PUBLIC ROADS - ON THE COMMISSIONER OF HIGHWAYS.

CONSTRUCTION IS TO BE CARRIED ON IN ACCORDANCE WITH THE STANDARD SPECIFICATIONS AND ENGINE SPECIFICATIONS OF 1952 AS APPROVED BY THE BOARD OF PUBLIC ROADS - INCLUDING ALL SUBSEQUENT APPROVED REVISIONS AND SUCH FIELD SPECIFICATIONS AND SPECIAL PROVISIONS AS ARE SUPPLIED WITH THE PLANS.

APPROVED: NOV. 5 '51  
*H. E. Sargent*  
CHIEF ENGINEER

SUBMITTED BY ORDER OF THE STATE HIGHWAY BOARD.  
NOTE: ANY FURTHER INFORMATION CONCERNING FINAL QUANTITIES, AMOUNTS ON OTHER DETAILS RELATIVE TO THIS PROJECT MAY BE FOUND IN EITHER THE FIELD BOOKS OR THE EST. FILE.

DEPARTMENT OF CONSTRUCTION  
BUREAU OF PUBLIC ROADS  
RECOMMENDED FOR APPROVAL  
DATE  
APPROVED

STEARNS R. JENKINS

F 167(S) PLAN  
116