

STA	CULVERT QUANTITIES					GRADE POSTS	
	SIZE	LENG	CONC	STEEL	CRIM	LT	RT
218+71	15"	12'			1.16	3	1
222+87	24"	16'			2.3	13	1

FED. ROAD DIST. NO.	STATE	NRG. PROJ. NO.	YEAR	SHEET NO.	TOTAL SHEETS
9	VT.	142	1933	6	34

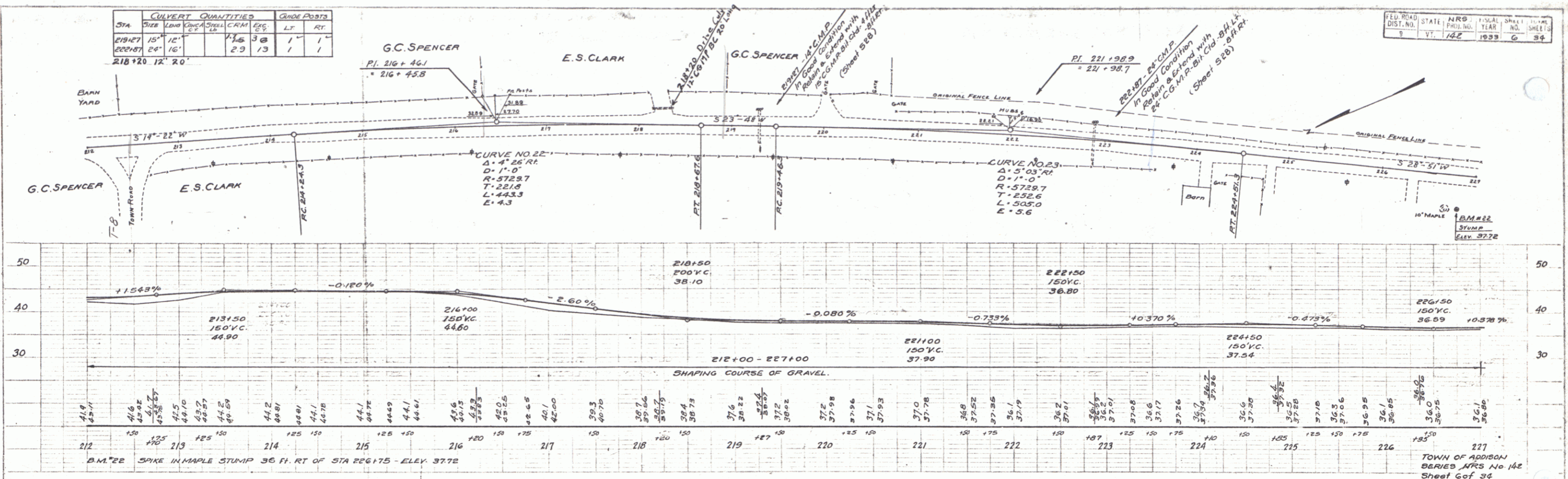

PLAN
NOTES:
1. ALL GRADES TO BE SHOWN IN RED.
2. ALL GRADES TO BE SHOWN IN BLUE.
3. ALL GRADES TO BE SHOWN IN GREEN.
4. ALL GRADES TO BE SHOWN IN BLACK.

STA	CULVERT QUANTITIES					GRADE POSTS	
	SIZE	LENG	CONC	STEEL	CRIM	LT	RT
228+71	15"	12'			1.16	3	1
231+87	24"	16'			2.3	13	1

FED. ROAD DIST. NO.	STATE	NRG. PROJ. NO.	YEAR	SHEET NO.	TOTAL SHEETS
9	VT.	142	1933	6A	34

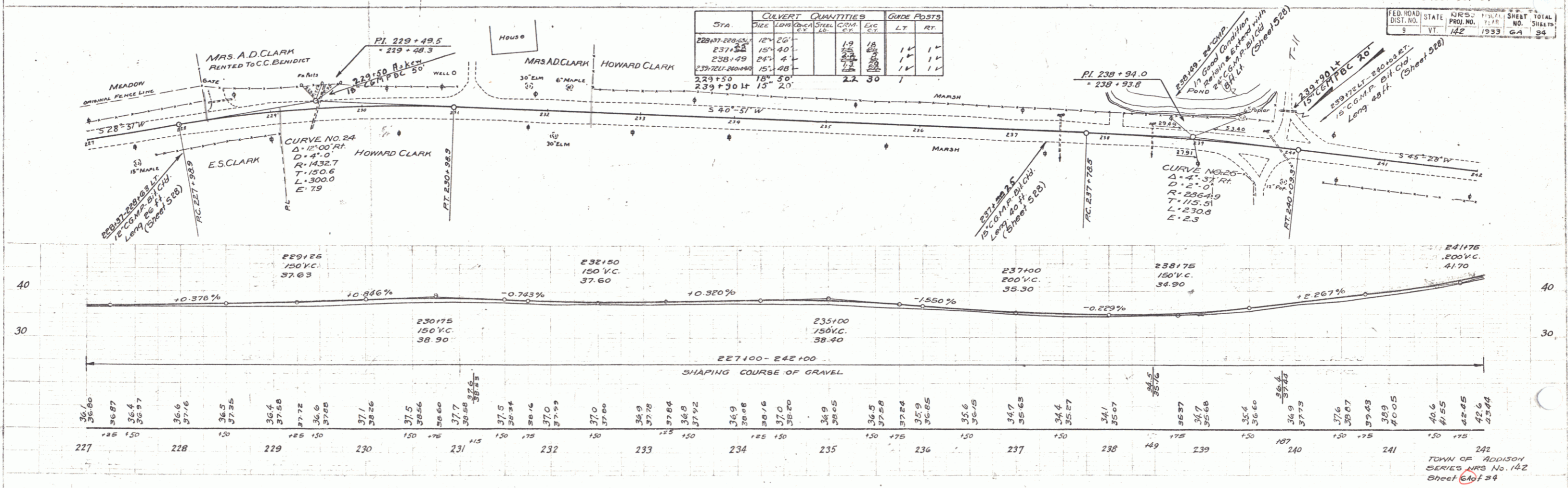

PLAN
NOTES:
1. ALL GRADES TO BE SHOWN IN RED.
2. ALL GRADES TO BE SHOWN IN BLUE.
3. ALL GRADES TO BE SHOWN IN GREEN.
4. ALL GRADES TO BE SHOWN IN BLACK.