

Route: VT 22A  
 Town: Orwell  
 Date: 01/08/1936  
 Project: DWA 102L  
 Pin: 00561

DATE	BY	REVISION
1936		

Note  
 B.M. 2 is 150'  
 upstream from  
 station 16+00

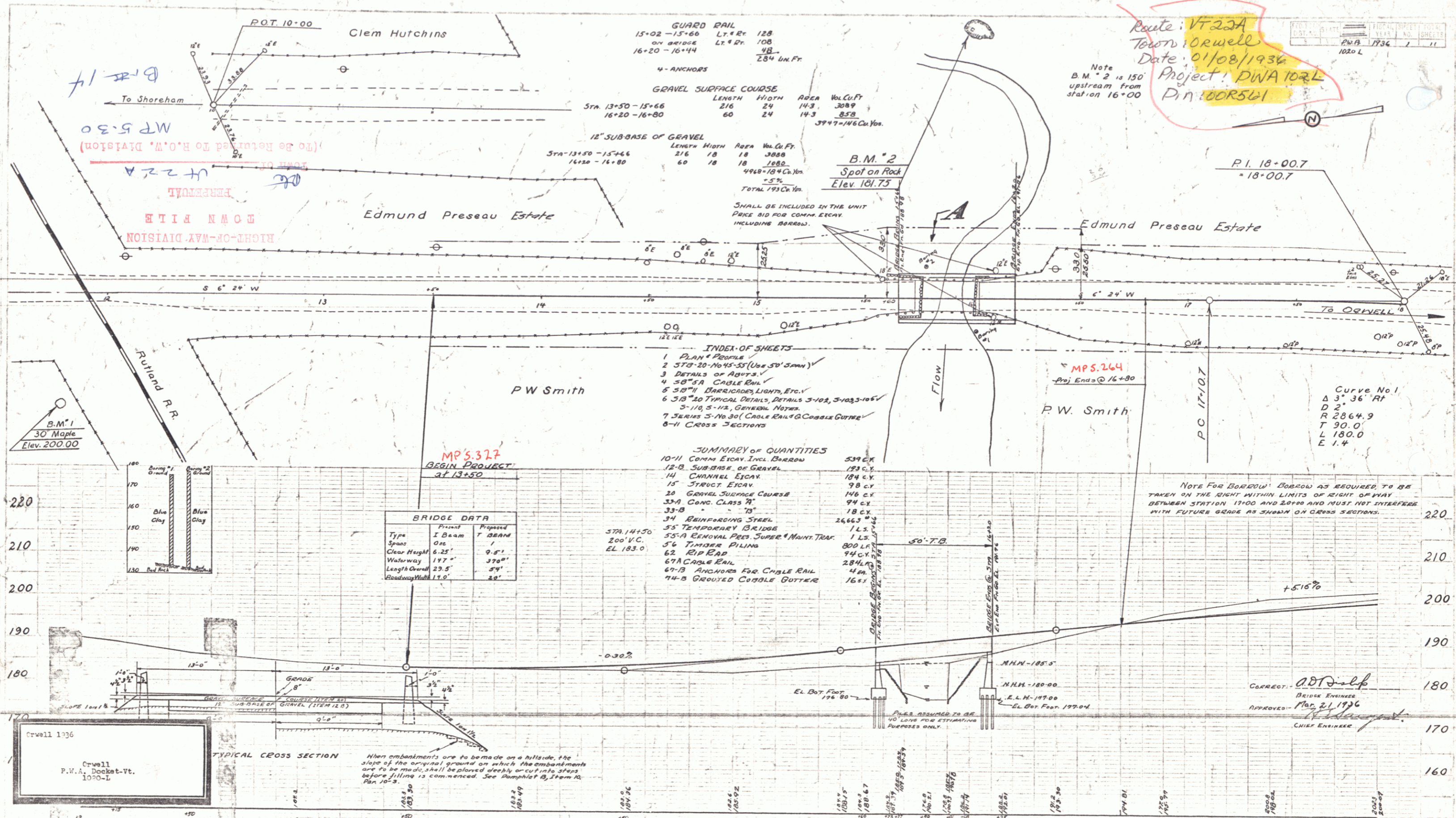

GUARD RAIL

15+02 - 15+60	LT. 4 FT	128
16+20 - 16+44	LT. 2 FT	108
		48
		284 LIN. FT.

GRAVEL SURFACE COURSE

STATION	LENGTH	WIDTH	AREA	VOL. CU. FT.
13+50 - 15+66	216	24	5184	3089
16+20 - 16+80	60	24	1440	858
				3947-146 Cu. Yds.

18" SUBBASE OF GRAVEL

STATION	LENGTH	WIDTH	AREA	VOL. CU. FT.
13+50 - 15+66	216	18	3888	2380
16+20 - 16+80	60	18	1080	675
				4968-184 Cu. Yds.
				TOTAL 7915 Cu. Yds.

SHALL BE INCLUDED IN THE UNIT PRICE BID FOR COMM. EXCAV. INCLUDING BORROW.

- INDEX OF SHEETS
- 1 PLAN & PROFILES
  - 2 STA. 13+50 - 16+80 (Use 50' STATION)
  - 3 DETAILS OF BRIDGE
  - 4 50" SA CABLE RAIL
  - 5 50" B BARRICADES, LIGHTS, ETC.
  - 6 50" B TYPICAL DETAILS, DETAILS 3-102, 3-103-105
  - 7 50" B 3" NO. 301 CABLE RAIL & COBBLE GUTTER
  - 8-11 CROSS SECTIONS

SUMMARY OF QUANTITIES

10-11 CONN. EXCAV. INCL. BORROW	534 C.Y.
12-13 SUBBASE OF GRAVEL	4968 C.Y.
14 CHANNEL EXCAV.	184 C.Y.
15 STRUCT. EXCAV.	98 C.Y.
20 GRAVEL SURFACE COURSE	146 C.Y.
33-A CONG. CLASS 71	94 C.Y.
33-B "	18 C.Y.
34 REINFORCING STEEL	2466.3 LB.
35 TEMPORARY BRIDGES	1 L.S.
55-A REMOVAL PRES. SUPER. MAINT. TRAV.	1 L.S.
56 TENDER PILING	200 LK.
62 RIP RAP	94 C.Y.
67-A CABLE RAIL	284 LK.
67-B ANCHORS FOR CABLE RAIL	4 AN.
74-B GROUTED COBBLE GUTTER	16 LK.

BRIDGE DATA

Type	Present	Proposed
Span	1 Beam	7 BEAM
Clear Height	6.25'	9.5'
Waterway	147"	370"
Length Overall	23.5'	27'
Grade	11.0'	2'

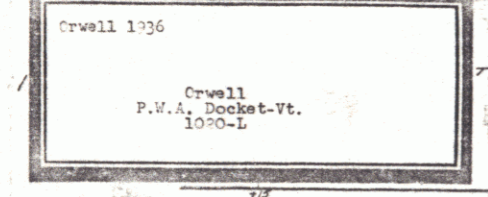
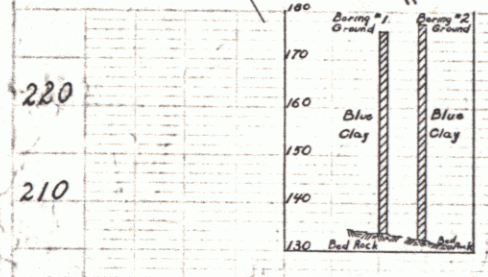

BRIDGE DATA IS FOR INFORMATION ONLY AND IS NOT GUARANTEED TO BE CORRECT.

B.M. 1 Spike in Root of 30' Maple 50' Rt of Sta. 11+80 Elev. 200.00  
 B.M. 2 Spot painted on Boulder 150' upstream from Sta. 16+00 Elev. 181.75

PARCEL INSTRUMENT	DATE	GRANTOR	GRANTEE	RECORDED	REMARKS
A	Q.C.D.	4-27-36 EDWARD PRESEAU ESTATE	TRAV. VI.	BOOK 145 DATE 4-27-36	

ORWELL  
 P.H.A. - DOCKET - VT.  
 1020-L

SHEET NO. 11 OF 11 SHEETS

DIST. F 3 PLANS

Orwell 36