

DATE	BY	
11/17/67	W.P.	
DESIGNED	BY	
IN CHARGE	BY	
CHECKED	BY	
REVISIONS		
NO.	DATE	DESCRIPTION
1		
2		
3		
4		
5		

DATE	BY	
11/17/67	W.P.	
DESIGNED	BY	
IN CHARGE	BY	
CHECKED	BY	
REVISIONS		
NO.	DATE	DESCRIPTION
1		
2		
3		
4		
5		

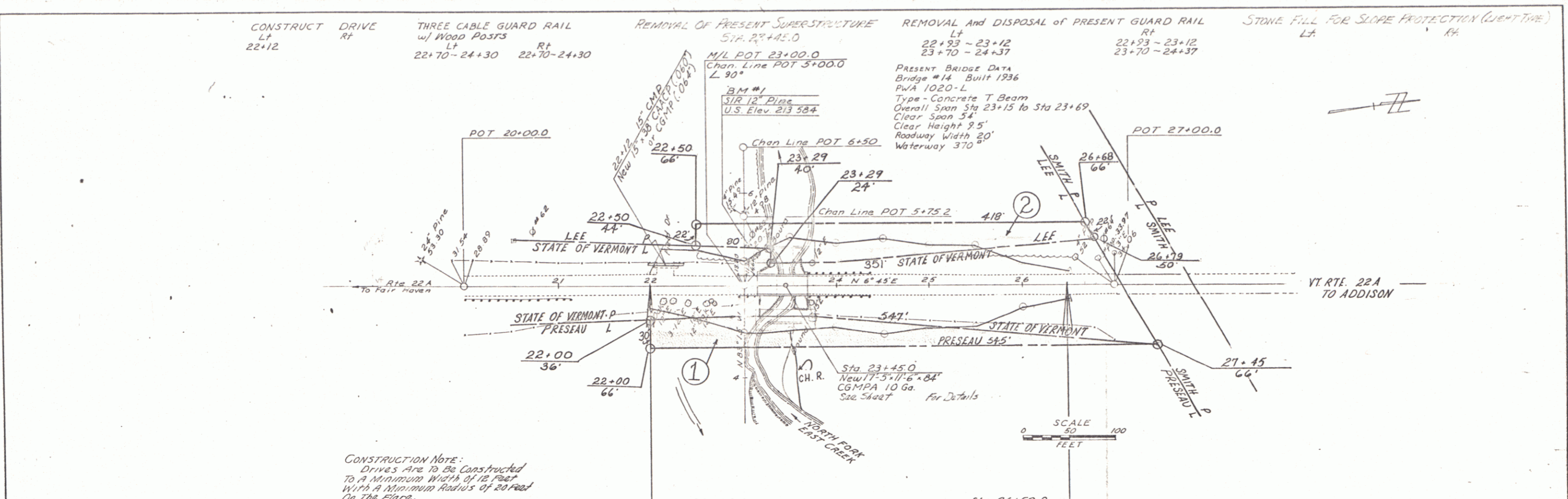

CONSTRUCTION NOTE:
Drives #1 to #6 Constructed
to a minimum width of 12 feet
with a minimum radius of 20 feet
on the flare.

Sta. 22+00.0 BEGIN PROJECT RS-0159(A)
Construct Satisfactory Approach

Sta. 26+50.0 END PROJECT RS-0159(A)
Construct Satisfactory Approach

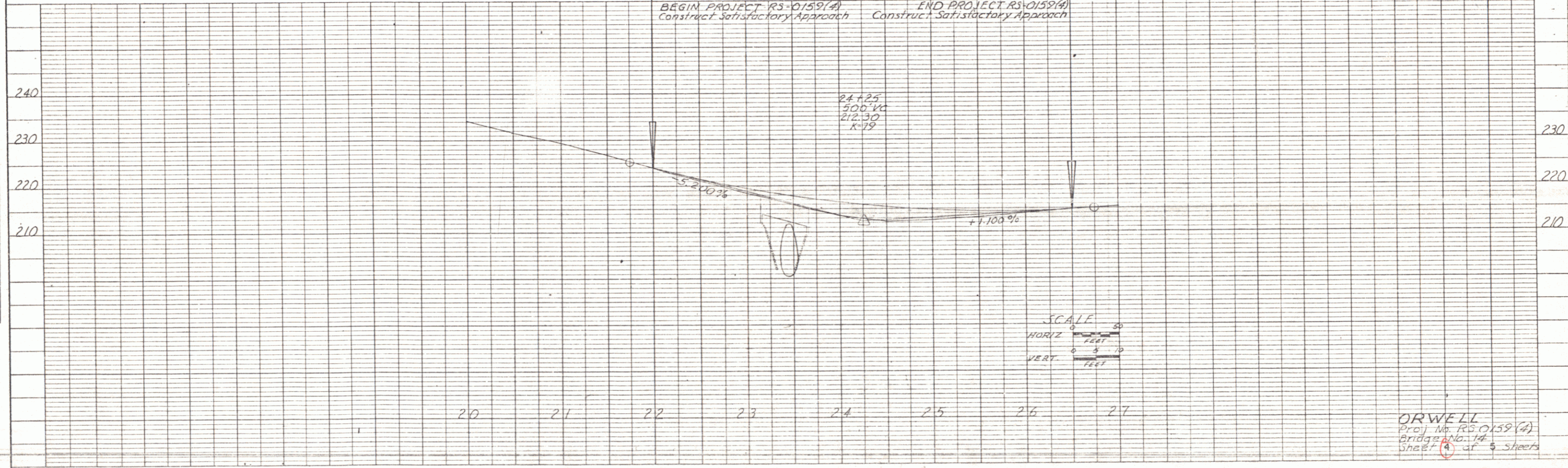

ORWELL
Proj. No. RS-0159(A)
Bridge No. 14
Sheet 4 of 5 Sheets