

**GUARD RAIL REQUIRED**  
 ON LEFT  
 Sta 0+12 to Sta 0+12 Length 24ft  
 Sta 1+12 to Sta 1+12 Length 24ft  
 ON RIGHT  
 Sta 0+12 to Sta 1+12 Length 128ft  
 Sta 1+12 to Sta 1+12 Length 24ft  
**TOTAL THIS SHEET 400 FT**

**NEW CULVERTS REQUIRED**  
 Sta 0+00 16" Cast Iron Pipe Length 30ft  
 Sta 1+00 16" Cast Iron Pipe Length 30ft  
 1-2x5 Concrete 20cu yd  
 1-2x5 Concrete 20cu yd

**STONE BASE REQUIRED**  
 Sta 0+00 to Sta 3+50 Length 350ft  
**TOTAL 350 FT**

**DRY MASONRY WALL REQUIRED**  
 Sta 0+00 to Sta 1+00 Length 100ft

Curve #5  
 Δ: 114.45  
 D: 114.45  
 T: 98.2  
 L: 193.8  
 A: 51  
 R: 935

*Try Tangent From  
 Here to  
 Foot of Hill  
 Heavy Side Cut & Easement*

*Try not over 3 or 4°*

**POOR ORIGINAL COPY**

*Proposed  
 Grade Line*

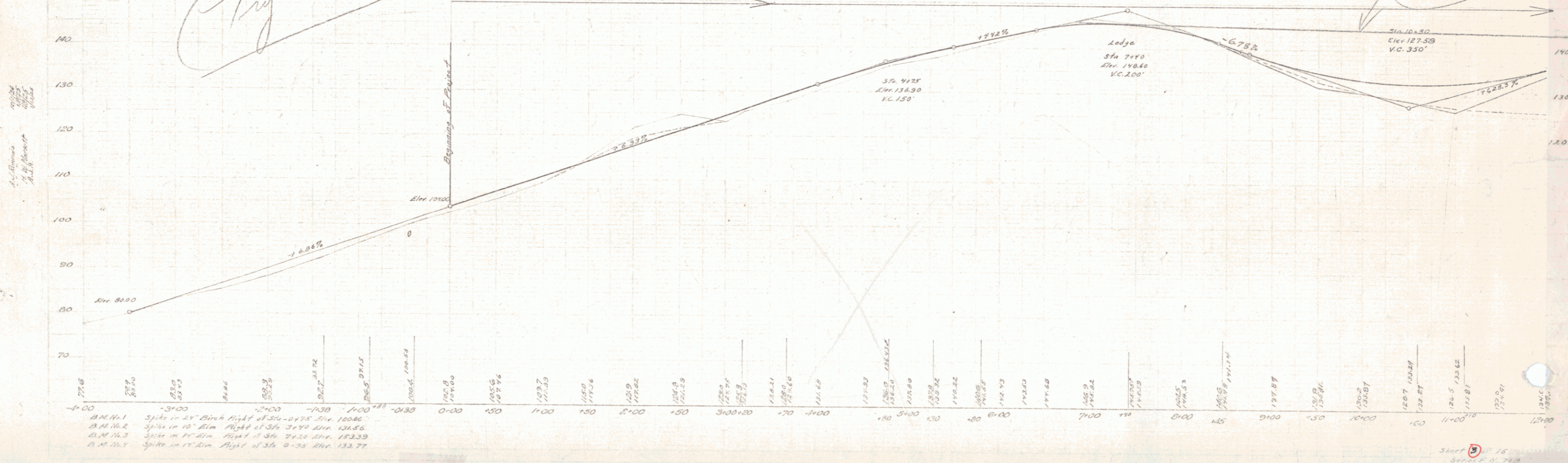

Station	Elevation
0+00	77.6
0+10	78.7
0+20	81.0
0+30	83.0
0+40	85.5
0+50	88.6
0+60	92.2
0+70	96.5
0+80	101.5
0+90	107.2
1+00	113.6
1+10	120.7
1+20	128.5
1+30	137.0
1+40	146.2
1+50	156.1
1+60	166.7
1+70	178.0
1+80	190.0
1+90	202.7
2+00	217.0
2+10	232.0
2+20	247.7
2+30	264.2
2+40	281.5
2+50	299.6
2+60	318.5
2+70	338.2
2+80	358.7
2+90	380.0
3+00	402.0
3+10	424.7
3+20	448.0
3+30	472.0
3+40	496.7
3+50	522.0
3+60	547.7
3+70	574.0
3+80	600.7
3+90	628.0
4+00	655.7
4+10	684.0
4+20	712.7
4+30	742.0
4+40	772.0
4+50	802.7
4+60	834.0
4+70	866.0
4+80	898.7
4+90	932.0
5+00	966.0
5+10	1000.7
5+20	1036.0
5+30	1072.0
5+40	1108.7
5+50	1146.0
5+60	1184.0
5+70	1222.7
5+80	1262.0
5+90	1302.0
6+00	1342.7
6+10	1384.0
6+20	1426.0
6+30	1468.7
6+40	1512.0
6+50	1556.0
6+60	1600.7
6+70	1646.0
6+80	1692.0
6+90	1738.7
7+00	1786.0
7+10	1834.0
7+20	1882.7
7+30	1932.0
7+40	1982.0
7+50	2032.7
7+60	2084.0
7+70	2136.0
7+80	2188.7
7+90	2242.0
8+00	2296.0
8+10	2350.7
8+20	2406.0
8+30	2462.0
8+40	2518.7
8+50	2576.0
8+60	2634.0
8+70	2692.7
8+80	2752.0
8+90	2812.0
9+00	2872.7
9+10	2934.0
9+20	2996.0
9+30	3058.7
9+40	3122.0
9+50	3186.0
9+60	3250.7
9+70	3316.0
9+80	3382.0
9+90	3448.7
10+00	3516.0
10+10	3584.0
10+20	3652.7
10+30	3722.0
10+40	3792.0
10+50	3862.7
10+60	3934.0
10+70	4006.0
10+80	4078.7
10+90	4152.0
11+00	4226.0
11+10	4296.0
11+20	4366.7
11+30	4438.0
11+40	4510.0
11+50	4582.7
11+60	4656.0
11+70	4730.0
11+80	4804.7
11+90	4880.0
12+00	4956.0