

INDEX OF SHEETS

SHEET NO.	TITLE PAGE
1	TITLE PAGE
2	TYPICAL CROSS-SECTION OF IMPROVEMENT (2 1/2" CRUSHED STONE MIXED-IN-PLACE SURFACE COURSE ITEM 27, WITH CUTBACK ASPHALT, ITEM 31.
3-7	PLAN AND PROFILE
8	STANDARD STRUCTURE SHEET S-28 CREOSOTED TIMBER CURB, ITEM 98 & METAL D.I., ITEM 90
9	" " S-30 CABLE GUARD RAIL
10	" " S-30A STANDARD UNDERDRAIN
11	" " S-40 BARRICADES, SIGNS & LIGHTS
12	" " S-41 ROUNDING OF SLOPES
13-21	CROSS SECTIONS

STANDARD STRUCTURE SHEETS APPROVED BY THE CHIEF ENGINEER:

"	"	"	S-28 APPROVED	4-26-41
"	"	"	S-30A "	4-19-41
"	"	"	S-40 "	9-5-40
"	"	"	S-30 "	8-15-34

STATE OF VERMONT
STATE HIGHWAY DEPARTMENT

PLAN AND PROFILE OF PROPOSED
STATE HIGHWAY
FEDERAL AID PROJECT

TOWN OF WATERFORD

VERMONT ROUTE 18

ST. JOHNSBURY, VT.-LITTLETON, N.H. ROAD

BEGINNING AT A POINT 3.349 MILES NORTHERLY OF THE INTERSTATE
BRIDGE PROJECT 263 & EXTENDING 1.400 MILES SOUTHERLY

LENGTH OF PROJECT: 7393.6 FEET=1.400 MILES

FED. ROAD DIST. NO.	STATE	FED. AID PROJ. NO.	FISCAL YEAR	SHEET NO.	TOTAL SHEETS
9	Vt.	70(2)	1942	1	21

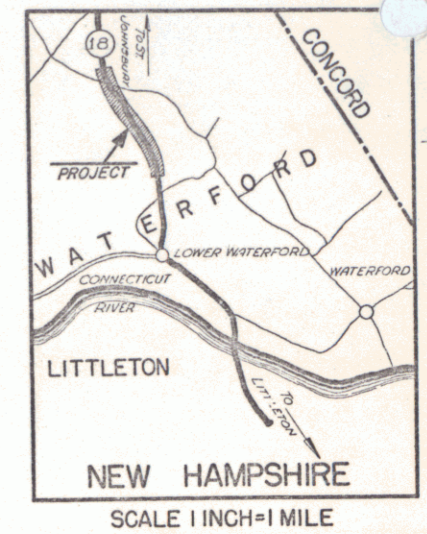

(To Be Returned To R.O.W. Division)
Town of Waterford
PERMIT
TOWN FILE
RIGHT-OF-WAY DIVISION

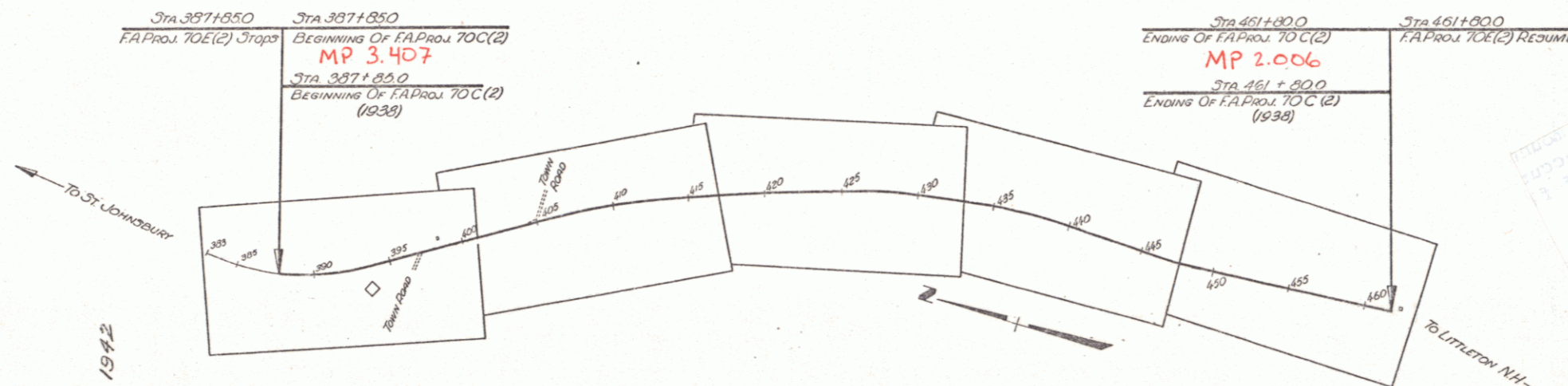

COUNTY LINE	---
TOWN LINE	---
FENCE LINE	---
STONE WALL	---
UNFENCED PROPERTY	---
GUARD RAIL	---
TRAVELED WAY	---
RAILROAD	---
RETAINING WALL	---
CENTER LINE	---
SURVEY LINE	---
CULVERT	---
DROP INLET	---
TROLLEY POLE	---
POWER POLE	---
TELEPHONE POLE	---
TREES	---
HEDGE	---

GROUND ELEVATION	DATUM	LINE
---	---	---
GRADE ELEVATION	DATUM	LINE
---	---	---

CURVE DATA

DEFLECTION ANGLE	Δ
DEGREE OF CURVE	D
RADIUS OF CURVE	R
TANGENT DISTANCE	T
LENGTH OF CURVE	L
EXTERNAL DISTANCE	E
POINT OF INTERSECTION	P. I.
POINT OF CURVE	P. C.
POINT OF TANGENT	P. T.
POINT ON TANGENT	P. O. T.

SCALES

TITLE	1"=500'
TYPICAL	1"=2'
PLAN	1"=50'
PROFILE HORIZONTAL	1"=50'
PROFILE VERTICAL	1"=10'
CROSS SECTIONS	1"=5'

THESE PLANS ARE SUBJECT TO SUCH REVISIONS AS MAY BE REQUIRED BY THE PUBLIC ROADS ADMINISTRATION OR THE COMMISSIONER OF HIGHWAYS.

CONSTRUCTION IS TO BE CARRIED ON IN ACCORDANCE WITH THE PLANS AND THE STANDARD ROAD AND BRIDGE SPECIFICATIONS OF 1935, AS APPROVED DECEMBER 26TH, 1936 BY THE PUBLIC ROADS ADMINISTRATION, INCLUDING ALL SUBSEQUENT APPROVED REVISIONS AND SUCH REVISED SPECIFICATIONS AND SPECIAL PROVISIONS AS ARE SUBMITTED WITH THE PLANS.

APPROVED July 2 1941 R. J. [Signature] ROAD ENGINEER	APPROVED June 23 1941 [Signature] DISTRICT HIGHWAY COMMISSIONER	SERIES F.A.P. NO 70(2) FILED SHEET 1 OF 21
--	---	---

RECORD PLAN
By
A. C. Birnie 5/2/42

APPROVED: July 2 1941
[Signature]
COMMISSIONER OF HIGHWAYS
SUBMITTED BY ORDER OF THE STATE HIGHWAY BOARD

P.in # 00R554

RECOMMENDED FOR APPROVAL

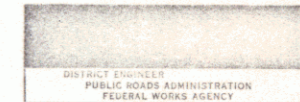

APPROVED

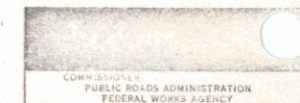

DIST # 2 1

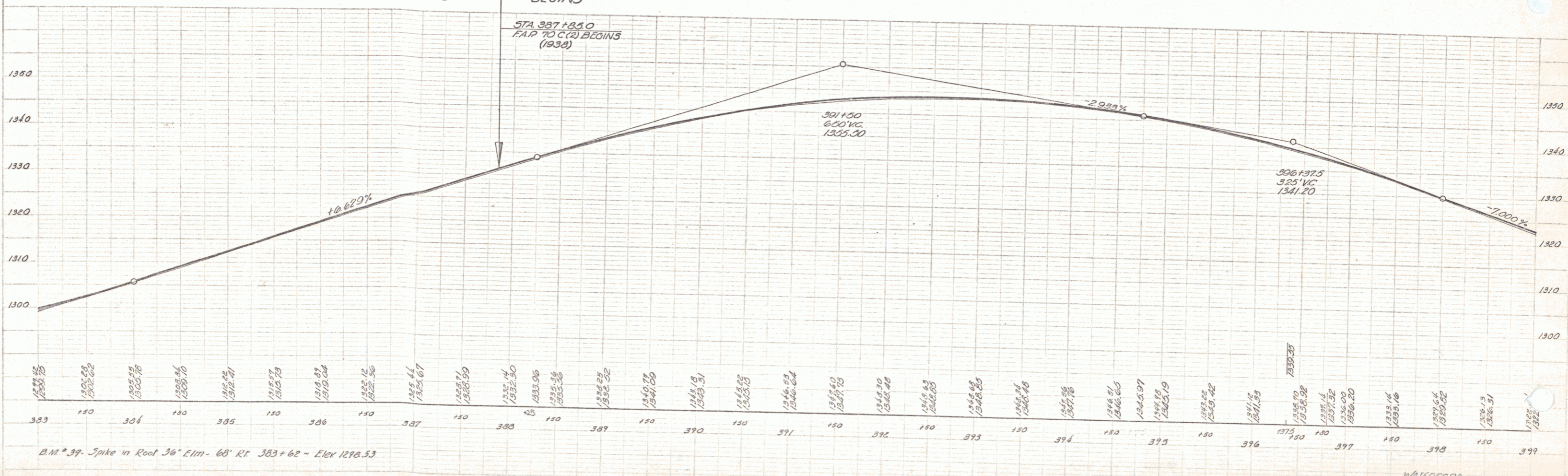
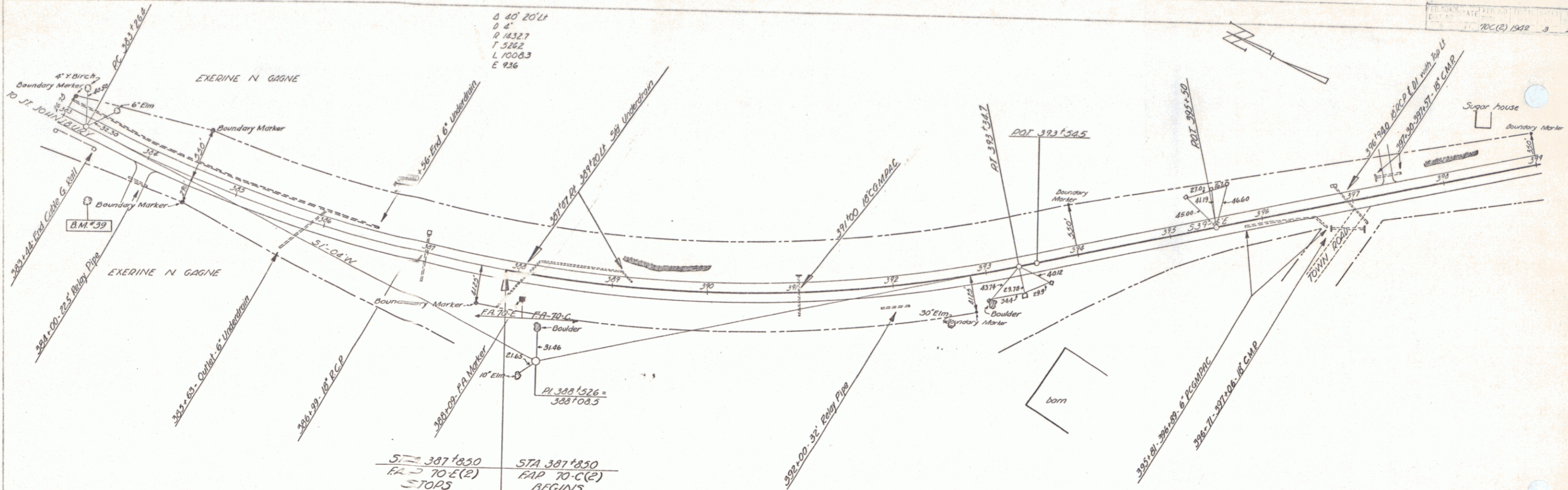

PLAN
 DATE: 10/1/50
 DRAWN BY: J. W. BROWN
 CHECKED BY: J. W. BROWN

PROFILE
 DATE: 10/1/50
 DRAWN BY: J. W. BROWN
 CHECKED BY: J. W. BROWN

B.M. #39. Spike in Roof 36' Elm. 60' Rt. 383+62 - Elev 1298.53

WATERFORD
 SERIES F&P NO 70 C(2)
 SHEET 21

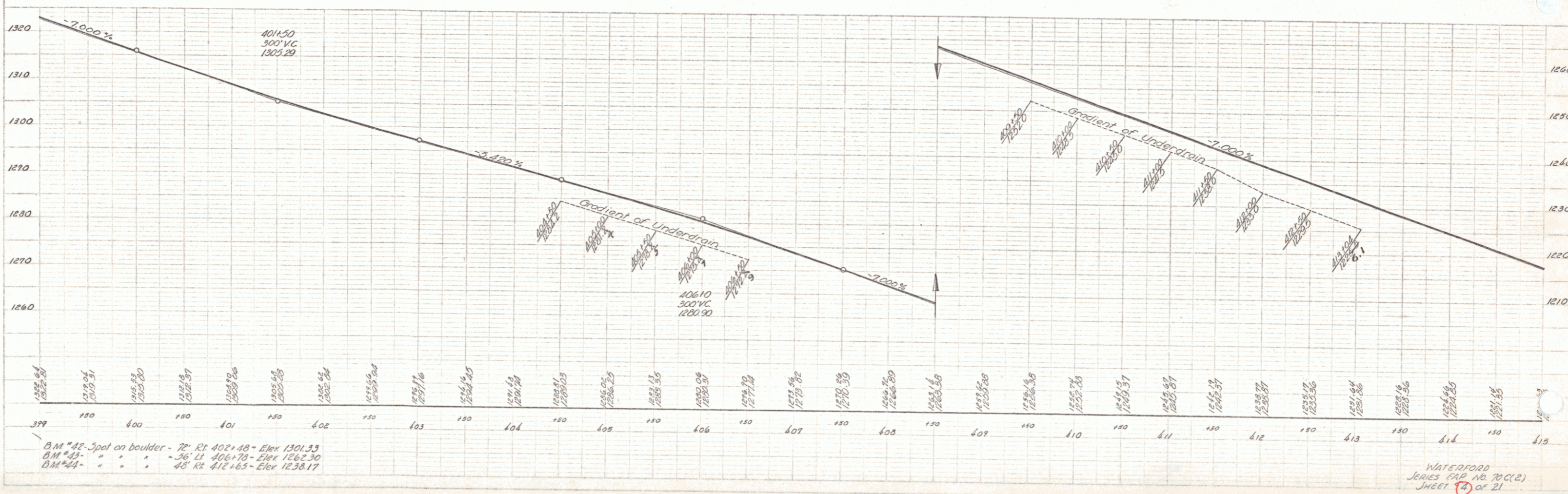
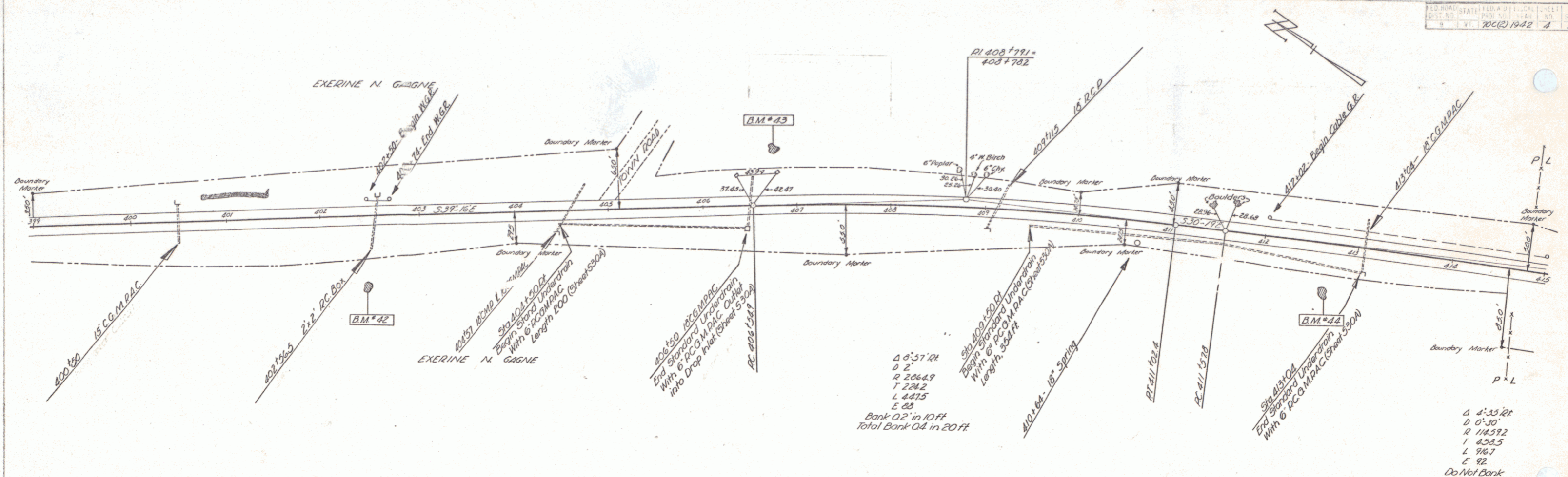

B.M. #42 - Spot on boulder - 70' Rt 402+48 - Elev 1301.33
 B.M. #43 - " " - 56' Lt 406+70 - Elev 1262.30
 B.M. #24 - " " - 48' Rt 412+63 - Elev 1238.17

WATERFORD
 SERIES MAP NO. 70(C) 2
 SHEET 21 OF 21

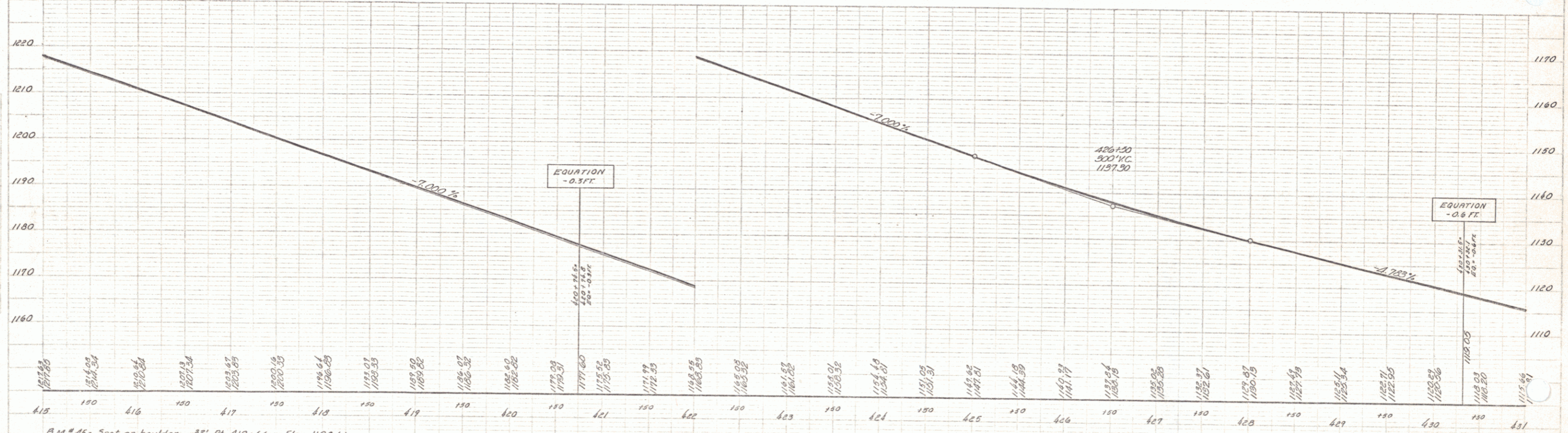
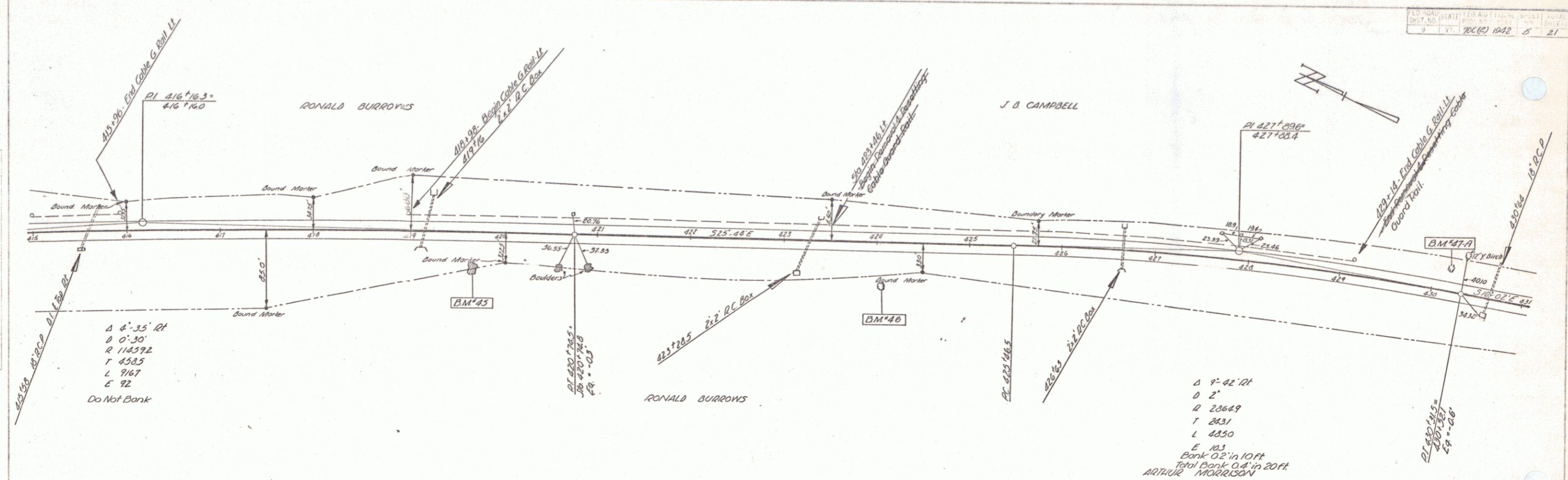

B.M. 45 - Spot on boulder - 32' RI 419+66 - Elev 1192.61
 B.M. 46 - Spike in Root - 15' White Birch - 42' RI 424+05 - Elev 1196.94
 B.M. 47 - " " " " 10' 31' Imp - 32' LI 430+17 - Elev 1119.31

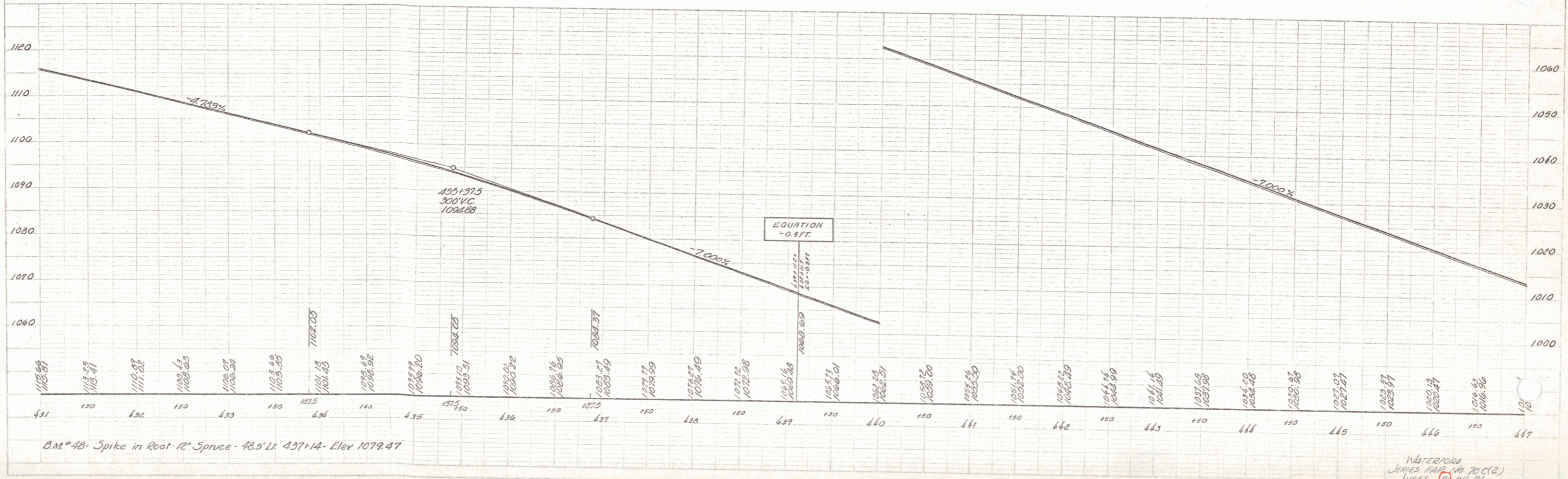
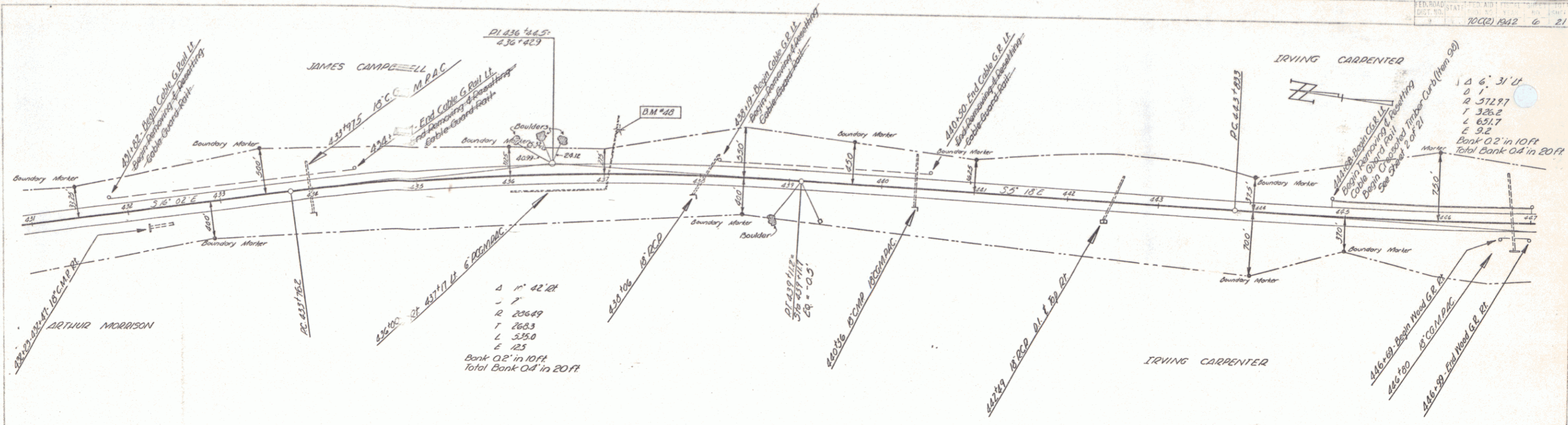

PLAN
 DATE
 BY
 CHECKED
 APPROVED

PROFILE
 DATE
 BY
 CHECKED
 APPROVED

WATERFORD
 JAMES CAMPBELL
 SHEET 21 OF 21

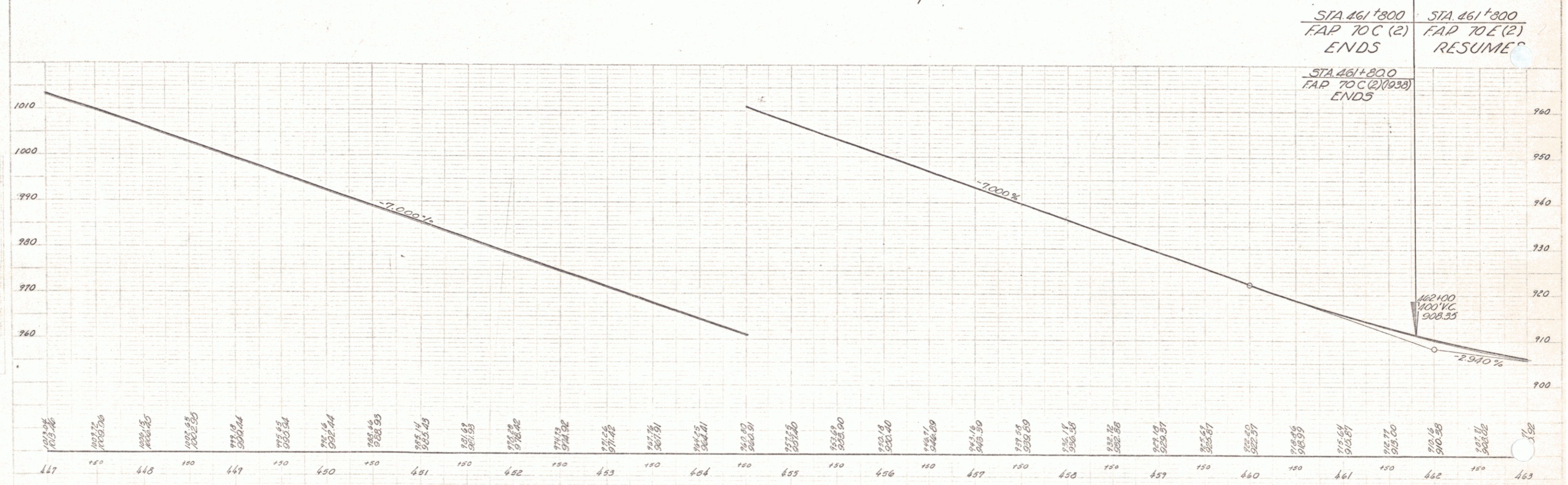
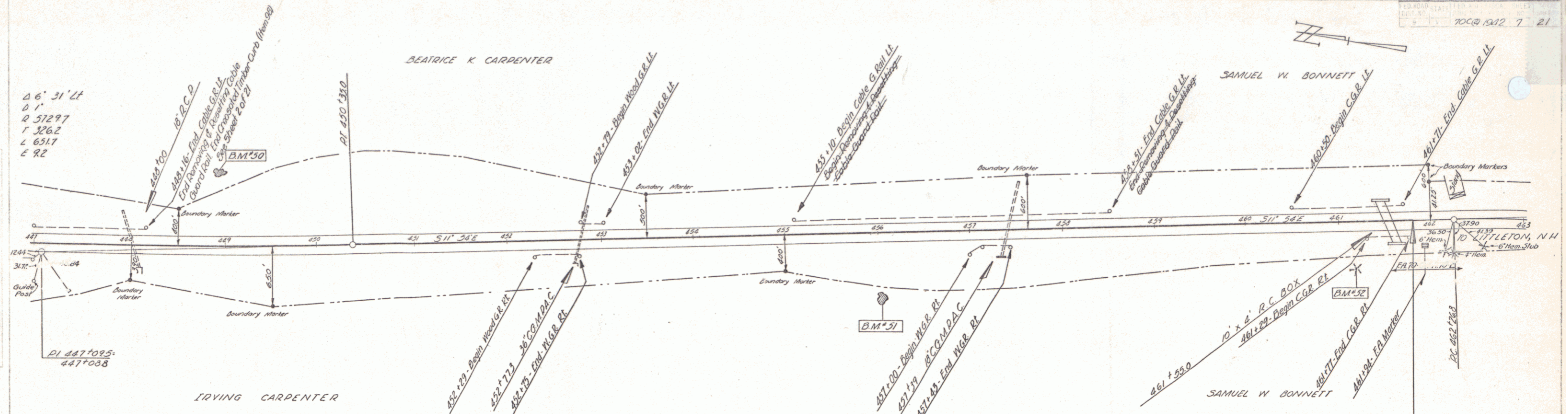

B.M. 50 - Spot on boulder 76' Lt 448+95 - Elev 996.57
 B.M. 51 - " " " 66' Rt 456+02 - Elev 948.69
 B.M. 52 - Spike in Root 10' Balsam 51' Rt 461+17 - Elev 913.35

WATERFORD
 JERES F&P No 70C(2)
 SHEET 7 OF 21