

PARCEL	INSTRUMENT	DATE	GRANTOR	GRANTEE	RECORDED	REMARKS
A-B-C-D	ADMINISTRATIVE	6-12-37	FORNIA LAVATURE ESTATE	51 OF 1/2	8005	WATERED
A-B	O.C.D.	7-7-37	PETER C. GLOECKMAN	LEWIS	25	10-2-37 40 30110 20 80000 8 90322,00
A-B	H.O.	7-15-37	W.E. DOUGLAS	"	25	155-6 7-29-37 70 332100 70 3361,00
C-C-D	FRONT OTTOMAN	6-7-38	SAVING BANK	WATERGARDEN	"	165-6 7-29-37 30511-50
#6	RELEASE	6-7-38	R.C. LEWIS	"	"	DITCH AT 326+15 (16)

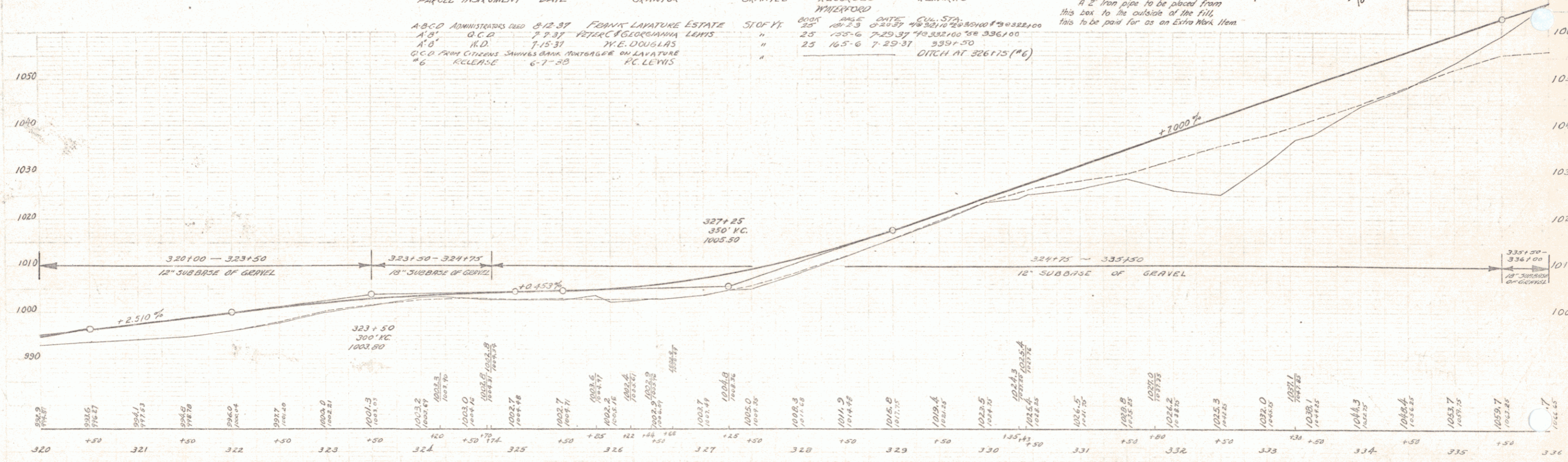

BM #32 3.1 R 30' Pinc 27' 1/2 34 329105 Elev 1023.21  
 BM #33 3.1 R 12' V. G. 36.5 1/2 333174 Elev 1047.71

SERIES FAR NO 70E  
 SHEET 10 OF 106