

INDEX OF SHEETS

SHEET NO.	TITLE PAGE
1	TITLE PAGE
2	TYPICAL CROSS-SECTION OF IMPROVEMENT
3	BANKING AND WIDENING TABLES
4-21	PLAN AND PROFILE SHEETS
22	DETAILS OF EXTENSION OF SLAB BRIDGE STR. 467-46
23	DETAILS OF 4x6 R.C. BOX STR. 536-40
24	STANDARD STRUCTURE SHEET 5-28
25	" " " " 5-29
26	" " " " 5-30
27	" " " " 5-31
28	" " " " 5-35
29	" " " " 5B-1
30	" " " " 5-40

STANDARD STRUCTURE SHEETS APPROVED BY THE CHIEF ENGINEER

SHEETS 5-28-3-29 July 15, 1933
 SHEETS 5-30-5-31 August 15, 1933
 SHEET 5-35 July 25, 1934

STATE OF VERMONT
 STATE HIGHWAY DEPARTMENT

PLAN AND PROFILE OF PROPOSED
 STATE HIGHWAY

TOWNS OF ST. JOHNSBURY & WATERFORD

ST. JOHNSBURY VT. - LITTLETON NH. ROAD

BEGINNING AT A POINT 0.201 MILES NORTHERLY OF THE ST. JOHNSBURY-WATERFORD TOWN LINE AND EXTENDING SOUTHERLY 4.163 MILES EXCLUDING F.A. PROJECTS 70B-A-C-D (CONTRACT 2)

LENGTH OF PROJECT 21,983.0 FT. = 4.163 MILES

POOR ORIGINAL COPY

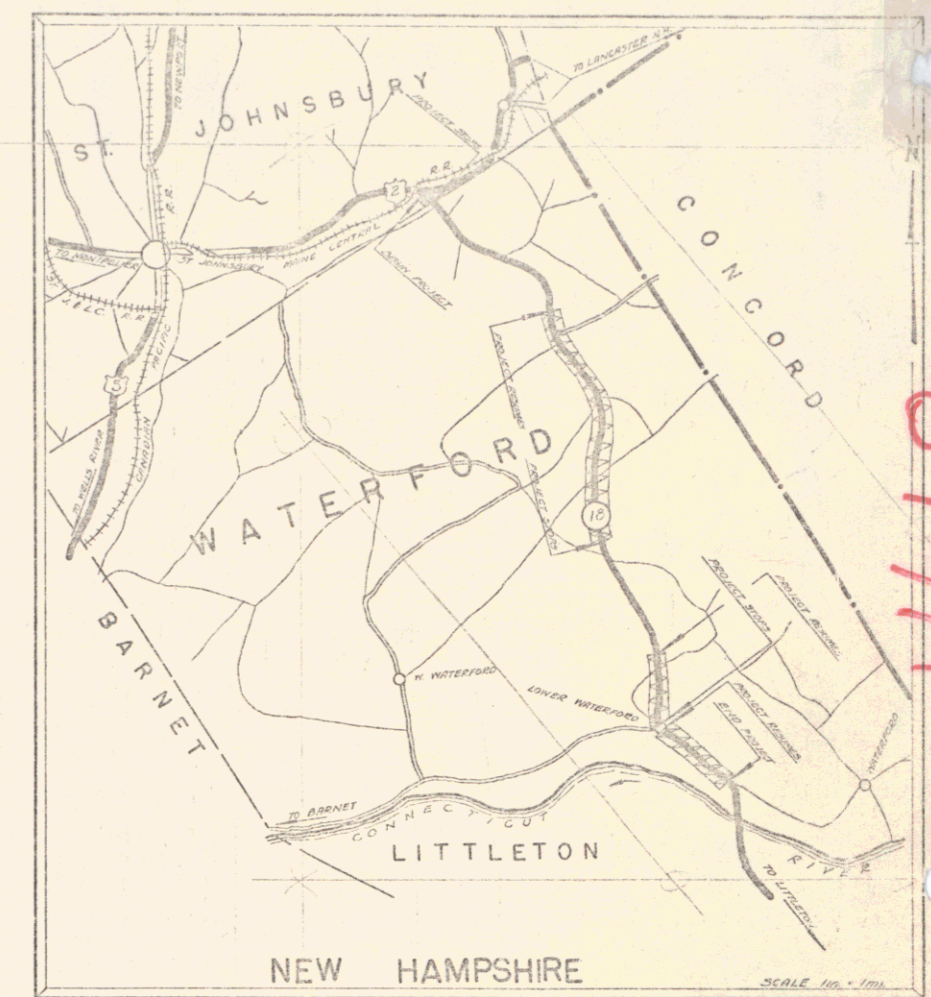

NO. 18
 PERPETUAL
 RIGHT-OF-WAY DIVISION

NO. 18
 PERPETUAL
 RIGHT-OF-WAY DIVISION

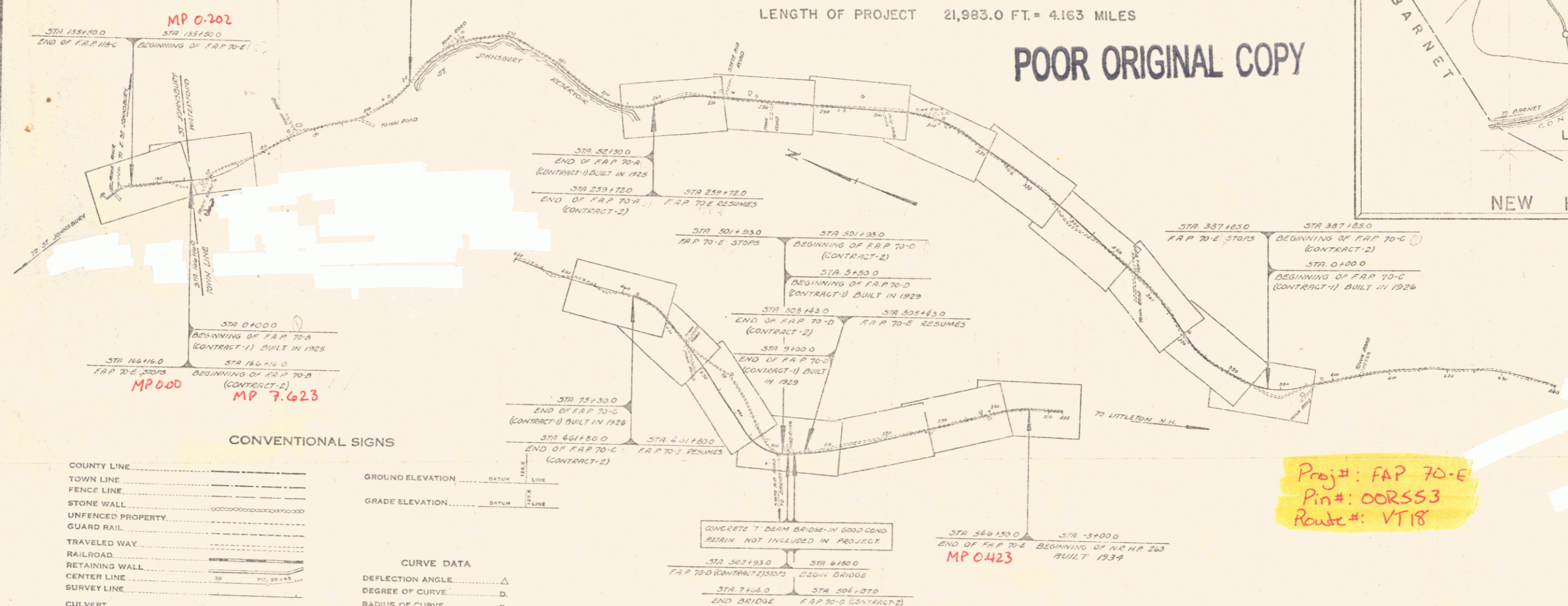

CONVENTIONAL SIGNS

COUNTY LINE	---
TOWN LINE	---
FENCE LINE	---
STONE WALL	---
UNFENCED PROPERTY	---
GUARD RAIL	---
TRAVELED WAY	---
RAILROAD	---
RETAINING WALL	---
CENTER LINE	---
SURVEY LINE	---
CULVERT	---
DROP INLET	---
TROLLEY POLE	---
POWER POLE	---
TELEPHONE POLE	---
TREES	---
HEDGE	---

CURVE DATA

DEFLECTION ANGLE	Δ
DEGREE OF CURVE	D
RADIUS OF CURVE	R
TANGENT DISTANCE	T
EXTERNAL DISTANCE	E
POINT OF INTERSECTION	P.I.
POINT OF CURVE	P.C.
POINT OF TANGENT	P.T.
POINT ON TANGENT	P.O.T.

SCALES

TITLE	1" = 1000 FT
TYPICAL	1" = 2 FT
PLAN	1" = 80 FT
PROFILE	1" = 50 FT
VERT. CURVE	1" = 10 FT
CROSS SECTIONS	1" = 5 FT

THESE PLANS ARE SUBJECT TO SUCH REVISIONS AS MAY BE REQUIRED BY THE BUREAU OF PUBLIC ROADS OF THE COMMISSIONER OF HIGHWAYS. CONSTRUCTION IS TO BE CARRIED ON IN ACCORDANCE WITH THE PLANS AND STANDARD ROAD AND BRIDGE SPECIFICATIONS OF 1936 AS APPROVED DEC. 29, 1936 BY THE BUREAU OF PUBLIC ROADS INCLUDING ALL SUBSEQUENT APPROVED REVISIONS AND SUCH REVISED SPECIFICATIONS AND SPECIAL PROVISIONS AS ARE SUBMITTED WITH THE PLANS.

Proj#: FAP 70-E
 Pin#: 00R553
 Route#: VT18

APPROVED: June 4, 1937
 J. S. Sargent
 COMMISSIONER OF HIGHWAYS
 SUBMITTED BY ORDER OF THE STATE HIGHWAY BOARD

RECOMMENDED: [Signature]
 DISTRICT ENGINEER BUREAU OF PUBLIC ROADS
 RECOMMENDED FOR APPROVAL: [Signature]
 CHIEF ENGINEER BUREAU OF PUBLIC ROADS
 APPROVED: [Signature]
 DIRECTOR BUREAU OF PUBLIC ROADS

APPROVED: May 19, 1937
 DISTRICT HIGHWAY ENGINEER

APPROVED: June 1, 1937
 ROAD ENGINEER

SERIES F.A.P. NO. 70-E-11
 SHEET 1 OF 11

DIST. #9 Plans