

**CABLE GUARD RAIL REQUIRED**  
 Right - Sta. 6+25 to Sta. 8+25 - 200 Lin. Ft.  
 Left - Sta. 6+25 to Sta. 8+89 - 261 " "  
 TOTAL - 461 Lin. Ft.

**NEW CULVERTS REQUIRED**  
 Sta. 8+18 ±  
 18" Cor. Galv. Iron Pipe, Pavd. Invert - 52 Lin. Ft.  
 Excavation 20 Cu. Yds.  
 Concrete Class B (1:2½:5) 30 " "  
 Reinforcing Steel 33 Lbs.

**GRAVEL SURFACE REQUIRED**  
 ESTIMATED QUANTITY 200 Cu. Yds.

**RIP-RAP FOR BANK PROTECTION REQUIRED**  
 Right - Station 8+00 to 8+50  
 ESTIMATED QUANTITY 20 Cu. Yds.

7-2-D 1923 6 15

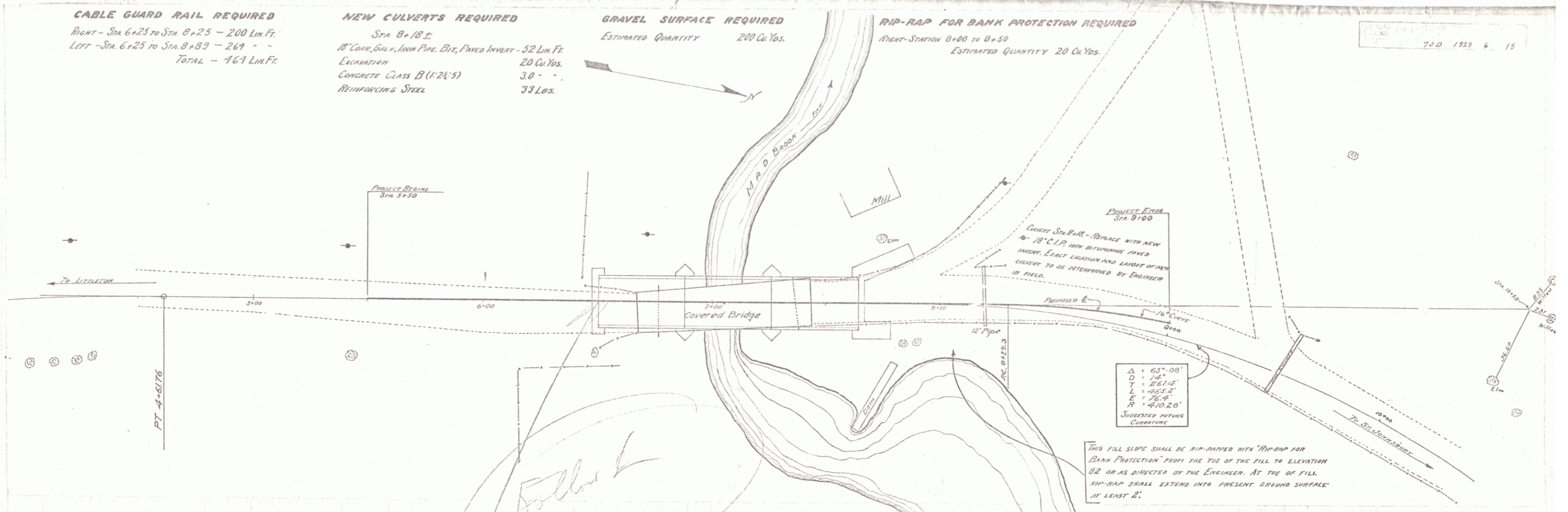

BM No. 1 - Spike in root of elm 24' right 2+58 - Elev. 93.83  
 BM No. 2 - Spike in root of elm 1' right 11+00 - Elev. 113.68

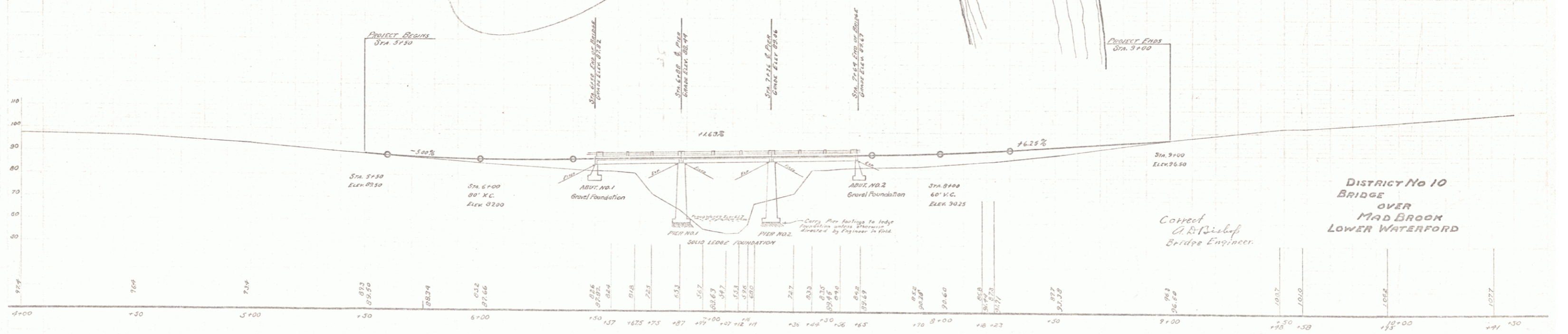

Correct  
 A. B. Bishop  
 Bridge Engineer.

**DISTRICT No 10**  
**BRIDGE**  
**OVER**  
**MAD BROOK**  
**LOWER WATERFORD**

SERIES F No 70-D  
 SHEET 5 OF 15 SHEETS