

PLAN  
 1:100  
 1/2" = 100'  
 1/4" = 50'  
 1/8" = 25'  
 1/16" = 12.5'  
 1/32" = 6.25'  
 1/64" = 3.125'

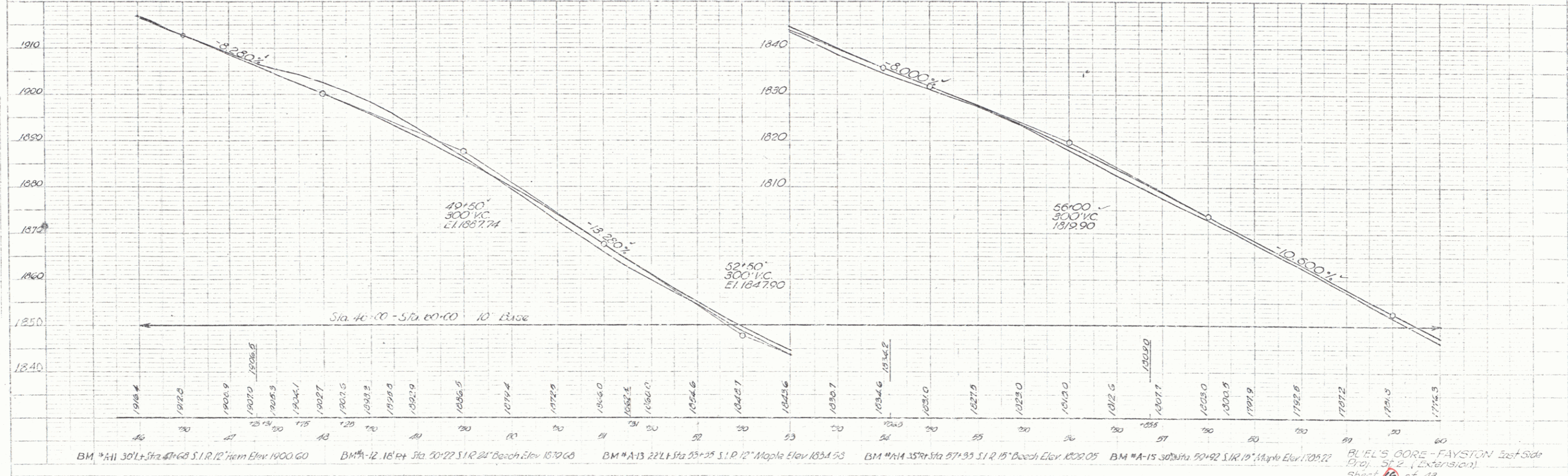
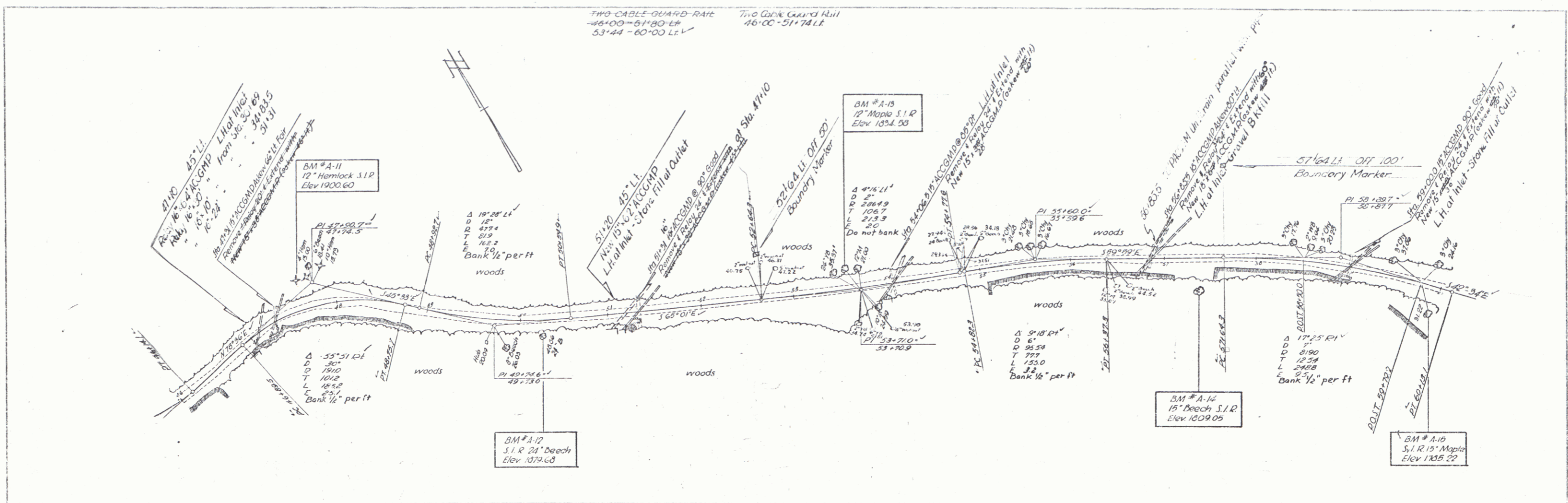

BM #A-11 30" x 1 1/2" Str. 4" x 6" S.I.R. 12" Hem Elev 1900.60  
 BM #A-12 18" x 1 1/2" Str. 2 1/2" x 4" Beech Elev 1879.68  
 BM #A-13 22" x 1 1/2" Str. 5 1/2" x 5" S.I.R. 12" Maple Elev 1834.53  
 BM #A-14 35" x 1 1/2" Str. 5 1/2" x 5" S.I.R. 15" Beech Elev 1809.05  
 BM #A-15 30" x 1 1/2" Str. 5 1/2" x 5" S.I.R. 15" Maple Elev 1805.22

BLUE'S GORE - FAYSTON East Side  
 Proj. 512 (Extension)  
 Sheet 16 of 43

AUG 18 1980 5